

Altered Apportionment 3
 PARISH OF BISHOPSCOURT
 COUNTY OF KENT

Approved by the Commission for the Parish of Bishopscourt in the year 1861
 In witness whereof the Clerk of the Parish has hereunto set his hand and seal the 10th day of June 1861
 J. H. B. Clerk

A	1
---	---

N I C K I N G T O N



Altered Apportionment **2**
 PARISH OF PATRINGTON
 COUNTY OF KENT.

Scale, 37 chains to an Inch

This is the Map or Plan referred to in the Altered Apportionment of Rent Charge in lieu of Tithes for that part of a District comprising the Parishes of Patrington and Patrington in the County of Kent, which is contained in the Statute of Patrington, dated the Eleventh day of December in the year of our said most Excellent Majesty King George the Fourth.

Michael

1 R 30 | 1 | 51 (2)

TR 30 | 1 | 51 (2)
 (2)

H O N . S A L

The New Light Station. The Commissioners for the Board of Public Works, in their report of 1871, state that the site of the station was selected by the Board of Public Works in 1868, and that the station was completed in 1871. The station is situated on the shore of the harbor, and is a fine example of modern architecture. The station is a circular building, and is surrounded by a low wall. The station is situated on a small island, and is accessible by a causeway. The station is a fine example of modern architecture, and is a fine example of the work of the Board of Public Works.

Dr. Williams
of Boston

NOTE: THIS MAP IS DRAWN FROM THE LATEST SURVEY OF THE AREA BY THE BOARD OF PUBLIC WORKS, DATED THE 1ST OF JANUARY 1871.

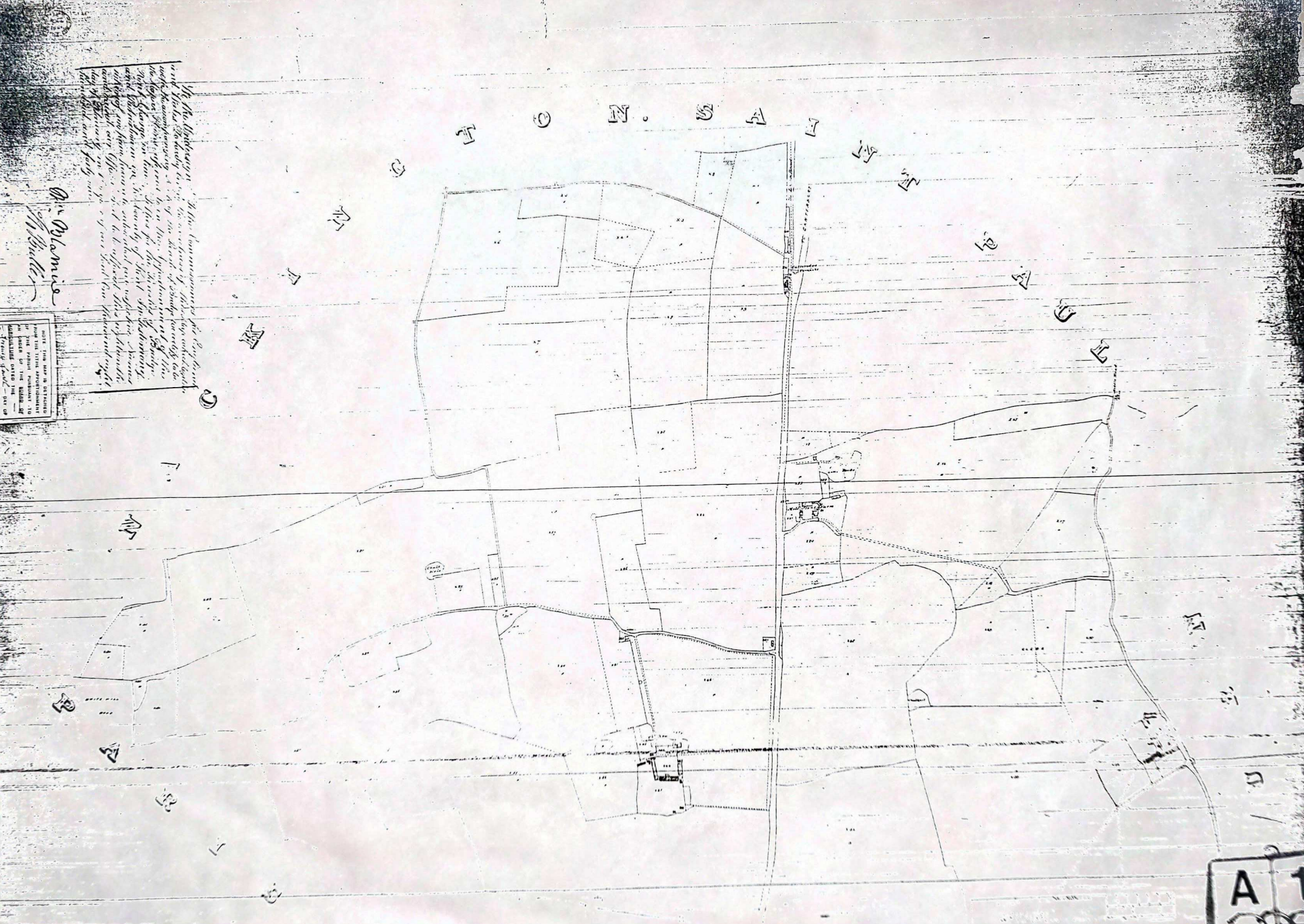

A 1

The Parish of
PATRIXBOURN
KENT.
 PREPARATION OF PLANS
 Required by the
ACT OF PARLIAMENT
 Commutation of Tithes.
ENGLAND AND WALES
 J. M. GASKY.
 CANTERBURY.
 1838.

SCALE 3 CHAINS TO AN INCH

CONTENTS.

Plan of the Parish	1142 2 27
Plan of the Rectory	1142 2 28
Plan of the Vicarage	1142 2 29

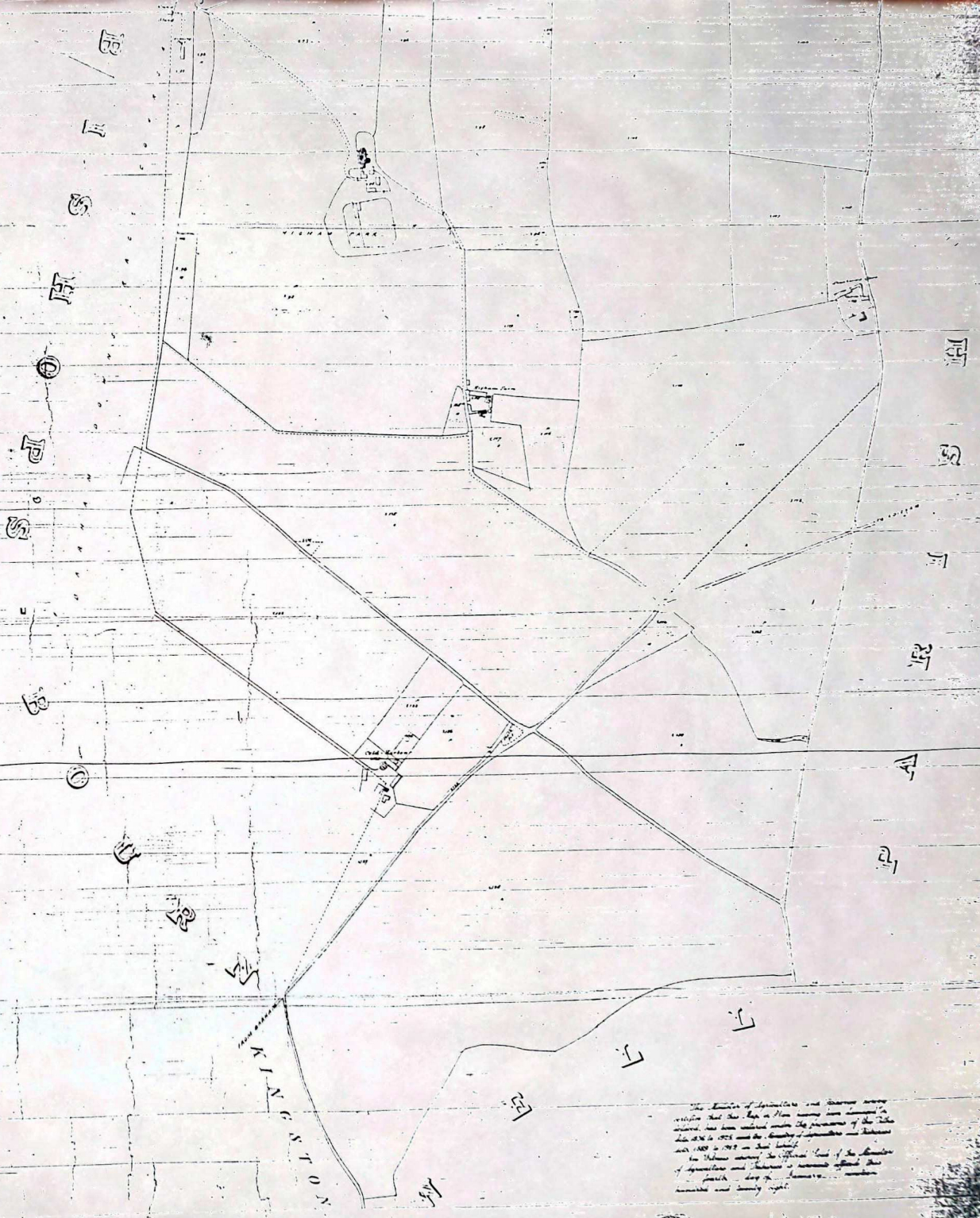

*The Statute of Agriculture and Tenures being
 entitled that the Map or Plan herein hereunto annexed
 should be taken as the true and correct representation of the
 same, and that the Statute of Commutation of Tithes
 made in the 35th year of His Majesty King George the Third
 in that behalf made, should be observed and that the
 Statute of Agriculture and Tenures is hereby confirmed and
 that the Statute of Commutation of Tithes is hereby
 confirmed and that the Statute of Agriculture and Tenures
 is hereby confirmed and that the Statute of Commutation of
 Tithes is hereby confirmed.*

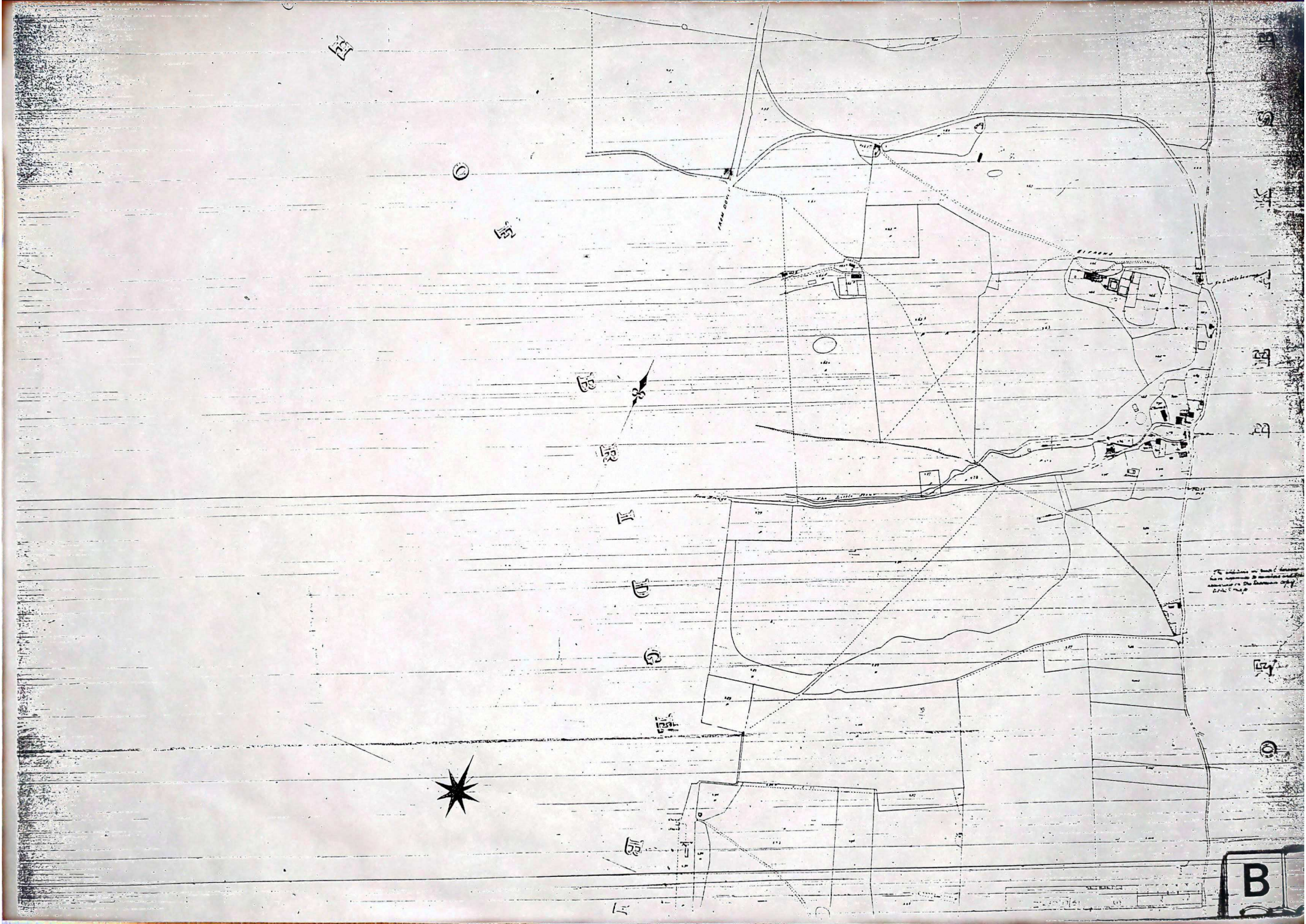

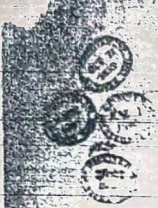

The Parish of
BRIDGE
KENT.
Prepared under the instructions of the
PREPARATION OF PLANS
 Requested by the
INTERIOR DEPARTMENT
 for the
Commutation of Tithes.
 IN
ENGLAND AND WALES
 BY
J. M. DAVEY,
 CANTERBURY.
 1858.

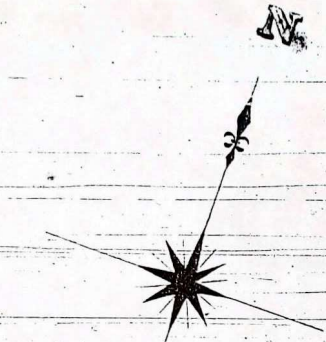

B
E
A
R
D
R
E
S

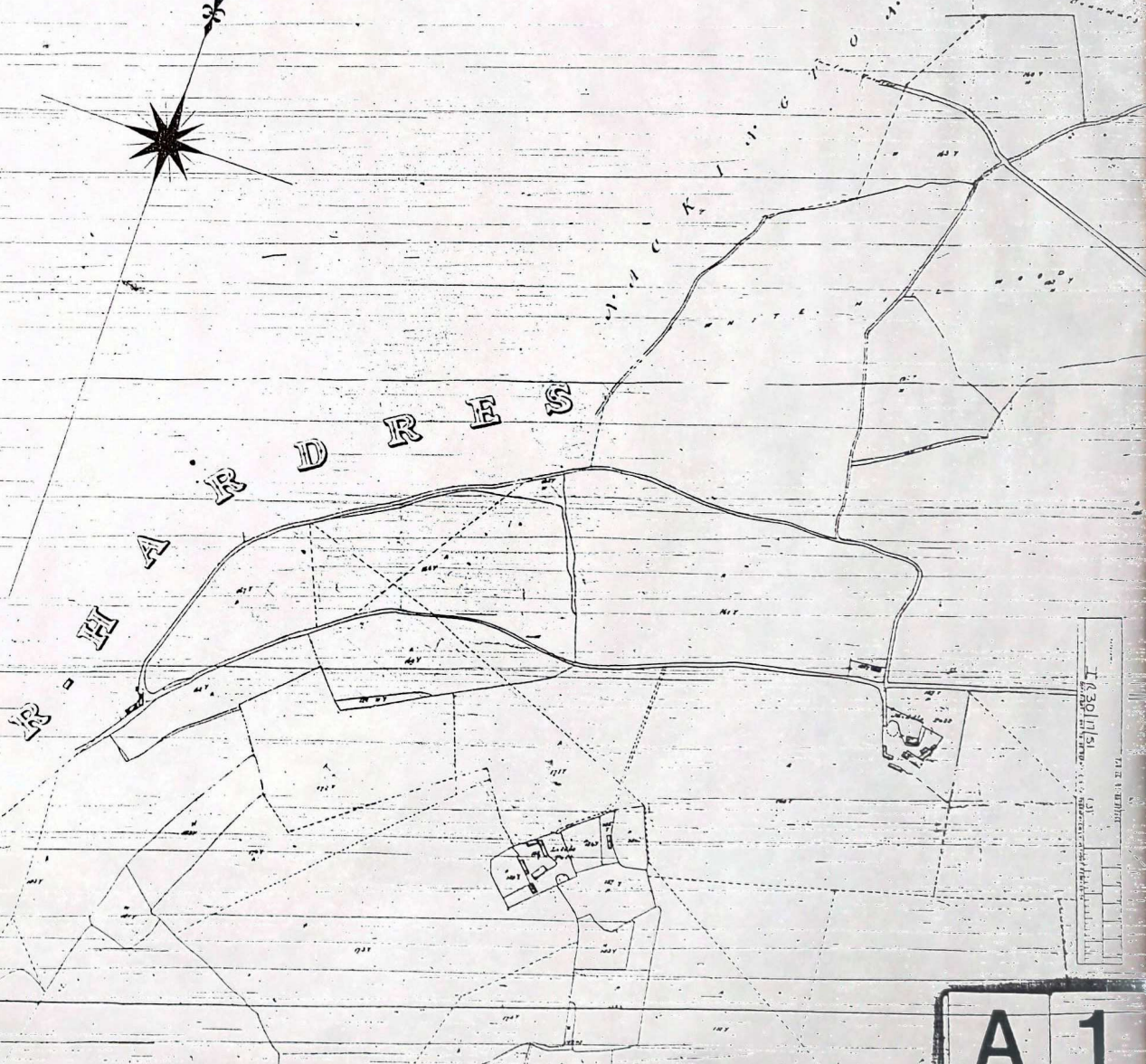

BRIDGE

1830/1/31

A 1

P A R I S H
O F
B I S H O P S B O U R N

I N T H E C O U N T Y O F

K E N T

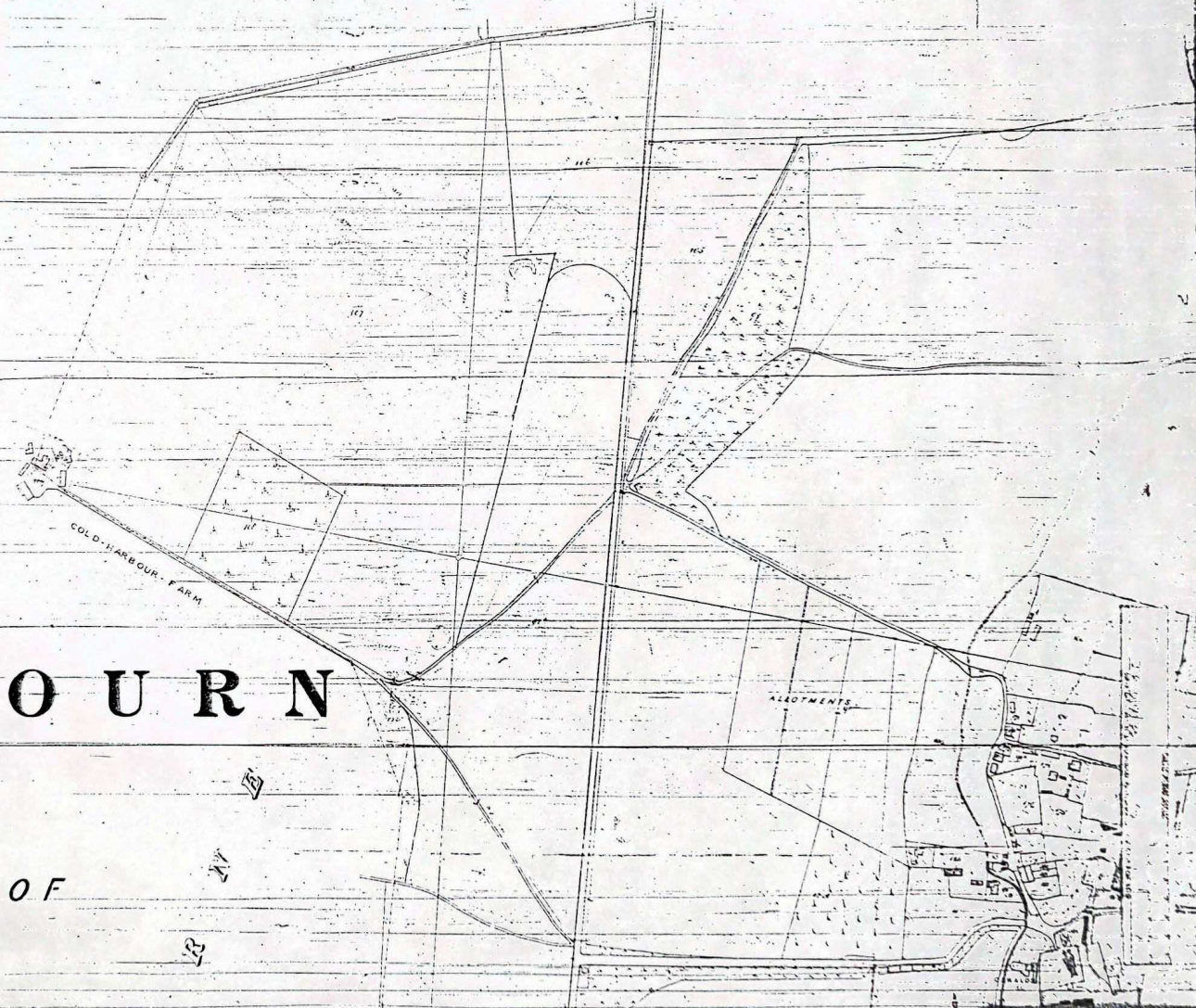

A 1

IN THE COUNTY OF

KENT

1859

Handwritten notes:
 The land was surveyed in 1859
 Pursuant to an order of the Board of
 Commissioners of the County of Kent
 made on the 12th day of August 1858
 in pursuance of the Statute in that behalf
 made.

*The undersigned, J. H. Thompson, Surveyor for Kent,
 and W. C. Smith, Esq., Clerk of the County of Kent,
 do hereby certify that the boundaries of the
 several parishes of the County of Kent, as shown
 on this map, were surveyed and ascertained
 in the year 1859, in pursuance of the Statute
 in that behalf made, and that the same are
 true and correct, and that they are
 the boundaries of the several parishes of the
 County of Kent, as shown on this map.*

*J. H. Thompson
 Surveyor for Kent
 W. C. Smith
 Clerk of the County of Kent*

NOTE.—THIS MAP IS DETACHED
 FROM THE TITHES APPOINTMENT
 OF THE PARISH PURSUANT TO
 AN ORDER OF THE BOARD OF
 COMMISSIONERS OF THE COUNTY OF
 KENT, MADE ON THE 12TH DAY OF
 AUGUST 1858, AND ANNEXED
 TO THE APPOINTMENT.

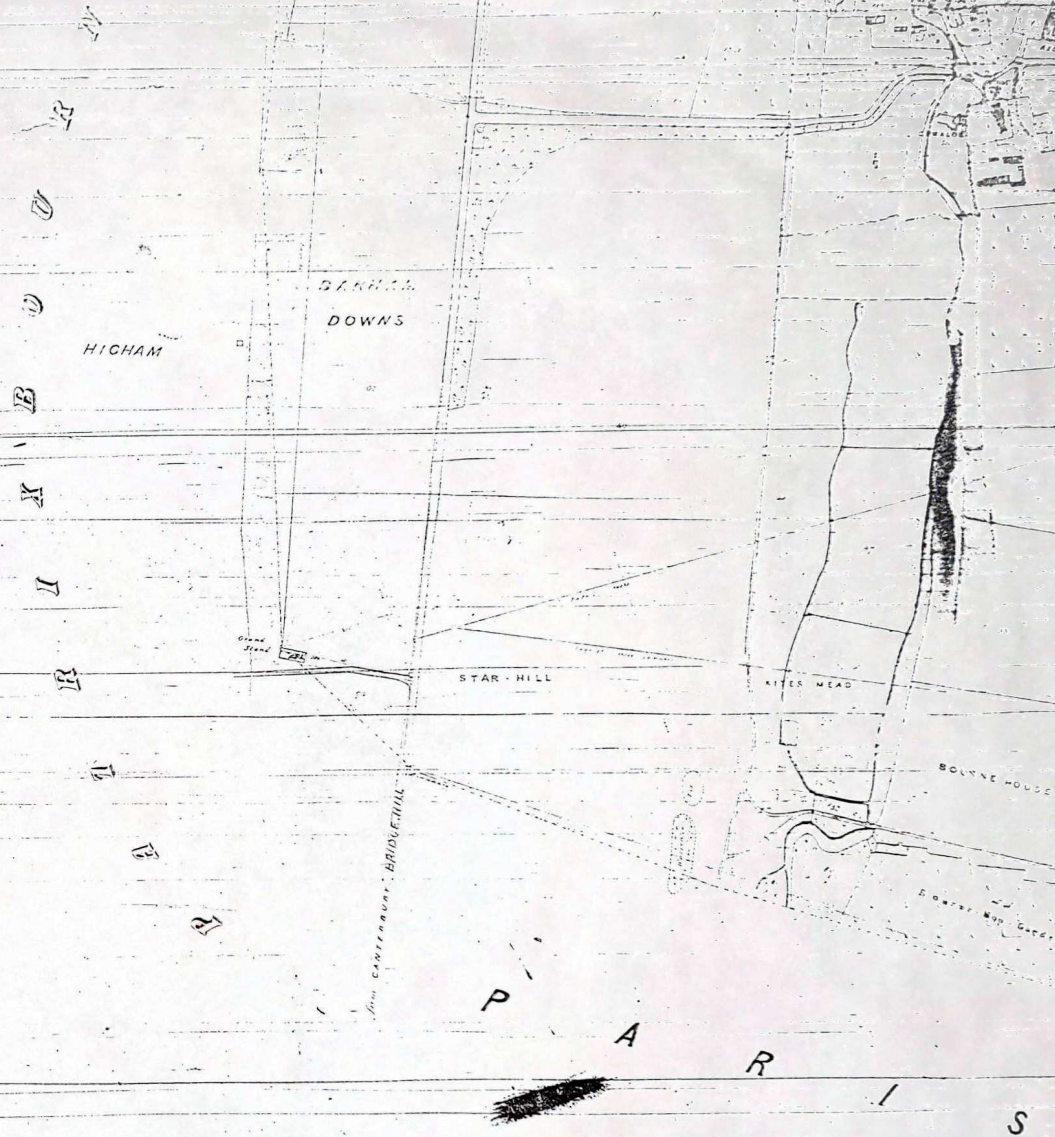

Parish	Area	Value
Brixton	1,000	100
...

B 1

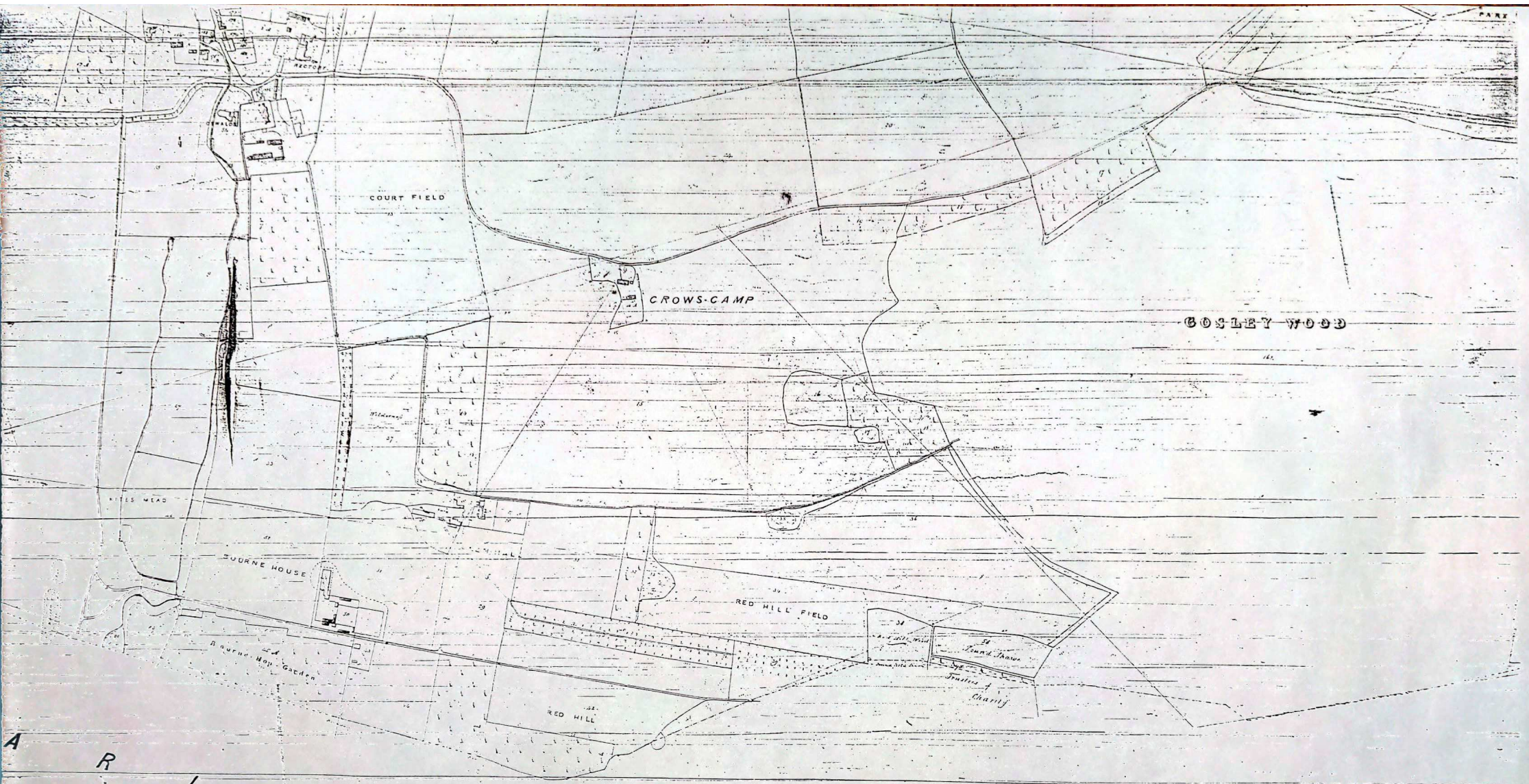

A
R
I
S
H
B
R
I
D
C
E

SR 30/11/33 (1)