

# Bursted Manor

Canterbury  
Archæological  
Trust

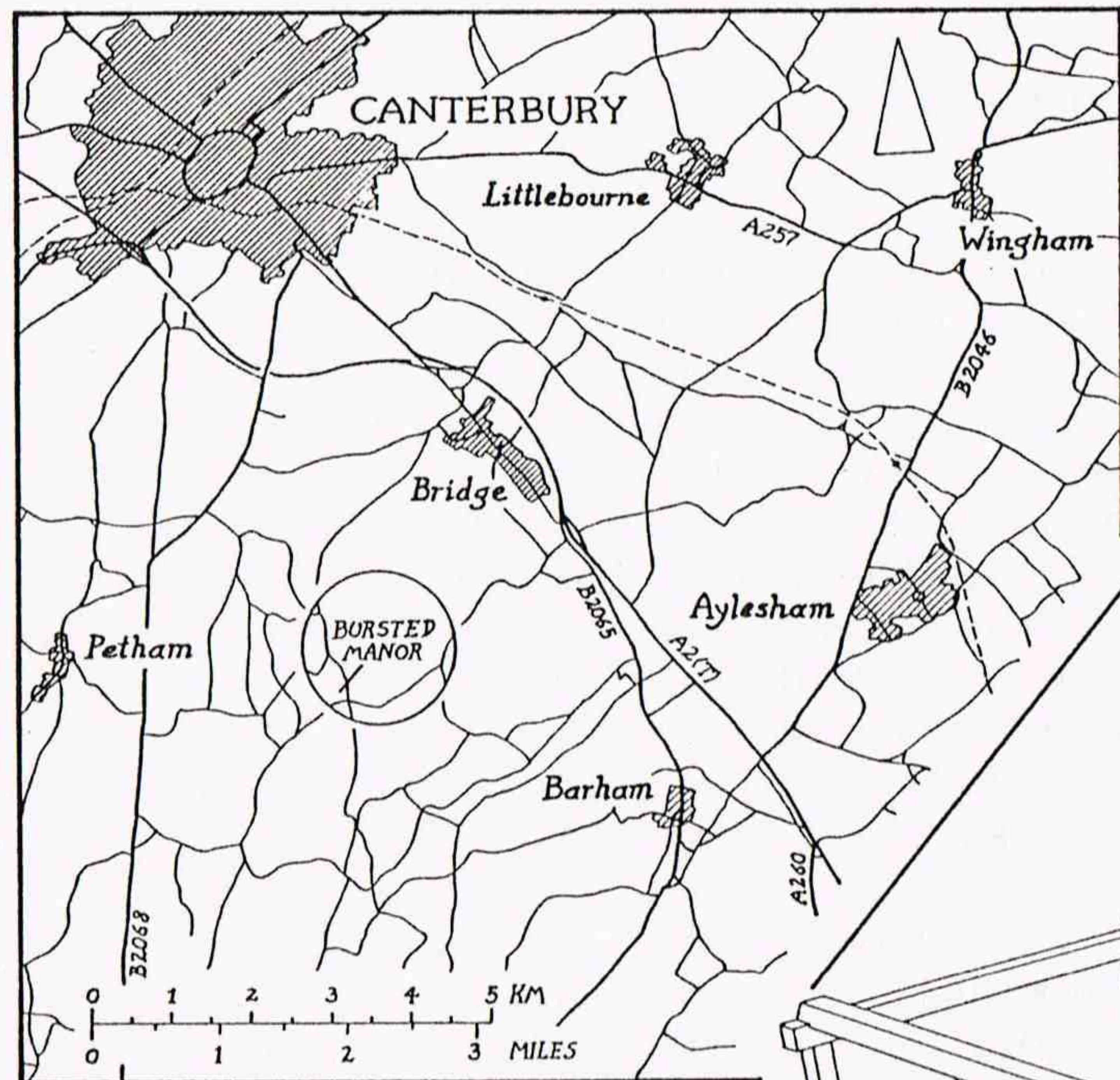

LOCATION PLAN 1:100,000

Partially restored view  
from north-west

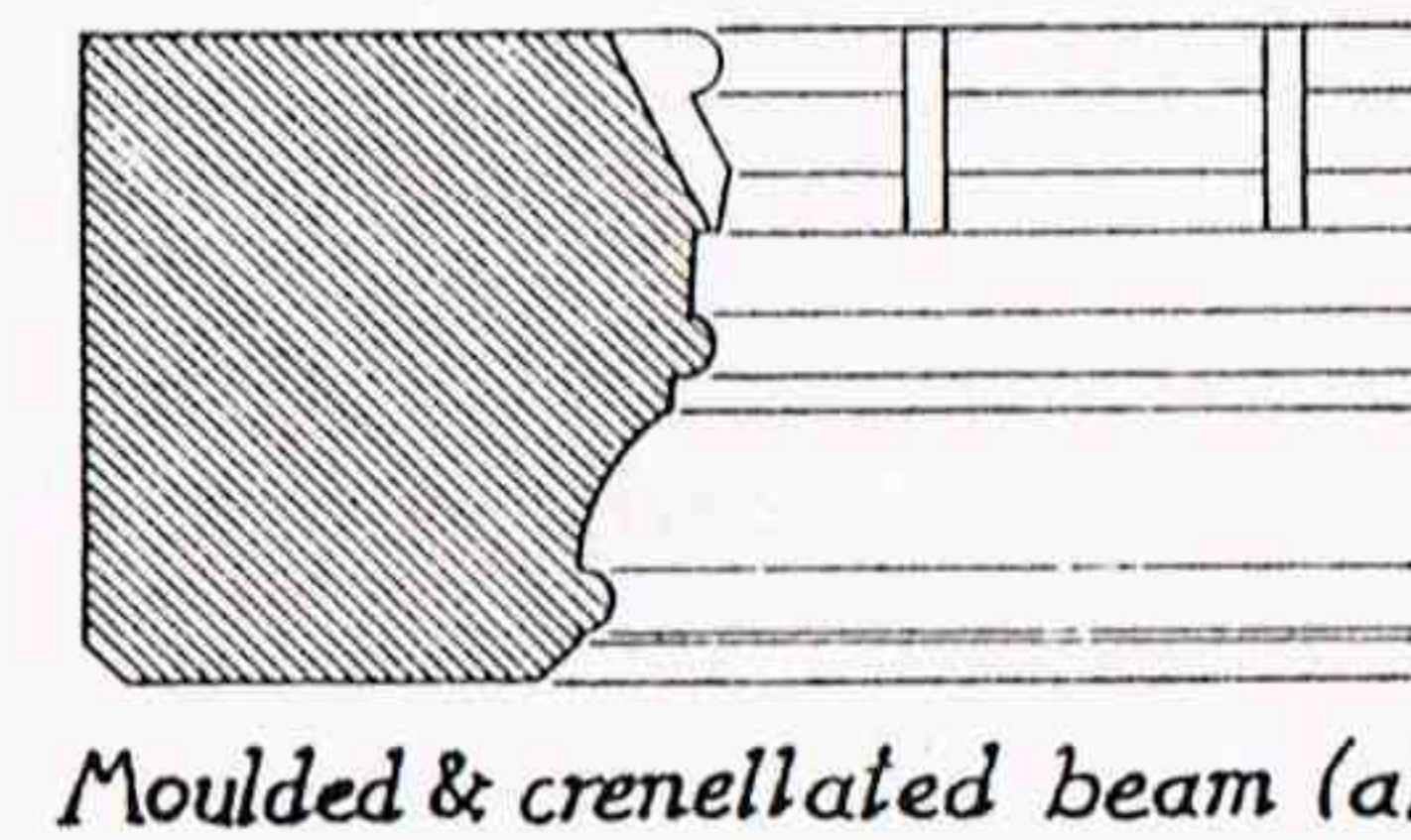
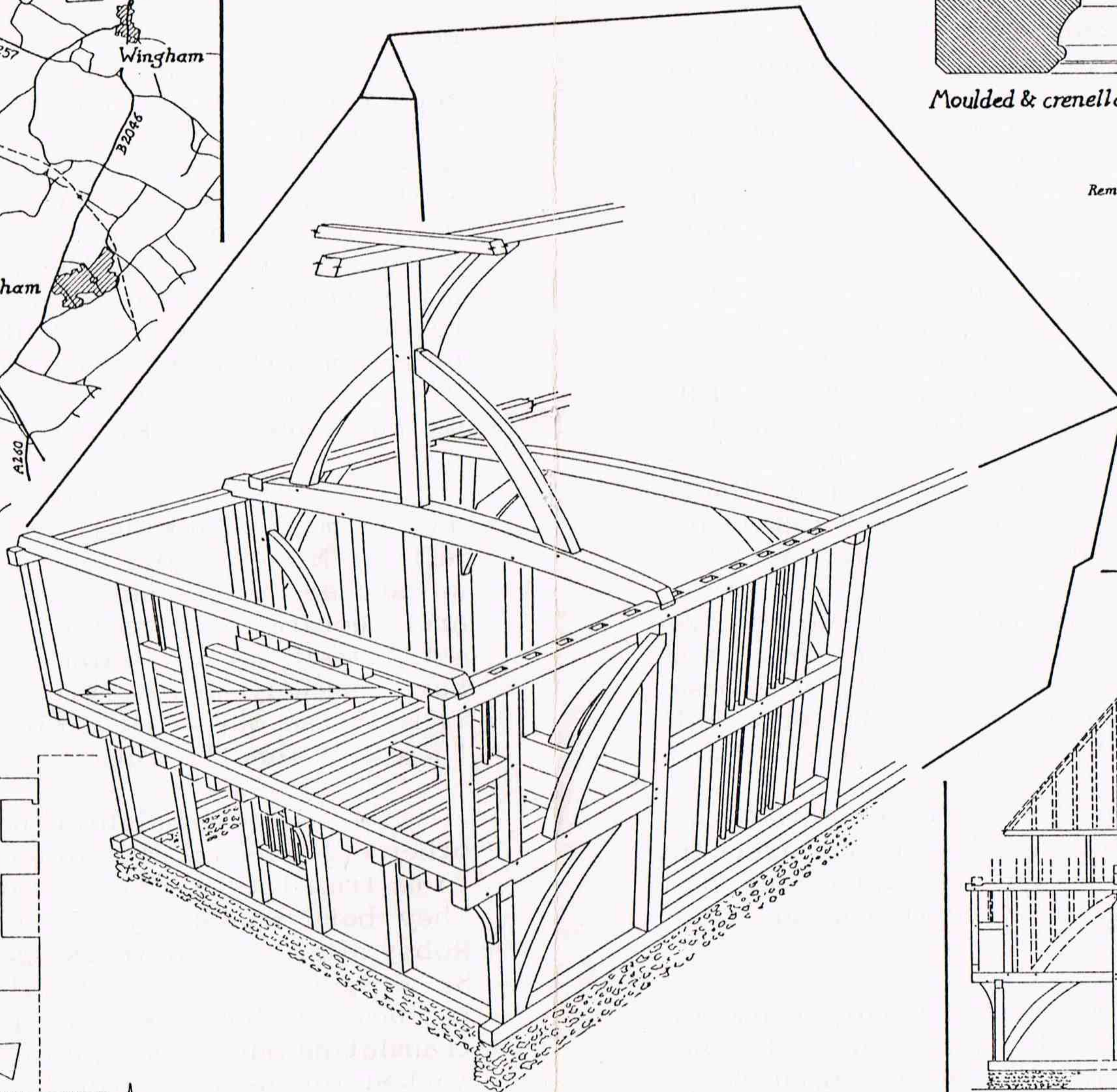

BR N<sup>o</sup> XXI 13  
Drawing 4/4  
1:100 & 1:10

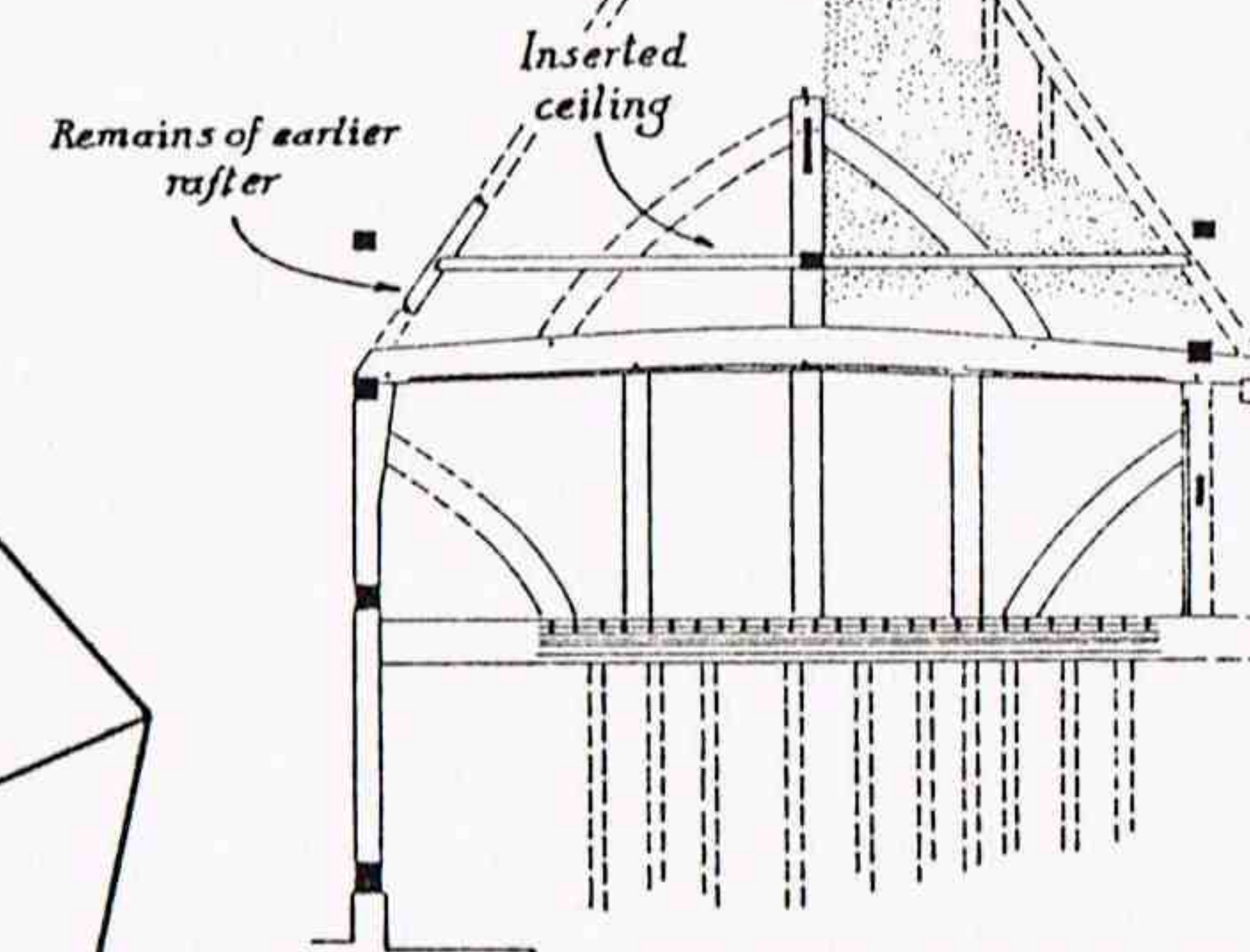

Section B-B

Later raised  
Bult Side-Purlin  
(not in line) roof

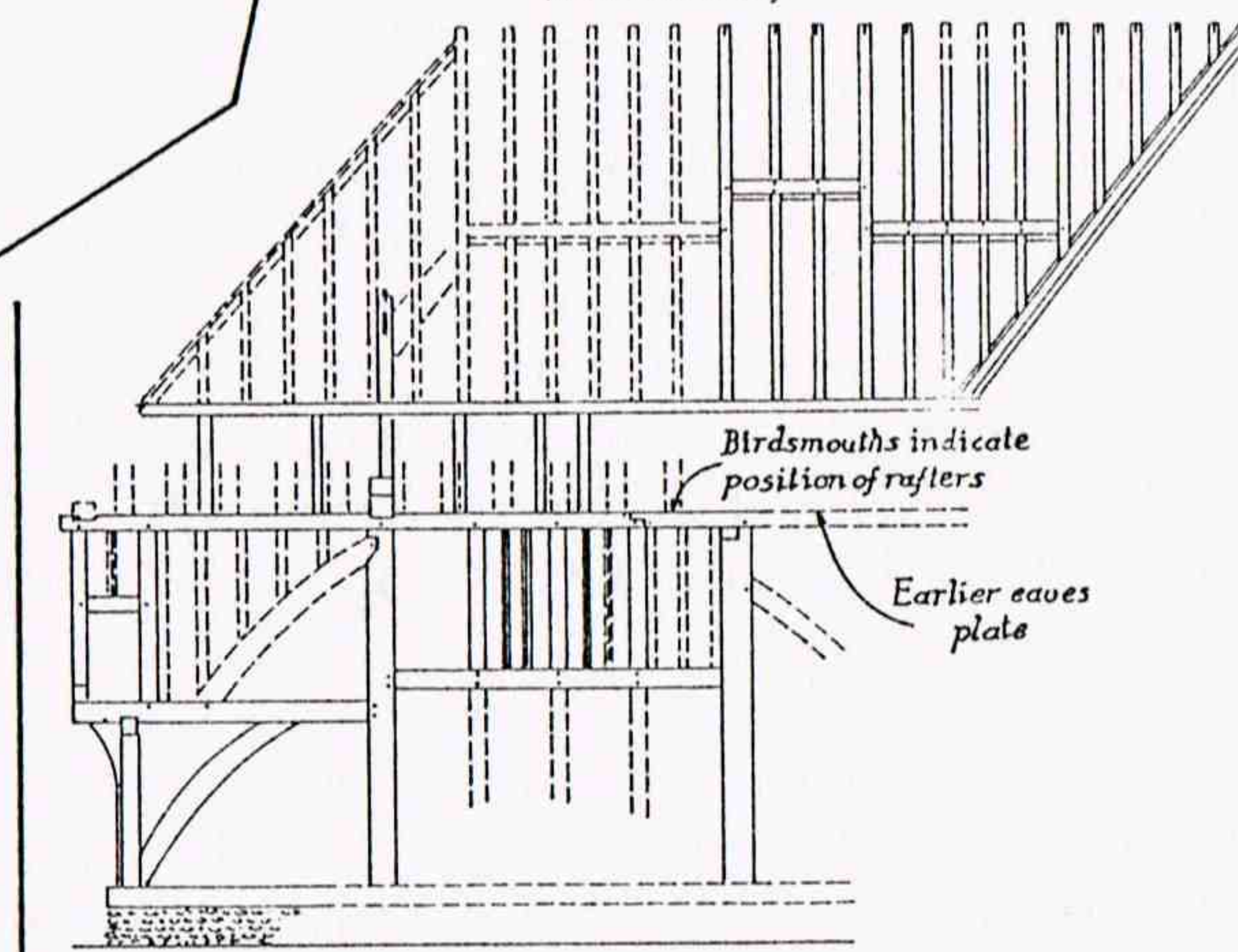

Elevation A-A

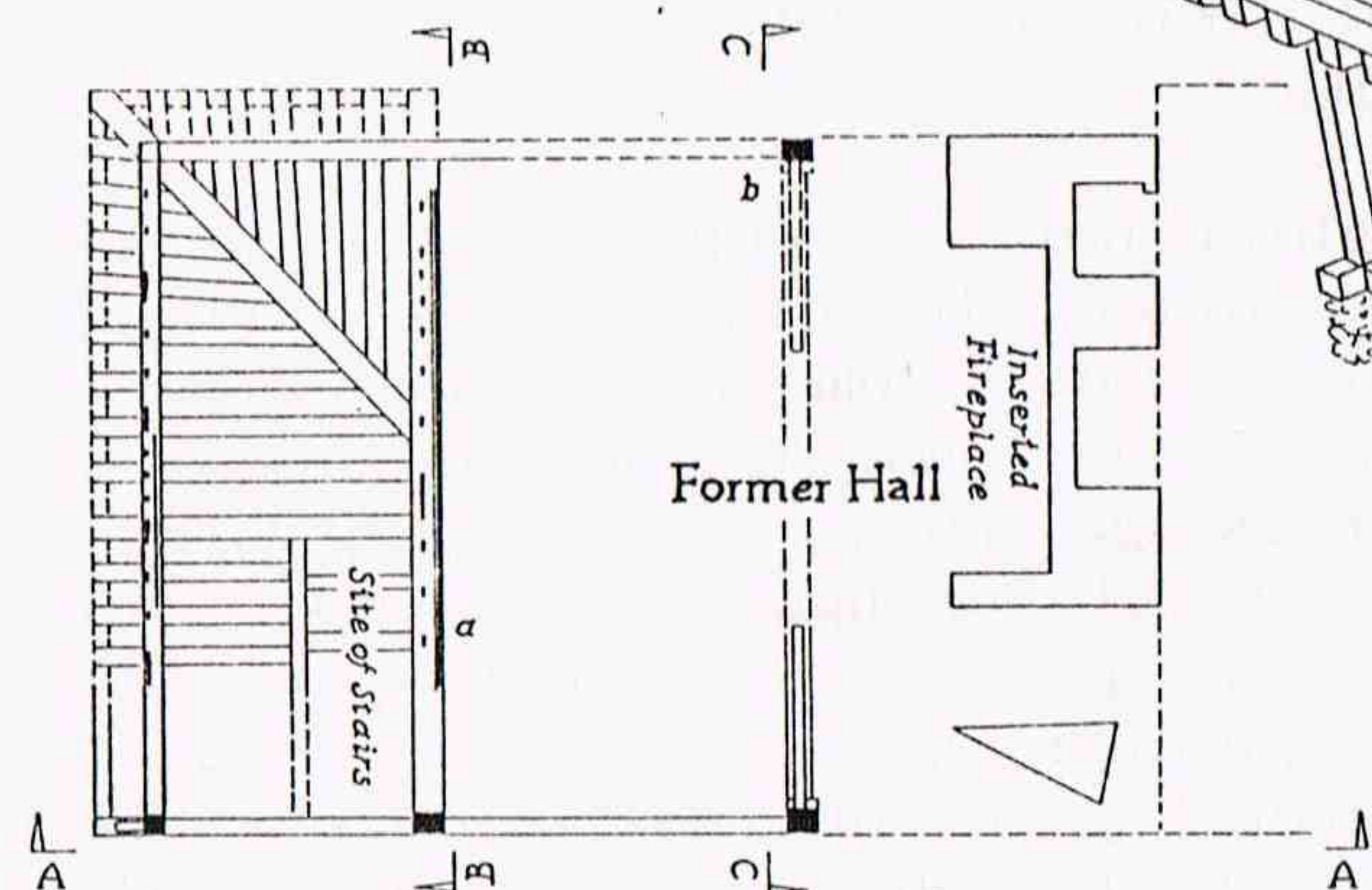

First Floor Framing

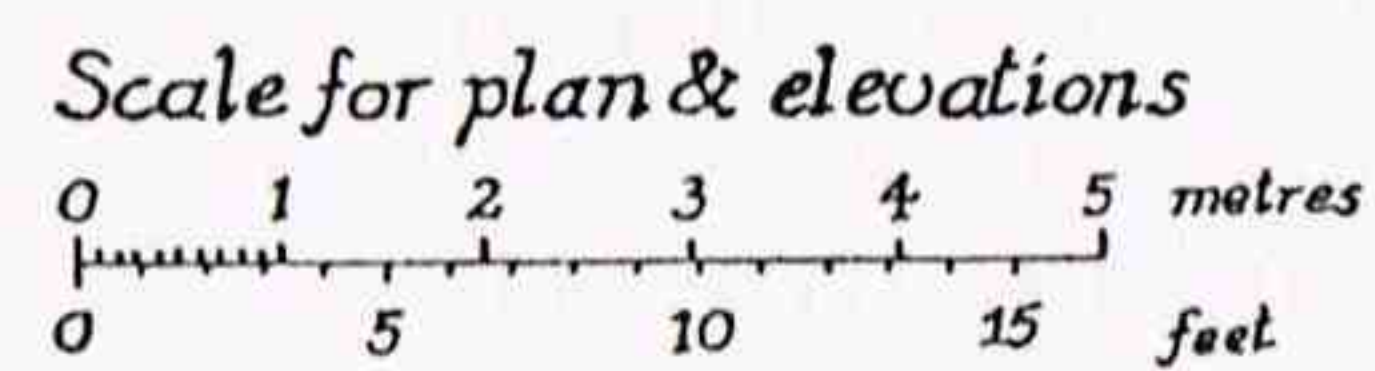
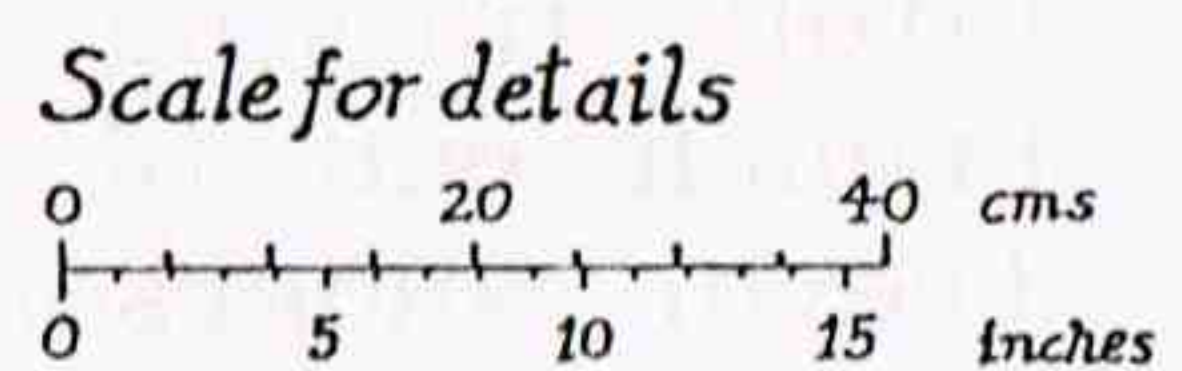

RA 88



position of palaeopathologist/osteologist, studying the many burials we are encountering on the St. Gregory's site. Trevor last worked for the Trust in 1976 on the Mint Yard site. We hope that they, together with the many new faces, will have an enjoyable, if busy, time with us.

The increase in staff numbers has put an impossible pressure on our already overcrowded hostels. I am deeply grateful to the members and officers of Canterbury City Council for allowing us continued use of council owned premises and the campsite at Bekesbourne, however, this problem is likely to increase with our staff and if any friend can offer suggestions for a short- or long-term solution, I would be overjoyed to hear from them.

Work on our office buildings proceeds apace. We have two part-time and one full-time employee refurbishing and rebuilding - John Ford, Dez Riddler and Sean Wilson, for whose excellent work I am very grateful. In early August we hope to renew the roofs of two buildings and weatherboard one complete range of the establishment, thereby not only cutting down on dust and draughts, but considerably improving the external appearance of the premises. These refurbishments are being paid for out of a generous loan from the City Council - another instance of the marvellous and invaluable help we receive from them. We have also obtained listed building grant aid to improve specific parts of the building, and both these grants should go a long way to provide us with the efficient working environment and facilities that we sorely lack.

Margaret Cowles continues to brighten the street-frontage of our offices with her display of flowers in our small garden, and to (quite rightly) reprove us for inadequate weeding and watering. We are extremely grateful to her.

A number of interesting excavation projects have been undertaken recently. At St. Martin's Hill, the Conduit House for St. Augustine's Abbey has been fully exposed by a small team under the supervision of Dennis Nebiker. This roughly octagonal structure provided water for the Abbey throughout the medieval period, for the

Saturday 7 January 1989 PAUL BENNETT: ANNUAL REVIEW of the work of the Trust, in the New Lecture Theatre of Christchurch College at 6 p.m. As 1988 is a very busy year this talk is going to be even more interesting than usual.

#### DIRECTOR'S REPORT

Dear Friend,

It is difficult to know where to start this short report of the Trust's activities since the publication of our last Newsletter - so much has happened. Changes of personnel, tangible signs of improvement within the offices, work in progress and new publications .... it is enough to make your head spin. One yardstick for measuring this increase in activity is the size of the Trust's staff. At the last count, some 64 individuals appear on the payroll, together with our excellent 35-strong M.S.C. team and a large contingent of seasonal volunteers from Canada, the U.S.A. and all over Europe. The Trust is truly a large and cosmopolitan organisation this year.

Sadly, we have lost two members of our core unit team. Paul Blockley, our former Assistant Director, has left for Milan to join his new wife and take up a post with an archaeological unit there. John Bowen, our talented architectural draughtsman and 'reconstruction' expert, has set himself up in business at Evesham, where his family have recently moved. Within the extended family of the Trust these old friends will be sorely missed and we wish them well for the future.

On a brighter note, we welcome the return of other old friends. Martin and Alison Hicks have come back to us from the British School at Rome after a long absence. They both worked on the Marlowe Arcade and Cakebread Robey sites several years ago and are now running the new St. Gregory's Priory site at Northgate. Luc Lepers, who teaches in Dunkirk, is spending his summer vacation translating many Trust publications into French. Luc has not worked for us for several years but has been invaluable lately liaising with the archaeologists working on the French end of the Channel Tunnel. Another old friend, Trevor Anderson, has recently returned to take up the