

Indenture between Alfred Neave Cullender & John Jarvis Gent.  
sale to Jarvis of piece of land (2 acres nine perches) part of

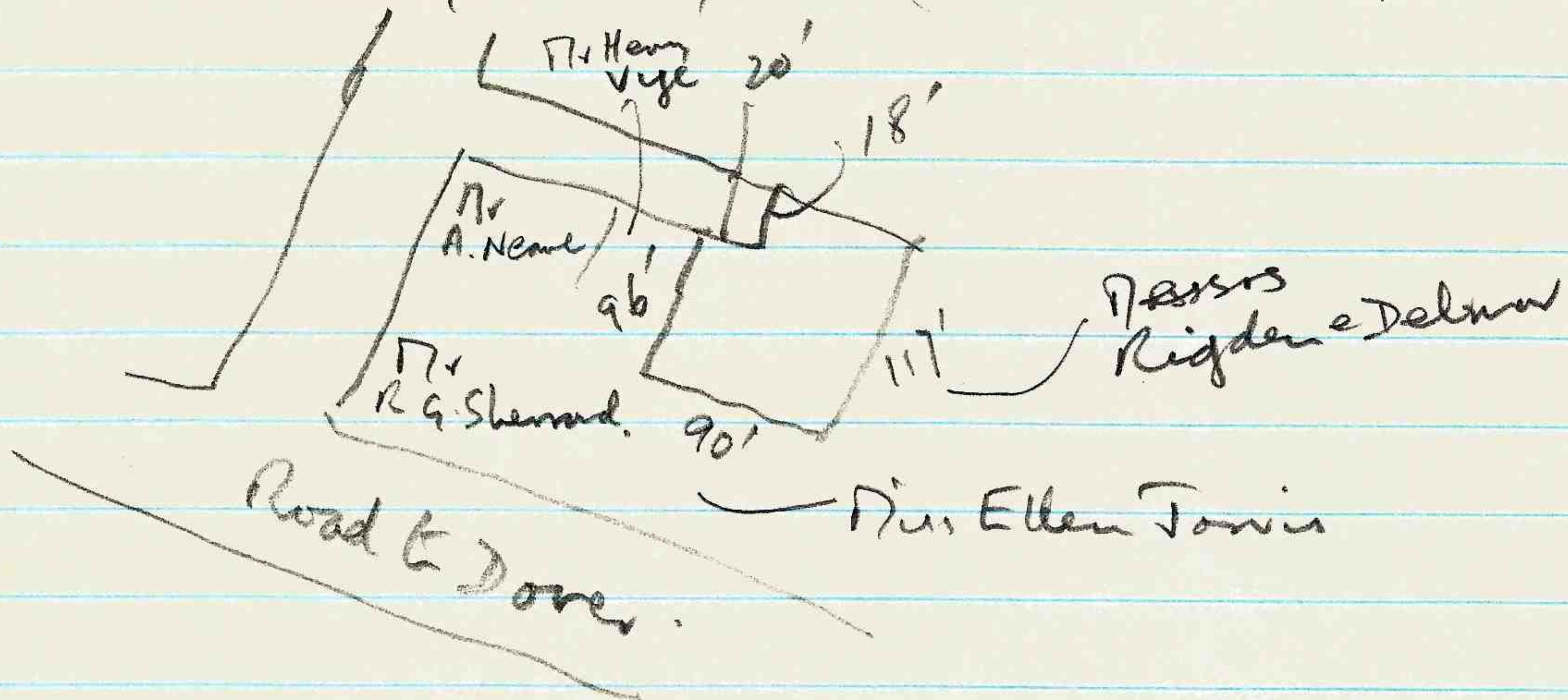

July 30 1867

1 year lease of land to Herbert Taylor (Army Lt, Spring Garden St) and Stephen Beddingham of Hawks Court. by Montagu. 8 Nov. 1805

Richard George Sherrard: Race Horse Trainer

Sells to William Foreman (builder) for £200 14 July 1869.

1 acre 2 roods 10 perches.

abutting to Bifrons Park to the NE, to land of Messrs Rigden & Delmar to SE & to other land late part of land sold by Neave & John Jarvis & H. Vye to SW & to a public footpath adjoining land late of George Ash decd. but now of Thomas Ash & George Ash sons of G Ash to NW

Agreement 21 August 1878

Susanna Johnson, Martha Francis Johnson, Ellen Eliza Johnson, Emily Johnson

Spinster and John Gilbert Johnson (bachelor) - vendors & Rt Hon.

Arthur Baron <sup>WR</sup> Nottesley & Theodore Henry Bruckman of 56 Park St Grosvenor Sq (purchasers). Sale of Corn Mill for £1000 with the gear utensils &

implements + messuage or tenement formerly erected & built by Thomas Ashenden decd.

One acre 2 roods 3 perches, formerly in tenure or occupation of Thomas Johnson now in tenure or occupation of George Fryer as tenant. To include:-

Indenture of conveyance to James Ashenden dated 20/1/1830



1920 Jan 1830

Ed. Skelnesdale & Sir H Taylor, Ed Talbot late of Bepone  
& James Ashenden former & W. Sanley of Bridge, surgeon,  
sold to JA for £200

All that piece of land called or known by the name of  
the Three Corner Meadow containing 2A 2r = 7p

formerly in tenure of Henry Crosser afterwards of  
Charles Howard late of said James Ashenden & then of  
Joseph Gardner & William Fagg the younger or their undertenants

Abutting to a Bridle way leading from the Village of Bridge  
to a place called Linsey Bottom towards North to the  
highway or Road leading from the village of Bridge to a place called  
Street End towards West or SW & to lands formerly of the heirs of  
Dr. Forde & then belonging to the Rev. Bosham towards SE which  
said piece was heretofore used with a formal part of a farm called

Hollypates Pett Farm late in occupation of Richard Games dec'd  
& was heretofore desc'd. as all that ... in occupation of Henry  
Crosser.

And also all that corn windmill & other the buildings there  
 lately erected & built on said -- land & they and at the  
sole costs & expense of said James Ashenden.

21 Jan 1830 James A for term of £400 paid by Ann Sarah Game.  
He gives them the use of the mill & land for 500 yrs.  
also 10/- paid to William Sanley.

Ann Game + 8/3/1831

J Ashenden sold land to Charles Edward Howard (a vet).

Thomas Sladden paid Sarah Game £400

5/1/1849 Thos Sladden → Alfred <sup>Draper's Ass't</sup> Ashenden / William A / Hy A /  
Richard A / Mary A → Thomas Johnson Dilled / Benj Johnson  
Dilled

J Ashenden + 14/9/1832

→ over



2/3/1833 Sarah Gower → T Sladden  
T Sladden sold to T. Johnson for £650

10/2/1849 Chas Johnson & Charles Hudson - Concluded  
Loan of £50. (mortgage)

11/Sept 1851 Will of T Johnson  
bequeaths to Francis John Henderson & Henry Crow  
on Trust for wife Ann Johnson.

11/7/1856 Will proved

10/4/1857 Ann J died

21/4/1862 Will of B. Johnson of Boston Mill

~~11/3/1865~~ George Fryer his executor

11/3/1865 B Johnson died

9/11/1867. George Adams lent Mary Ann Johnson (B's  
widow) £500

23/12/1874 G. Adams & G. Fryer for £500

15/3/1875 Mary Ann J died.

29/July 1876 etc etc.

1881 Census 3 Boston Mill Lane.

Susanna Johnson 35 b 1846

John G. Johnson 27 b 1854 - Miller employing 4 men.

b 1831 Th H Brinckman. Baronet 40 Berkeley Sq. Age 50  
11 servants!

1825 Arthur Wootley Baron Wootley Hall  
Lord of Staffordshire 21 servants!



Conveyance called the Church Meadow 1 Sept 1847

Henry Jarvis Bridge Butcher & John Jarvis of Conduit St Bond St.  
AND Edward Sankey SANKEY surgeon Conterbury  
(Transfer to H. Jarvis) Acres

Abutting the churchyard, (in tenure of Richard Brice)  
and to land belonging to Richard Jarvis to NE & to Road from Bridge to House  
on SE, to land vested in Ed Shelmerdale & Sir Robert Taylor as Trustees  
for Ed. Taylor & Herbert Ed Taylor but now belonging to Nathaniel Congyham  
to SW & partly to road leading from Bridge to Street to NE & NW

Indenture 9 November 1805 between

Edward Taylor of Bifrons, Herbert Taylor of Spring Garden Lt Col.,  
Stephen Beckington of Blinthen Court AND Charles de Secoudat  
Baron de Montesquieu of Bridge Hill House.

31 Aug 1802 between Taylor & Revd John Charles Beckington of Bone Park  
& Louisa Beckington (Ed Taylor married Louisa Beckington)

13 July 1869 Indenture between Alfred Neame Soap & Candle  
Manufactures & R G Sherrard of Race Horse Trained (married since  
1834). Sale by Neame to Sherrard for £250 1 acre 2 rods 10  
perches

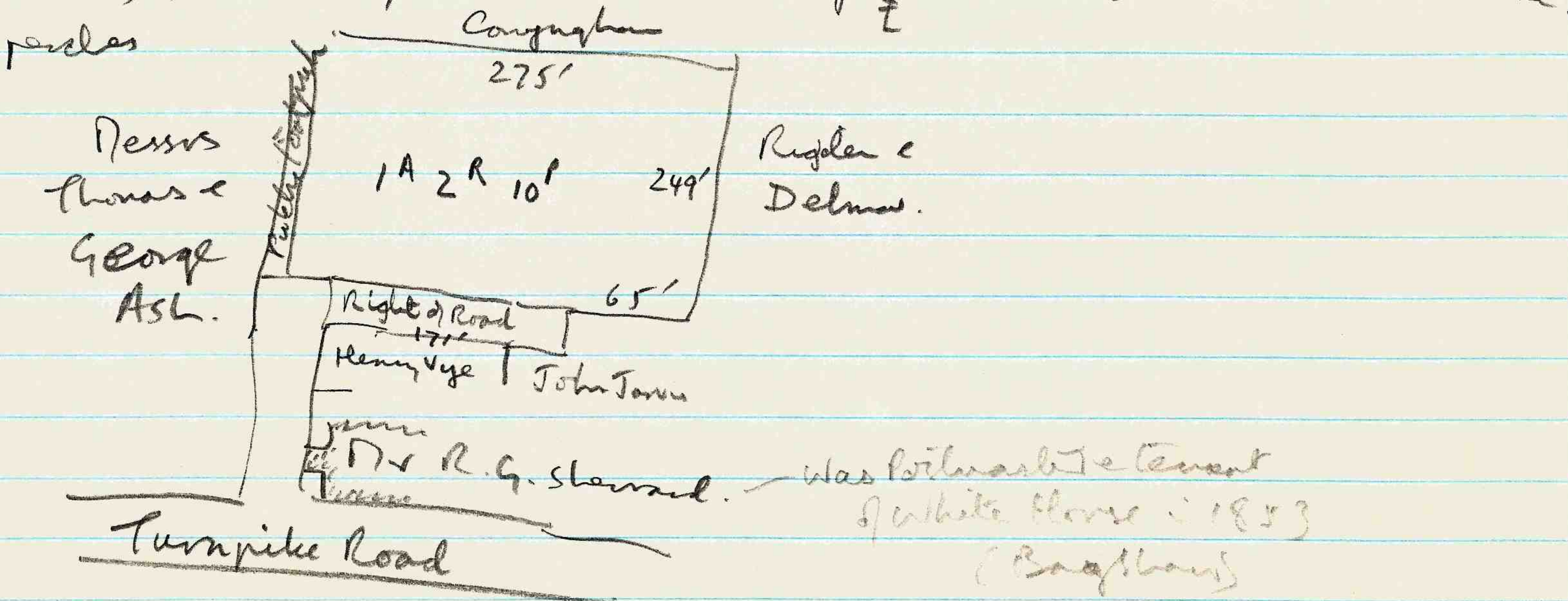



5 April 1867

Indenture between Alfred Neave & Richard George

Sherrard (married since the year 1834)

£500 paid to Neave for his bit.

adutting St. to S or SW 43' 3" to ground intended to be used as Road  
when dividing the heredit, Geo Ash W or NW 116' to other  
land of Alfred Neave N or NE 60' & Hy Vye E or SE

6 April 1867. Sherrard sold to Henry Larkin (Mortgage  
at 5%.

4 April 1868 Will of Henry Larkin Died 12/3/1871

wife Grace Larkin, Nephew James Solby (Quaver Farm)

~~5 April 1872~~ → Solby renounces claim

5 Oct 1874 Grace Larkin (Whitstable Road) sells mortgage  
to Wm Foreman, coach builder, Costesbury

5 Dec 1874 Foreman sells for £750 to Jarvis Beving  
all that build by H. Jarvis etc etc.

The land occupied by Sherrard the seat to Fairbairns &  
Jarvis Beving adutting to Beifrons Park belonging to Margum Conyngham  
towards NE to land late of Messrs Rigden & Delmar & then of Wm  
Edw. Rigden & J Rigden towards SE partly is land late of  
J Jarvis & then of J Beving & partly to land of Hy Vye towards SW  
and to a public footpath adjoining land late of Thos Ash &  
Geo Ash & then of Thomas Ash & used with the White Horse  
Inn there towards the NW

---



Indenture

(3)

U438

T27

(a)

10 Oct 1874 John Jarvis late of Bridge, now Dover, bachelor  
& Jarvis Bing of Newnham & Wickham Newnham, married since 1834  
sale to JB for 110 (same piece).

Gentleman

Bridge/Stone Harlow

or Woods.

Bounds Hill & Hoods or Hodes Close otherwise Broomfield  
(R.H. Borham)

20/7/1840. 16 pp.

Abstract of Title.

Richard Jarvis of Bridge, Butcher will <sup>dated</sup> 18 July 1814. property devised  
to nephews Richard & Henry Jarvis.

RJ died Feb 1822

2 dwellings occupied by Thomas Irons & Elias Wilson & Samuel Soles  
Land 2<sup>a</sup> OR 27<sup>a</sup> occupied by Mr Ucclee?

(relates to land bounded by Bridge Street to S George Ash land to W  
Lady Conyngham to North & Ridgen & Delmor + thos Whick?  
to East.

Conveyance by Edward Taylor to Richard Jarvis 23/24 Oct 1801,

6 Sept 1858 Will of Henry Jarvis bequeaths all to Mary his wife  
then equally to his 6 children Ellen / Henry / Mary Ann / John William /  
Richard & Elizabeth. Share & share alike

'Provided always I hereby declare & direct that in case my said son  
Henry who is now & has been for a considerable time out of England & has  
not been ~~heard~~ heard of by me or any member of my family for  
sometime past shall be now dead or shall not return to England  
& be seen by my said wife or one of my said 6 children within 2  
years from the day of my decease he shall take no benefit or interest under  
this my will but in that case I revoke the ~~provision~~ devise & bequest to him  
of 1/6th part of my real & personal estate --- (equival to 5 children  
instead. Executors wife and Ellen.

Henry Jarvis. died 15 April 1859

→



Jarvis

→ cont. 2 October 1860

Charles Walter Smith, of Dalpas & Cheshire, Draper married  
Mary Ann Jarvis, ~~the~~ of said Hy Jarvis the <sup>described</sup> ~~desc.~~ as of  
Castlemaine & Australia Draper.

Not intended <sup>by parties</sup> to take advantage <sup>of will</sup> --- Hy Jarvis might  
in consequence be induced not to return to England within two  
years from the day of decease of his father

& ~~in~~ cos of love & affection Mary Ann had for her brother she  
agreed with Chas Smith that if they married the will should be  
considered void. (they would claim Henry's share)

Mary A had 1/250 consolidated stock in East India Railway Company  
(annuities) she gives her share to Wm Richard Jarvis & Francis John  
Henderson (of the Bank, England)

Mary Jarvis married Chas Walter Smith 4 October 1860.

31/12/1860 Agreement between Hy Vye of Ransgate, Commercial  
Traveller, Eliz. Jarvis of Bridge & Hy Jarvis the son.

--- recited that previously to the expiration of the sd 2 years the  
sd mother & brothers executors of the sd Hy Jarvis corresponded with  
him upon the subject of his return to England & the sd proviso & it  
was then agreed by them not to take advantage of the proviso with  
respect to him --- he was in consequence induced not to return to  
England within 2 yrs from the day of the decease of id father

Now therefore in consideration of the --- love & affection of Eliz J had for Hy J  
they also revoked their share.

31/12/1861 settlement between Eliz Jarvis <sup>intended marriage</sup> & Henry Vye & Chas Head,  
Cattle salesman of Fordwich (executed, presumably).

Eliz Jarvis has stock in 3<sup>rd</sup> Consols.

2/1/1862 Eliz Jarvis married Henry Vye of Bridge

17/10/1865 Mary, widow of Henry (father) died & was buried at Bridge

19/10/1866 Account of the succession of Eliz Vye

Mary Ann Smith / Ellen Jarvis / Hy Jarvis jun / Tho Jarvis / Wm Richard Jarvis / 1/6 each.

10/10/1866 - agreement between all these & Alfred Neave to sell 'all'  
property for 1900 in manner following, →



Jarvis,

ditto to say £150 ( $\frac{1}{2}$  part thereof) to Ellen Jarvis, Hy Jarvis<sup>2</sup>  
 Wm R Jarvis, F J Henderson, Jno Jarvis Wm R Jno & Chas Neal  
 $\underbrace{\hspace{10em}}_3$   $\underbrace{\hspace{10em}}_4$   $\underbrace{\hspace{10em}}_5$   $\underbrace{\hspace{10em}}_6$

+ 10s by A Neave to Char Smith, Hy Vige

Neave gets 2<sup>a</sup> 2<sup>r</sup> 30<sup>a</sup> (now 2.0.27 → 2.0.9)

land against Bridge Street to S or SW, to land of Geo Ash to W or NW  
 to land of Lady Conyngham & then of the Marquis of Conyngham then towards N or  
 NE to land of James Ridger & Delmon & ptly those of Thos Whick  
 Declaration by sd A Neave that he had married since 1 Jan 1834

19/1/1830 Indenture between Edward Lord Shelburne & Sir Herbert Taylor  
 (Lt General) - Henry Jarvis, Butcher. for 5/- a piece they sell  
 Church Meadow to him. 7 acres 28 perches + peppercom rent.  
 Abutting the churchyard & property belonging to Henry Jarvis & Richard J his brother  
 to NE, to the road leading from Village to Bourne to SE - - -

20/1/1830 Conveyance.

28/8/1860 Elizabeth Dowager Marchioness to Ecclesiastical Commissioners  
 - additional land as burial ground.

20 perches, being part of a close or field there called Church meadow  
 bounded on NE by the churchyard, on the SE by the public road leading  
 from Bridge to Bishopstone & on the North West & SW by the residue of the  
 said field called Church Meadow

21/8/1878 Miss Susanna Johnson & others and Rt Hon Lord Wrottesley  
 Agreement for sale & purchase of Corn Windmill <sup>& another</sup>

1a 2r 3p erected & built by Thomas Ashenden dec'd. formerly  
 in tenure of Thomas Johnson, now in occupancy of George Fryer

Indenture of conveyance to James Ashenden 20 January 1830. No earlier  
 title required.