

Nailbourne Horticultural Society

There is no meeting arranged for November, but to round off our programme for this year, there will be a **Social Evening on Tuesday 5 December** in Bridge Village Hall, arrangements for which are still being finalised. So, make a note of the date and watch out for details in the next Parish Magazine, on posters displayed around the village and the local Press.

Bridge with Patricbourne Women's Institute

Our **Annual Meeting** when reports, including a resume of the year's activities, are given and when officers and the committee are elected for the coming year will be held on **Tuesday 21 November** at 7.30 pm in Bridge Village Hall. After the business part of the evening, we shall have a social time when members will have the chance to catch up and chat with friends. The competition for the month is for an interesting black coloured item.

Barham & District Horticultural Society



**An illustrated talk by
Dusty Miller
'Growing Vegetables
from Scratch'**

**Wednesday 8th
November at 7.30pm
Barham Village Hall**

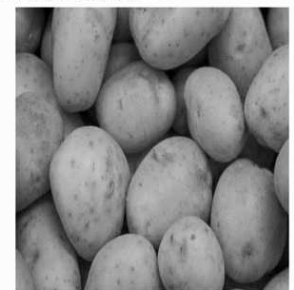

All members free - non-members £2.00 at the door.

Art in Bridge

Report 17th Annual Open Exhibition October 2017

This was another successful exhibition with over 150 exhibits. Exhibits covering paintings, photographs, sculptures and craftwork from people of all ages living or working in a rural parish within a five mile radius of Bridge were shown. Bridge and Patricbourne Church of England Primary School contributed two hanging banners. The exhibition favourite was *Owl and Pussycat* by Elizabeth Stewart. The results can be seen on the web site (www.artinbridge.org.uk).

Refreshments were available and visitors were encouraged to sit and talk. There was a presentation by Sue Pratt, the Young Arts representative of The Arts Society Canterbury Evening, one of this year's sponsors, of gift tokens, generously donated by Cowling and Wilcox, Canterbury awarded in a non-competitive draw to two artists, one junior under eleven years of age and one senior up to the age of eighteen years. The junior prize was awarded to Phoebe Hodges who submitted three pieces of art work. The senior prize was awarded to Amelia Johnson who submitted two pieces of art work. Grateful thanks are also due to our other exhibition sponsors The Bourne Gallery, Picture Framing Service at Chalkpit Farm and Colebrook Sturrock & Co. As always the successful weekend was due to the many talented exhibitors and loyal helpers.

Sue Hodges

Not everyone enjoys Christmas

Samaritans are here for our callers every day of the year but we do know that there are some times more difficult than others. Christmas can be a particularly hard and stressful period for many people.

On their own, having lost contact with their family or perhaps missing close friends or relations who have passed away. While most families are getting together to enjoy this time of year they can feel very isolated and depressed.

Whatever the reason, Samaritans offer a safe place to talk; at any time you like, in your own way, about whatever's getting to you.

You needn't feel alone, we are here to talk through whatever is troubling you, 24/7.

Please contact us on our free to call phone line 116 123 or email us at

jo@samaritans.org Canterbury & District Samaritans

Registered Charity no 1166874

Editor's Note Will all contributors please note that the next edition will be the combined December 2017/January 2018 one. Please may I have all items for this by teatime on Wednesday 15th November. Preferably by email :- laurence.dunderdale@gmail.com Thanks in anticipation, Laurence Dunderdale.

Comments on the village strategic plan (now on the website) will be sought from villagers on 7 November and by invitation on the website and in social media.

Cllr Cook pointed out that RISE grants are now available from not-for-profit and voluntary organisations with details on the Canterbury City Council website. The same website has been revised to enable villagers to log complaints with SERCO about waste bin emptying. The website has also been made more user-friendly for the reporting of fly-tipping.

Highland Court proposals

Council voted on the current Highland Court proposal. 6 voted against the proposals with one abstention. The Clerk was asked to set up a meeting with relevant local parishes to see if there is to be common ground in dealing with this proposal.

Cllr Simon Cook, when asked as the local councillor for North Nailbourne (including Bridge village) rather than as leader of the City Council, to reveal his own thoughts about the proposals said he does not feel convinced that the reasons given for such extensive developments in an Area of Outstanding Natural Beauty are of “national significance” as they would need to be.

Kent News

Villagers are encouraged to respond to the Kent County Council budget settlement themselves by accessing the kent.gov.uk website.

It is clear that there need to be multiple reports for Kent Highways to intervene in road improvements/drainage issues. Villagers will henceforth be encouraged to report problems “en masse”.

Parish news

Management of the sports pavilion has been taken in-house by the parish council. Contact the Clerk to know more about hiring opportunities.

Christmas trees will go up on December 2 and come down on January 6.

Work is likely to start in Green Court on 1 November 2017. Residents will be informed by letter when the exact start date is known.

There have been 3 recent **Speedwatch** sessions. 6 speeding vehicles were reported to police on 29 September and another 11 on 12 October. (2 cars had been travelling over 60 mph near Higham Lane of that occasion). Sessions will be conducted weekly and volunteers are sought from the village.

It was agreed to advertise the **new defibrillator** on social media and to encourage training for interested Villagers.

Next meeting on Thursday, 9 November 2017 at 7.30 p.m. in Bridge Village Hall

It was agreed to publish all BPC policies on the website.

Neighbourhood Plan: The latest version of the plan (v.6 dated August 2017) is to be uploaded to the village website. Cllr Atkinson reported that at the NP meeting held on 17 August (minutes to be uploaded to the village website) members had been informed that Cantley Ltd were no longer interested in developing the site to the north of Conyngham Lane and that a meeting has been set for 5 October with Canterbury City Council.

Bridge Parish Council's draft strategic plan will be published on the website and comments invited from villagers. The Chair emphasised that the document must not be seen as being an exclusive or definitive list of activities for the Parish Council, and that it cannot be considered as binding on future councils.

It was decided to put forward pavilion related projects (heating and insulation) to access **Parish Capital Grant** funds by the deadline of 2 October.

Councillors agreed to formally request of the relevant authorities **dropped kerbs on Riverside Close and the retention of a passing space by Roger's Garage** on the High St.



**Bridge and Patricxbourne Church of
England Primary School**

Bonfire & Firework Display

Saturday 4th November 2017

On

Bridge Recreation Ground

**Look at the School website & posters for
more details**



WRITE FOR RIGHTS

Amnesty International's annual sending of seasonal greetings and messages of hope to prisoners-of-conscience and their families

Come and sign a card at
Friends Meeting House
The Friars, Canterbury
on Saturday 25th November
between 10am and 2pm

Meet Rosie Duffield, Canterbury's new MP
Refreshments – Films – Music



BRIDGE PAVILION

Recently refurbished and refitted
Available for hire
every day of the week all year round

Very well equipped for classes/parties/meetings.

Special rates for local residents.

Call 01227 831085 or email clerk@bridgevillage.co.uk
for a guided tour of the facilities.
On Bridge Recreation Ground close to Riverside Close.
Hurry to avoid disappointment!



Please join us

CAROL SINGING

Sunday 10th December 2017 2.30pm

Mulled wine & mince pies

Please help us to raise money for MNDA

In memory of all those people who suffer or suffered from this disease

Motor Neurone Disease is a progressive disease that attacks the motor neurones or nerves, in the brain and spinal cord. This means messages gradually stop reaching muscles and can affect speech and movement.

CHRISTMAS

at Chalkpit Farm Rural Shopping

www.chalkpitfarm.co.uk
Chalkpit Farm
Bekesbourne, Canterbury CT4 5EU

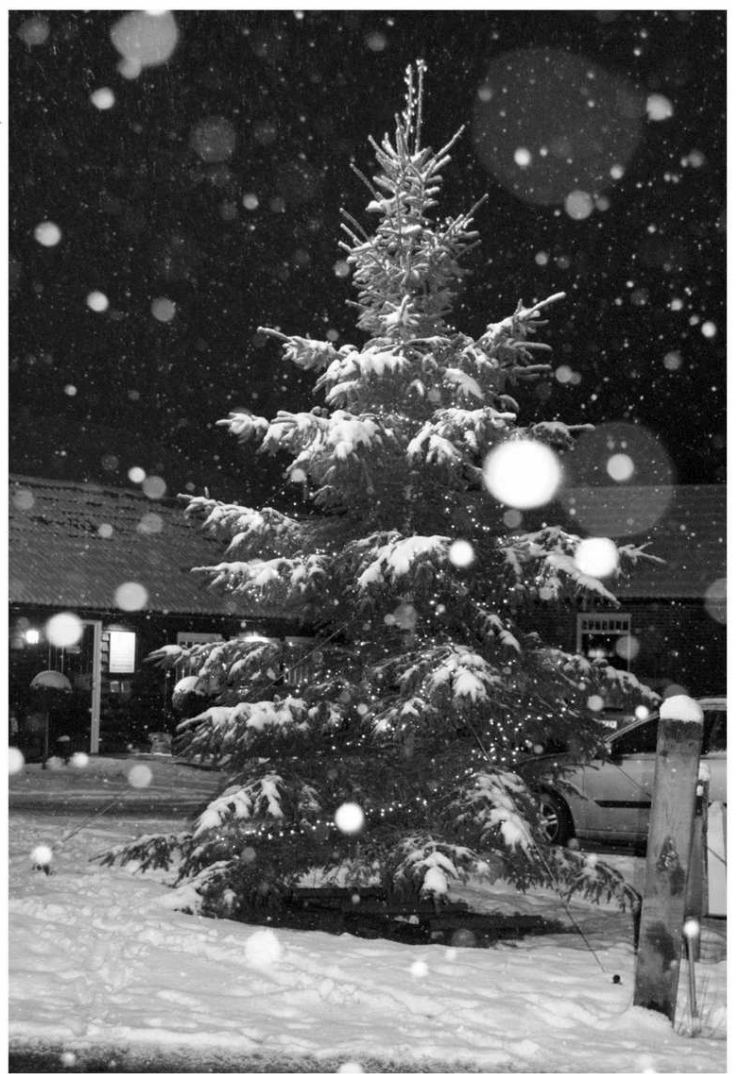

CHRISTMAS FLOWER ARRANGING DEMONSTRATION

with Lauren from Hops & Flowers

Wed 29th Nov & Fri 1st Dec 10.30am-midday

£5 per person Free raffle Booking required



**ONCE INSPIRED, HAVE A GO YOURSELF
AT ONE OF OUR
CHRISTMAS WORKSHOPS**

Door Wreath Class £30 per person
(includes basic wreath materials)

Saturday 25th Nov 10.30am - 12pm & 2pm-4pm

Sunday 26th Nov 11am-1pm

Saturday 2nd Dec 10.30am - 12pm & 2pm-4pm

Sunday 3rd Dec 11am-1pm

Booking required

01227 830666 florist@essentiallyhops.co.uk

www.hopsandflowers.co.uk

Chalkpit Farm, Bekesbourne, Canterbury CT4 5EU



Trees of Love



Remembrance
Service
with Carols

Saturday 9 December
Ashford * Thanet * Canterbury

Saturday 2 December
Romney Marsh

Sunday 3 December
Dover * Cheriton

Friday 15 December
Charing * Barham

Remember family and friends by dedicating a beautiful dove on our illuminated Trees of Love, and join us for a remembrance service with carols

www.pilgrimshospices.org/treesoflove
01227 782062 supporter.relations@pilgrimshospices.org

Sponsored by



CSiS
Civil Service Insurance Society



Super Maids
Est 1988

Domestic Cleaning Services

Tel: 01227 277033

www.supermaids.co.uk

Email: info@supermaids.co.uk

Self-Catering Holiday Home Bridge (Centre)

Sleeps 7-(5 + 2 on sofabed), 3 Bedrooms
Available all year round.

Contact Tina:

07890 613 185 or 0118 375 0393

**YOGA CLASSES @ POLO FARM & LOWER
HARDRES VILLAGE HALL with Cheryl
Rivers FIRST LESSON FREE Monday 1.30-
3.00pm - Lower Hardres Tuesday 1.00-
2.30pm - Lower Hardres Wednesday 4.30-
6.00pm - Lower Hardres Thursday 10.00-
11.30am - Lower Hardres Please contact
Cheryl Rivers on 01227 457707
www.yogawithcheryl.org**

Secretarial Services

Word processing, copy typing of letters, reports, quotes, minutes, CV's, dissertations etc.
Desk top publishing - logos, leaflets, menus, newsletters, posters etc. - Laminating - Photocopying.
Paperwork management, bills, expenses, invoices.
On-line form filling, passport applications forms, television licence forms, DVLA/Car tax.
PowerPoint presentations - Audio transcriptions.
On-line research.
Professionally trained with over 30 years' experience and locally based. Efficient service with a quick turnaround - anything considered.
For more information on Secretary Bird Services please email: secretarybirdservices@outlook.com or call us on: 07590 671965

THE SECRETARY BIRD

HAVE YOU HAD YOUR CHIMNEY SWEPT?

Hollybranch Chimney Sweeping:
Your Local Professional Chimney Sweep
(Evening and Weekend Appointments Available)

CONTACT US TODAY: 07523 056 320 / 01227 701 054
Martyno@hotmail.co.uk
www.hollybranchchimneysweeping.co.uk

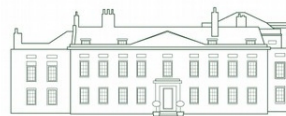

Charlton Park

KINGHAMFORD FOUNDATION LTD

Pilates, Yoga, Ballroom Dancing, Bridge, Nordic Walking, Singing, Work-Out, Piano, Squash, Tennis.
Swimming, Croquet & Cricket (summer)
Details of Venue Hire, Events & Classes:
www.charlton-park.org
01227 831355 info@charlton-park.org

Tressenden Designs

A Seamstress and costume maker with 8 years of experience.
Clothing Alterations.
Repair work undertaken.
Made to Measure; create a bespoke piece for those special occasions.
Modern and Vintage designs.
Costumes, ball gowns and Wedding dresses.

NACS Registered
HETAS Qualified
Fully Insured
Chimney Lining, Pots & Cows
Fireplaces Fitted
Stoves Installed & Serviced



P J Sweeps
Phillip Joiner
Chimney Engineer
Over 10 Years' Experience

01227 700 909 pjsweeps@hotmail.co.uk

For more information or a quote please contact Amy on:

BEKESBOURNE STABLES

Liveries, hacking and lessons for all ages
and abilities

Pony rides and parties

Horses taken for schooling

Horses hired out for hunting

We are a fully licensed and insured
establishment

with many year of experience.

Situated in walking distance from
Bekesbourne Station, CT4 5EX

For info or to book call
01227 830910 or 07764776057

WE UNDERTAKE ALL ASPECTS OF
LANDSCAPE AND GARDEN MAINTENANCE

WORKS INCLUDE, BUT NOT LIMITED TO:

TREE SURGERY
MOWING
LANDSCAPING
HEDGE CUTTING
TURFING
FENCING
DECKING



T: 07850115270
www.meadowsgardenmaintenance.co.uk
E:
ryan.meadowsgardenmaintenance.co.uk
[/meadowsgardenmaintenance.co.uk](http://meadowsgardenmaintenance.co.uk)



Bed and Breakfast in Bekesbourne's
restored Victorian school house parking off
road; 5 mins to Bekesbourne station private
bathroom Phone: Gillian Wills 01227 830115
or 0754 787 8571

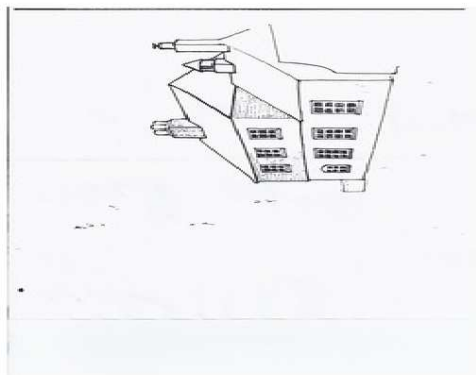

G. Blackwell BUILDING CONTRACTOR

Extensions, Garages

Roofing

Restoration

Alterations etc.

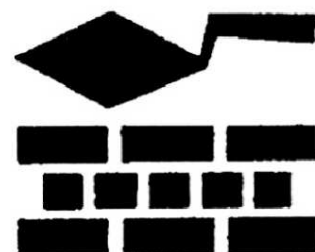

Canterbury: 860480

TEL:01304 813372

THE CARPETMAN

MOB:07976 037683

David Brazier est, over 25 years

Local supplier and fitter of quality flooring

CHOOSE FROM A HUGE RANGE OF CARPETS,
VINYL AND OTHER FLOORING AT BELOW SHOP
PRICES IN THE COMFORT OF YOUR OWN HOME

WARE

ASH



**ASHTON
TREE CARE**

07929 627622 • 07769 908027
OLLIE@ASHTONTREECARE.CO.UK

City &
Guilds
NPTC

ALL WORK
FULLY INSURED

HEDGE CUTTING
STUMP GRINDING
TREE SURGERY



We specialise in bespoke, traditionally crafted oak framed outbuildings, extensions & conservatories.

We also offer all general carpentry services.

Contact Mark or Helen for your FREE quote.

07977 304 968

honeyoakcarpentry@gmail.com

www.honeyoakcarpentry.co.uk



**BRITISH CACTUS AND SUCCULENT SOCIETY
HERNE BAY & DISTRICT BRANCH**

MEETINGS ARE HELD

EVERY THIRD WEDNESDAY OF THE MONTH FROM 7.30PM at
THE OVER 60's CLUB, PETTMAN HOUSE, HANOVER SQUARE,
HERNE BAY. CT6 5NY NEW MEMBERS ARE ALWAYS WELCOME
For further details please contact Philip Andrews Tel: 01227 830960

Entertaining speakers
Variety of topics
Free refreshments
Friendly chat

AcklandWebb

Chartered Certified Accountants and business advisers

- Local family business
- Friendly & professional service
- Specialists in small to medium-sized businesses & start ups
- Full range of accountancy and tax services
- Testimonials & references available
- No cost/no obligation initial meeting

Contact: David Muggridge

Tel: 01227 811745

Email: enquiries@acklandwebb.co.uk

Web: www.acklandwebb.co.uk



LANDCARE



Tree Surgeons
Fencing
Landscapes
Maintenance

NPTC certificated
Fully insured
20 years established
Local references available

www.landcaretreesandfencing.co.uk

07740-949836

07770-899548

SAXON LODGE RESIDENTIAL HOME LTD 30 WESTERN AVENUE, BRIDGE, KENT CT4 5LT Family run home. established for over 20 years, recently extended to accommodate 23 residents with 12 ensuite rooms. We cater for permanent, respite, holiday stays, rehabilitation and day care. For further information contact Anita Easton (Manager) on 01227 831737 or info@saxonlodge.co.uk KCC & CQC registered; KCC contracted www.oasiscaregroup.co.uk

BARKING BEAUTIES KENT The Old Stables, Highland Court Farm, Brid
Canterbury, Kent CT4 5HW Telephone: 01227 830166 Mobile: 07866 46:



Fully Qualified City & Guilds grooming in the following techniques Bathing, drying,
nail clipping Full breed standard clip to breed styles De-matting
shedding Fully qualified City and Guilds Master Diploma and insured salon Equipped for larger breeds as well as to
groomers Prices start from £15 for simple wash & blow dry. Find us on Facebook under
Affinity Barking Beauties

CS SATELLITE TV SERVICE

CHRIS SHEATHER

5. WHITELOCKS CLOSE, KINGSTON,
Nr. CANTERBURY, KENT. CT46JG.

01227830179

SUPPLY. INSTALL. REPAIRS. DIY ADVICE



GreenStone
CHARTERED
SURVEYORS

07443 496025



If you are looking to buy a residential property in East Kent, we are independent Chartered Surveyors that specialise in: RICS Building Surveys RICS Homebuyer Report Valuations We provide a professional, friendly and approachable service with over twenty years experience. greenstone.surveyors@hotmail.co.uk Ty Bryn, Patixbourne, CT4 5BT www.greenstonesurveyors.co.uk



REVELATION OAK
— BUILDINGS —

Our experienced craftsmen build to your exact specification, a range of oak framed structures. From Houses to Log stores. For more information visit us online or contact us at: www.revelationoak.com Tel : 07513057656 revelationoak@gmail.com

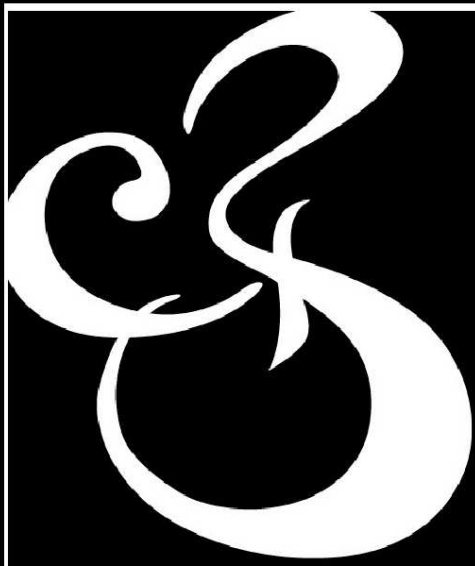

Charles Bainbridge

Estate Agents

National award winning service and marketing across sales, lettings and property management.



01227 780227

charlesbainbridge.com

WOODLANDS
hair . beauty . holistic therapies

Ladies & Gents Hairdressing Hot Stone Massage Spray Tanning Jessica Manicure & Pedicures Facials Pregnancy Massage Acupuncture Waxing For more details please visit our website We look forward to welcoming you to Woodlands very soon! 26a High Street, Bridge, Canterbury, Kent, CT4 5JZ 01227 830120 www.woodlands-bridge.co.uk



The CANTERBURY
AUCTION Galleries



FREE ANTIQUE VALUATION SERVICE

Every **Friday 10am to 1pm**. Home visits by appointment.

CANTERBURY **01227 763337**

40 STATION ROAD WEST, CANTERBURY, KENT CT2 8AN

www.thecanterburyauctiongalleries.com



Hart Lee

Tree Surgery & Stump Removal

Domestic & Commercial Contractors

■ All Aspects of Tree Work

■ Garden & Site Clearance

■ Hedge Trimming

■ Tree Planting

Call Tony

City &
Guilds
NPTC
Qualified

Fully
Insured

T:01227 761502

M:07708 537683

W:hartleetreesurgery.co.uk

S & W ASPHALT FLAT ROOFING SPECIALISTS

16 BROOKLANDS CLOSE
FORDWICH
CANTERBURY
KENT CT2 0BT

Tel: 01227 731576 office
Mobile: 0795 0299346

Bay Tree Accountancy
www.baytreeaccountancy.co.uk



ICAEW
CHARTERED
ACCOUNTANT

Annual Accounts
Tax Returns
Payroll
VAT Returns
Management Accounts

Sue Leitch -
Chartered Accountant - FCA MAAT

Tel: 01227 709741
Email: sue@baytreeaccountancy.co.uk

“Dad Will Fix It”

- **Lawn Mowing**
- **Tree & Hedge Trimming**
- **Strimming & Brush Cutting**
- **Overgrown Gardens**
- **Locks & Security**
- **General DIY Repairs**
- **Flat Pack Assembly**
- **Fences & Gates**



Mark BRADLEY
07767 480167

Email:
Dadwillfixit@hotmail.com

People of the Bridge Group of Churches

The Vicar:

Vacant

Reader:

Mrs

Margaret Clarke
01227-765598

mrsmaclarke@yahoo.co.uk

Authorised Lay

Minister:

Mrs

Beverly Latham
01227-830365

Administrator:

Sian Smith-Keary

bridgeoffice23@gmail.com

St Mary's Patixbourne with St Peter's Bridge

Churchwardens:

Dr Andrea Nicholson
01227-830947

Mrs Pauline Pritchard
01227-830685

Mr Laurence Dunderdale
01227-830668

laurence.dunderdale@gmail.com

Mrs Evelyn Andrews
01227-830960

evepurlins@btinternet.com

PCC Secretary:

Mr Alan Barber

01227-831956

PCC Treasurer:

Mr Devin Brougham
01227-

709690

dwbrougham@aol.com

Gift Aid Officer:

Mrs Evelyn Andrews
01227-

830960

Christian Aid:

Mrs Jean Barber

#

On the Nail

A magazine for the villages
along the Nailbourne

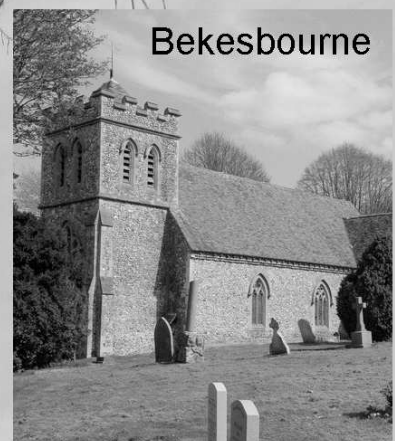
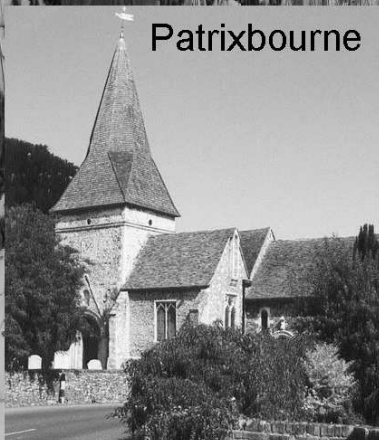
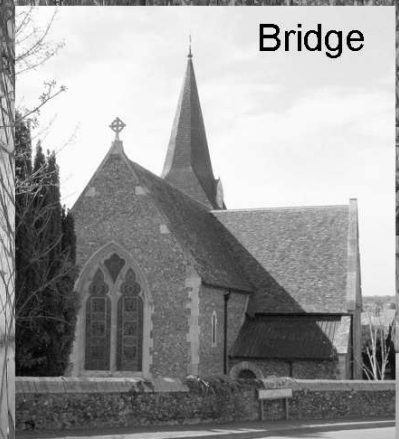

Dec/Jan 2017/8 50p

BRIDGE HEALTH CENTRE

Permanent Clinical Hair Removal
Many other skin blemishes treatable

01304 380249

Jacqueline Tall MBIAE CRPE (Fellow) DAE

B&C Roofing

All your roofing needs
No job too small
Fully insured.
Local, friendly, reliable service
FREE QUOTATIONS
Call Ben 01227 363366
07949973176

ALEXANDER
DIGITAL AERIALS AND SATELLITE
01227 832220

SARAH de ROUEMONT
RENOVATION AND GUNSLISTERY
ALL COMMISSIONS CONSIDERED
Tel: 07573 37817

Plastering
Interior & Exterior
- Interior Plastering
- Ceiling Work
- Exterior Rendering
- Plastering Windows & Exterior
Chris Palmer
3 Green Court
Bridges, Canterbury, Kent CT4 5LJ
07505 655047

JOHN SWAIN
Electrician
39 The Street Kingston, Canterbury, Kent CT4 6JQ
Tel: Canterbury (01227) 830842

Bridge Village Playgroup
Full, Part, Drop In
Mon 09:00 - 12:00
Tue 09:30 - 09:30
Fully qualified and very experienced staff
Enrolled OFSTED Register

C W LYONS & SON LTD
FUNERAL DIRECTORS & MONUMENTAL MASONS
70 Military Road, Canterbury
24 Hour Service Tel: 01227 463506
Family Owned, Est 1911
Members of IAF, NAFD & NAMP
Prepaid Funeral Plans Available



Personal Trainer

Peter Foster
Mobile: 07931 515290
Email: fitnessadviser@aol.com

YMCA Qualified
Member of Fitness Professionals
Full Liability Insurance

MATHS TUITION

GCSE & iGCSE
Key Stage 2-4
Preparation for Kent Test
& Entrance exams
12 years experience of tutoring
Enhanced DBS certificate
Patient, reliable and approachable
Using a wide range of resources I enable students to reach their potential.
Please contact: Clare Newman

01227 700291 for further details.

NEED A VAN?

THEN I'M YOUR MAN

For all light removals, furniture, and domestic items including house clearances.
Safely transporting antique furniture a speciality.
* Avoid expensive pick-ups and drop-offs
* Remove, dispose or recycle all household items including electrical appliances
* Based in Barham
* Reasonable and fair rates
* Free estimates and quotations

CALL CHRISTIAN ON:

01227 831639 07771 728080

Email: stalegate@hotmail.co.uk

We clean your oven...

...so you don't have to!

Oven Wizards
We clean your ovens...so you don't have to

Call David Bayliss on:

01303 488237

www.ovenwizards.com

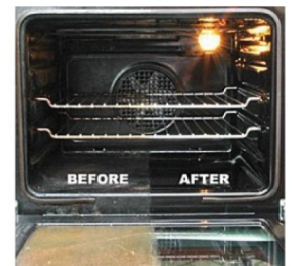

Bridge Village Playgroup

A traditional Playgroup in the heart of Bridge Village.

A caring, nurturing safe environment for your child to grow & gain independence.

Limited spaces available.

Mon & Tues 9.00am - 3.30pm

Wed, Thurs & Fri 9.00am - 12.00pm
Contact Mary / Jane 07790 096 325



Family owned and run
 Convenient parking
 Committed to quality care
 Purpose designed modern practice
 Relaxed atmosphere
 24 hour emergency service
 Consultations by appointment
 Modern purpose designed facility
 Rob and Rachel McMeeking
 Chalkpit Farm, Adisham Road,
 Bekesbourne, Nr. Canterbury Kent
 CT4 5EU (Opposite Essentially
 Hops)

e-mail : info@bournevets.co.uk
 Web : www.bournevets.co.uk

01227 832322

Bettina Sings

Wedding, Celebration of
 Life and Event Singer

*Classically trained
 With over 30 years experience*

07801572538
bettinawalker66@icloud.com



Please contact for full repertoire & fees
 All genres considered with given notice



www.facebook.com/bettinasings
www.bettinasings.com



R.B.W

**KENT'S WATER FEATURE
 SPECIALISTS AND
 POND BUILDING EXPERTS**



Garden / Pond Design, Building and Refurbishments
 Pond Cleaning / Maintenance / Maintenance Contracts
 Child Safe Pond Covers
 Filtration Specialists
 Patios - Decking - Fencing - Brickwork - Arbours

Tel: 07563212858

**FREE ESTIMATES and
 CONSULTATIONS**

www.ReflectionByWater.com

Email: andrewlongrbw@hotmail.com

We come to you...



PC & Laptop Repairs. Data Recovery
 Networking & Maintenance.
 Repairs & New Systems . Upgrades.
 Virus Removal/Protection.

info@gingercatcomputers.co.uk
www.gingercatcomputers.co.uk

01227 700736
07970 455861



www.gingercatcomputers.co.uk

YOUR LOCAL PRINTER

Over 25 years working in and for local
East Kent communities

design | web | print



HAYWARD
DESIGN & PRINT

3-4 Builders Square, Littlebourne, Canterbury, Kent CT3 1XU
T. 01227 721 864 W. hayward-design.co.uk

Canterbury Roofing Specialist

Slate roofs
Kent pegs
New roofs
Repair work
Fibreglass flat roofs
All building work carried out

Family run business
www.rooferincanterbury.co.uk
Contact Gary or Trevor for a free quote.

Syvilla
Canterbury Road
Chilham, Canterbury

Tel: 01227 731845 Mobile: 07796 165289

Local lady, offers help with:
shopping; cooking; cleaning; and personal care
Local references available.
07752 975242

Bridge Haven Care Home

Conyngham Lane, Bridge, Canterbury CT4 5JX

High quality residential, dementia
and respite care.

The home provides a safe and welcoming
environment for residents living with
dementia or using our respite services.

For more information please call us on:

01227 831607



COUNTRY FLORIST COUNTRY FLOWERS

HOPS & FLOWERS

BY ESSENTIALLY HOPS



OPEN: MON-SAT 9AM-5PM
SUN 10.30AM-4PM (EASTER - XMAS ONLY)
TEL: 01227 830666
EMAIL: SHOP@ESSENTIALLYHOPS.CO.UK

CHALKPIT FARM RURAL SHOPPING,
BEKESBOURNE, NR CANTERBURY CT4 5EU
WWW.HOPSANDFLOWERS.CO.UK



incorporating Browns
colebrooksturrock.com



88 High Street, Bridge, CT4 5LB 01227 831999 bridge@colebrooksturrock.com

The village and rural property experts with specialist knowledge of your area.

No obligation consultations on all aspects of sales and lettings.



nicholas james hair limited

Cutting and styling hair in a relaxed and friendly environment with easy free parking outside the door

BED HEAD

PAUL MITCHELL

TIGI tel: 01227 830565

4 western ave, bridge, canterbury, kent, ct4 5ls.

THE CITY SWEEP CHIMNEY SWEEP

Brush and Vacuum

All Chimneys, Boilers & Stoves Swept
Woodburning Stoves & Fireplaces Fitted
Chimneys Lined, Certificates Issued
HETAS & NACS registered, fully insured
Member of the National Association of
Chimney Sweeps

Tel: 01227 450888 Mob: 07813 716654



SARAH de ROUGEMONT

UPHOLSTERY, FABRICS
AND RENOVATION
ALL COMMISSIONS CONSIDERED
Tel: 07973 377817 or 01227 455841

FAMILY HISTORY

Fully qualified & 35 years' experience

GENEALOGY

All Britain covered – online sources and
Original Records

Free 30 mins consultation – chat
schofield312@btinternet.com
01227 721192

Paw Patrols

DOG WALKING,
HOME BOARDING AND DAY CARE
Hannah Terry
Nearly 20 Years' Experience
Fully Insured and Licenced
Reference's Available on Request
07855 832045

Kent Roofing

Loft Conversions, Tiling
Flat Roofing, Roofs Cut and Pitched
UPVC Facia and Guttering
Roof Windows Fitted
FREE ESTIMATES
Phone 01227 861149



Unit 11 Partridge Drive, Bridge
CANTERBURY CT4 5BF
(01227) 831928
Servicing & MOT's Classes 4,5 lights & 7
Welding
Full Diesel & Petrol Diagnostic
Cars collected and returned locally



NORTHDOWNNS
COSMETIC
CLINIC

Wrinkle reduction facial injections
Dermal filler treatment
Excessive armpit sweating treatments

By Dr Andrew Reed MB BS, MRCGP

Consultations and treatments in your own home for privacy and convenience

Also available at the
Barn Hair and Beauty, Stone Street, Petham, Canterbury.

See www.northdownsclinic.co.uk for further details or email on
enquiries@northdownsclinic.co.uk

D.M.B. Plastering

All aspects undertaken

*Interior. Exterior. Plastering.
Rendering.*

Coving. Ceiling. Walls. Floors.

*Finest quality assured.
CSCS Certified.*

Over 28 years experience.
Free estimates. Reliable service.
Fully insured.

Call David on **07818 607209**



ELITE BLINDS AND SHUTTERS

Made to Measure Quality Window Blinds and Shutters
For your home, conservatory, office, school, hotel and more...
Call David or Katie on 01227 714716
info@elite-blinds.com

www.elite-blinds.co.uk

The Canterbury Hope Foundation.
Professional, affordable,
psychotherapy/counselling.

A broad range of mental health symptoms and psychological issues treated.
Free assessment.

Contact Chris or Helen:
T: 01227 788869

canterburyhopefoundation@gmail.com
www.canterburyhopefoundation.com



**TAP
STREET
MODERN
BALLET
MUSICAL
THEATRE**

Classes For Ages 3+ In Bridge & Barton Road, Canterbury

**CALL NOW
TO BOOK YOUR PLACE**

Email: laura@dancextreme.co.uk
Tel: 07817 966 547



www.dancextreme.co.uk

facebook.com/dancecanterbury

C W LYONS & SON LTD

FUNERAL DIRECTORS & MONUMENTAL MASONS

70 Military Road, Canterbury
24 Hour Service Tel: 01227 463508

Family Owned. Est 1911

Members of SAIF, NAFD & NAMM

Prepaid Funeral Plans Available



Dean Fielder Plumbing Services

07595 266 270 / 01304 841224

dean@deanfielderplumbing.co.uk / www.deanfielderplumbing.co.uk

Friendly and Reliable - no job too small

All aspects of plumbing considered

- 💧 Bathrooms, taps, showers, pumps
- 💧 Kitchens, sinks, taps, dishwasher and washing machine installation
- 💧 Water Softeners, instantaneous water heaters
- 💧 Hot and cold water supplies and storage, immersion heaters
- 💧 Ball valves, stop cocks, waste pipes, drips, leaks
- 💧 Heating controls/valves
- 💧 Radiators and valves
- 💧 Outdoor taps
- 💧 Kitchen and bathroom tiling

<p>ALEXANDER <small>SCOTTISH AIRFIELD AND SATELLITE</small> 01227 852225</p>	
<p>SARAH de ROUEMONT <small>RENOVATION AND DECORATION</small> <small>ALL COMMISSIONS CONSIDERED</small> <small>Tel: 07933 37817</small></p>	<p>Plastering <small>• Ceiling</small> <small>• Wall</small> <small>• Skirting</small> <small>• Parapets</small> <small>• External</small> <small>• Internal</small> <small>• Kitchen</small> <small>• Bathrooms</small> <small>• Repairs</small> <small>07805 608247</small> <small>www.cwslu.com</small></p>
<p>JOHN SWAIN <small>Electrician</small> <small>39 The Street, Kingsley, Canterbury Kent CT4 6JQ</small> <small>Tel: Canterbury (01227) 830842</small></p>	
<p>Bridge Village Playgroup <small>Unit 1001, Stone, Kent</small> <small>Mon-Thu (morning) 9:00 - 12:00</small> <small>Tel: 07790 004525</small> <small>Fully qualified and very experienced staff</small> <small>Excellent Ofsted Report</small></p>	
<p>C W LYONS & SON LTD <small>FUNERAL DIRECTORS & MONUMENTAL MASONS</small> <small>70 Military Road, Canterbury</small> <small>24 Hour Service Tel: 01227 463508</small> <small>Family Owned. Est 1911</small> <small>Members of SAIF, NAFD & NAMM</small> <small>Prepaid Funeral Plans Available</small></p>	

<p>G. Blackwell BUILDING CONTRACTOR <small>Extensions, Garages</small> <small>Roofing</small> <small>Restoration</small> <small>Alterations etc.</small>  <small>Canterbury: 860480</small></p>	<p><small>Daily visits and holiday care for your pets in the comfort of their own home</small> priority pets <small>For more information contact Paul on 01227 700070 or 07729 20000 (mobile)</small>  LANDSCAPE SERVICES <small>Trees & Fencing</small> <small>Professional Landscaping Services</small> <small>Telephone: Shaun 01227 722257 Mobile: 07460 868206</small></p>
<p>CLARKS LANDSCAPE SERVICES <small>PRIVATE AND COMMERCIAL</small> <small>including garden design and construction, Grass laying or replacement, turfing, hedging and site clearance. Grass cutting service from £4.00 per cut.</small></p>	<p><small>The Orchard</small> Monkey Lane <small>Canterbury</small> <small>CT4 6JH</small> <small>Tel: 01227 820536</small></p>
<p>SWEETS STUFF <small>Fun Cakes for any occasion</small> <small>Made to order</small> <small>Why not have something different for your next celebration?</small> <small>These 'cakes' are made entirely of sweets!</small> <small>01227 740944</small> <small>07810 425035</small> <small>www.sweetststuff.co.uk</small></p>	<p>J D Carpenter <small>Handmade Furniture</small> <small>Canterbury</small> <small>CT4 6JH</small> <small>Tel: 01227 820536</small></p>

"Logs for Sale"

HEATdesign
Warming your world!

31 Wincheap,
Canterbury, Kent CT1 3RX
01227 457643
heatdesignkent.co.uk

Heat Design is a family run company with over 25 years experience, selling Wood burning stoves, gas fires, fireplaces, Aga and Rayburn in Kent.

Our Wincheap showroom over two floors shows an extensive range of our products with live working models allowing you to experience how a woodstove, gas fire or Aga would enhance your home.

We offer a full service from supply only to design, survey and installation – our knowledgeable and friendly staff will be happy to assist. With an Aga cookshop range and an interesting mix of home interiors accessories there are plenty of reasons to call in and take a look at our ever changing stock.

RAYBURN

AGA

T 01227 832610 M 07534 288864
E info@bournetogarden.com

g Bourne
to
Garden

Gardening services including:

- Fencing
- Landscaping
- Regular contracts
- Turfing
- Garden clearances
- Lawn treatment
- Seasoned logs
- Weed control
- Hedge cutting
- Mowing
- Tree surgery

Fully qualified and insured

www.bournetogarden.com



Environment
Agency



for the largest choice call

BERRYS

CANTERBURY LTD

the Premier Letting Agents

1921

90
years
2011

01227 765268

www.berryscantebury.co.uk

70 Castle Street Canterbury

Dec 2017 	St Mary NACKINGTON	St Mary LOWER HARDRES	St Peter BRIDGE	St Mary PATRIXBOURNE	St Peter BEKESBOURNE
3rd Dec 1 Cor. 1.3-9 Mark 13. 24-end	9.30am Advent Carol Service Lay led	11.00am Family Communion RH	6.00pm Evensong MC	9.30am Sung Eucharist JB	10.00am Songs of Praise Lay led
10th Dec 2 Pet. 3.8-15a Mark 1.1-8	9.30am Sung Eucharist RH	4.00pm Carol Service MC	9.30am Family Communion JT	<i>All welcome at the other services of the Benefice</i>	8.00am BCP Holy Communion JT
17th Dec 1 Thess. 5.16-24 John 1.6-8, 19-28	<i>All welcome at the other services of the Benefice</i>	3.00pm Crib Service MC	11.00am Choral Eucharist GB 6.00pm Carol Service Lay led	<i>All welcome at the other services of the Benefice</i>	9.30am Sung Eucharist RO
22nd Dec	<i>All welcome at Patrixbourne</i>			7.00pm Carol Service Lay led	<i>All welcome at Patrixbourne</i>
24th Dec Rom. 16.25-end Luke 1.26-38	10.00pm Christmas Eucharist RO	9.30am Communion by extension MC	3.00pm Christingle MC 5.00pm Christingle BL 11.30pm Christmas Eucharist TCW	<i>All welcome at the other services of the Benefice</i>	11.30pm Christmas Eucharist CE
25th Dec Heb. 1.1-4 John 1.1-14	<i>All welcome at the other services of the Benefice</i>	9.30am Family Service MC	<i>All welcome at the other services of the Benefice</i>	9.30am Sung Eucharist DL	11.00am Carol Service Lay led
31st Dec Isa. 61.10-62.3 Luke 2.15-21	<i>All welcome at Lower Hardres</i>	9.30am Benefice Service RH	<i>All welcome at Lower Hardres</i>		

There is Holy Communion **every Tuesday at 9.30am** to 10.00am at Bridge Church, followed by coffee. All welcome.

CHURCH SERVICES FOR Jan 2018	St Mary NACKINGTON	St Mary LOWER HARDRES	St Peter BRIDGE	St Mary PATRIXBOURNE	St Peter BEKESBOURNE
7th Jan Epiphany Isa. 60.1-6 Matt. 2.1-12	<i>All welcome at the other services of the Benefice</i>	11.00am Family Communion RH	6.00pm Evensong MC	9.30am Sung Eucharist CB	10.00am Songs of Praise Lay led
14th Jan 1 Sam. 3.1-10 [11-20] John 1.43-end	9.30am Sung Eucharist RH	4.00pm Evensong MC	9:30am Family Communion DL	<i>All welcome at the other services of the Benefice</i>	
21st Jan Rev. 19.6-10 John 2.1-11	<i>All welcome at the other services of the Benefice</i>	9.30am Family Service MC	11.00am Choral Eucharist CB	8.00am BCP Holy Communion DL	9.30am Sung Eucharist RH
28th Jan Deut. 18.15-20 Mark 1.21-28	9.30am Sung Eucharist RO	<i>All welcome at the other services of the Benefice</i>	11.00am Community Worship BL	9.30am Matins MC	<i>All welcome at the other services of the Benefice</i>
4th Feb Mal. 3.1-5 Luke 2.22-40	<i>All welcome at the other services of the Benefice</i>	11.00am Family Communion RH	6.00pm Evensong MC	9.30am Sung Eucharist CP	10.00am Songs of Praise Lay led

BL Bev Latham

CB Rev Clive Barlow

CE Canon Clare Edwards

CP Canon Caroline Pinchbeck

DL Rev Donald Lugg

GB Rev Garth Barber

JB The Venerable John Barton

JT Rev John Tomlinson

MC Margaret Clarke

RH Canon Reg Humphriss

RO Rev Richard Owen

TCW Rev Thomas Collett-White

Dates for the diary – December 2017

Tuesday 5th

9:30am - Holy
Communion, St Peter Bridge
3:00pm – Holy
Communion, Bridge Haven
7:30pm – After
8's, Mansfield Court

Thursday 7th – 7:30pm -
choir and Salvation

Carols and Readings with School

Band

Friday 8th – 2:30-3:00pm – School Prayer Meeting, St Peter Bridge

Tuesday 12th

9:30am - Holy
Communion, St Peter Bridge
2:30pm – Carol
Service, Mansfield Court

Wednesday 13th

9:30am – Bridge
School Nativity – all welcome
10:00am - FISH pop-in
coffee, Bridge Village Hall
2:00pm -
Social Afternoon, Lower Hardres

Thursday 14th

9:30am –
Bridge School Nativity – all welcome

Monday 18th – 1:30pm –
senior citizens,

Annual Afternoon of Entertainment for

School

Tuesday 19th

9:30am - Holy
Communion, St Peter Bridge
3:00pm – Carol
Service, Saxon Lodge

Wednesday 20th - 2:00pm - Carols at Bridge Haven

Dates for the diary – January 2018

Tuesday 2nd

9:30am - Holy
Communion, St Peter Bridge
3:00pm – Holy
Communion, Bridge Haven

News from Bridge & Patrixbourne Church of England Primary School

Since the beginning of the academic year in September, it has been a very busy and successful time for our school. Our children exhibited at Art in Bridge and have opened up the school to parents and the community to view their learning. Our Year 6 children have performed both Romeo & Juliet and A Midsummer Night's Dream, a part of the Royal Shakespeare Schools' Festival, at the Gulbenkian Theatre, and as part of the Canterbury Festival, our orchestra performed in the Spiegel Tent.

It was fantastic to see so many people in the village community and beyond, attending our fireworks display and this helped us to raise much needed funds for the school, so that we can continue with the development of art and music, especially in this time of significant budget cuts. We have also contributed some of these funds to the Royal British Legion and to the Oncology Department at Kent & Canterbury Hospital.

In terms of our achievement, we have recently received a letter from Patrick Leeson, Corporate Director of Children, Young People and Education, at KCC, recognising the achievements in our school of the children. To view the letter, please visit our school website at www.bridge.kent.sch.uk.

Our great learning and ethos was also recognised in October, where we underwent a Statutory Inspection of Anglican and Methodist Schools (SIAMS) inspection, in which we were graded Outstanding across all aspects.

As I mentioned in the summer term, I will be leaving Bridge & Patrixbourne Church of England Primary School on 20th December 2017, having been at the school for over 12 years. The school and the village community will always hold a dear place in my heart.

In this time of change for our school, we have also appointed a new Chair of Governors, Matthew Jones, who will continue to help guide the Governing Body, along with the Senior Leadership Team, to strategically lead our school. I would like to take this opportunity to say thank you to Dr Jeremy Hayter, our previous Chair of Governors, for all his help, devotion and hard work, during his term as Chair.

Once again, I would like to say that it has been an absolute pleasure to have worked in our school and serve the local community and I would like to thank you for all your support and kindness; I will miss you all.

Renuka Chinnadurai Headteacher

As Ren mentioned in the summer, I will be taking over as Acting Headteacher through until September 2018, and during this time our school will be looking for someone to take on the permanent position of Headteacher. I look forward to working closely with the village community, continuing to build strong links with you and the church and to meeting you around the village.

Matt Harper Deputy Headteacher

Christmas Workshop

On Saturday, December 2nd, there will be a Christmas Workshop at John Baker White Hall, at 9.30am to noon. There will be lots of activities for Children, and refreshments for all. If your child is under school age, please stay during the workshop. For a place, please ring Julie on 788316, or Margaret on 765598. Please book early. A small contribution of £1.00 per child for materials would be appreciated. For a place, please ring Julie on 788316 or Margaret on 765598. Do come along, it'll be fun!

Lower Hardres Carol Service on Sunday 10th December at 4.00. Followed by mince pies and mulled wine.

Lower Hardres Crib Service – on 17th December at 3pm we have our Crib Service. It is a special service of celebration, when the children will assemble our CRIB, in preparation for Christmas. It would be lovely if the Children could dress in Nativity Character. Our charity this year will be the Canterbury Food Bank. Please bring along your gifts Festive Food to our Christmas Crib Service, and make Christmas 2017 special for others.

Christmas Day Service, Lower Hardres at 9.30am. A short, friendly service, and a chance to meet friends and Worship on Christmas Day.

On Sunday 7th January 2018 at 11am, which is our Family Communion, we will celebrate Epiphany, when the Wise Men came to worship our Lord.

A VERY HAPPY CHRISTMAS AND NEW YEAR — Margaret

Bridge and Patixbourne C. E. Primary School

The staff and children of the school invite you to an
Evening of Carols and Readings with
the School Choir and The Salvation Army Band
on Thursday 7th December in the school hall at 7.30pm
No tickets, please donate on the door.

On 18th December at 1.30pm the school will be hosting their
Annual Afternoon of Entertainment for all local
Senior Citizens in the school hall.

The afternoon starts with each year group taking turns
singing and finishes off with refreshments served by Year 6 pupils.
If you would like to join in please let the school know in
advance by ringing 830276.

Fish News December 2017 and January 2018

The December Coffee Pop-In on Wednesday 13th will again have carols with the kind accompaniment of Stuart Field and Jean Barber. A representative from Hi Kent will also be there in Bridge village hall.

The January Pop-In is on Wednesday 10th and the Winter Warmer Lunch will be on 31st. The Fish phone number is 07935 966 080

Ride and Stride Bridge

Thank you to everyone who took part in this year's Ride and Stride, the Recorders and Ian and Amy Osterloh who raised £184. A further £95 was raised by the Recorders giving a total of £279. This meant that St. Peter's received £139.50 towards Church funds. David Edmonds.

St. Peter's Bridge Flower Arrangers

There will be a flower meeting on Friday 8th December at The Archways, Conyngham Lane, Bridge to discuss Christmas decorations for St. Peter's church Bridge and the rota for next year. All welcome to come for a cuppa and homemade cake to see what we flower arrangers do and join us in 2018 if you wish. Viv Brasier. tel: 01227 830891.

Bridge & District History Society

The first meeting of the new year will be held on Thursday 18th January 2018 at 7.30pm in Bridge Village Hall. Anthea Bryant will give a talk on Hidden Castles and Gardens of the South East.

Members £4.00, non-members £5.00 to include refreshments.

Further details from David Gilmour, Tel: 832450.

Recreation Ground

October and November have been busy months on the recreation ground. Some of the children of Bridge and Patricbourne C. E. Primary School spent an afternoon planting bulbs on the banks of the Nailbourne. Adult volunteers have cleared fallen leaves in the wild flower area and along the path to the school. Thank you for all your hard work in making the recreation ground a pleasant place to visit and enjoy.

Sue Hodges

Thank you

May I thank the kind people who sent me cards and gifts and visited me with good wishes for my recovery from having the second hip replaced. It has been a success and I am making slow progress. So glad I do not have four legs, two is enough!

Thank you all again and God Bless. Diana

*You are warmly invited to
Come and Sing Carols*

at St Peter's, Bridge - 6pm on Sunday, December 17th

and, more particularly, to join us in the **Bridge Choir**, which will be sp^eci^ally

augmen^te^d as usu^al for the

Friends of St Peter's Church Bridge

COFFEE & CAKE

1st ANNIVERSARY CONCERT

9th December 10.30 to 11.30

The stories behind our



Where do they come from? Who wrote them?



Why?



*A glimpse into the origins of our Christmas
Carols in words and music*

Jean Barber (Piano) Stuart Field (Violin)

Suggested donation £3, children free, all proceeds towards church repairs.



The Charlton Larks

Directed by Emily Renshaw

The Charlton Larks invite you & your friends to

"A Celebration of Christmas"

Carols & Coffee

10.30am

Wednesday 13th December

St. Mary's Church - Patrixbourne CT4 5BP

Coffee and Mince Pies - Children welcome

All Donations to Church Funds



**St Peter's Church,
Bekesbourne**

Christmas Day

Carols & Christmas Story

11am Monday 25th December

SUITABLE FOR ALL AGES.



**EVERYONE WELCOME TO
COME AND JOIN IN!**

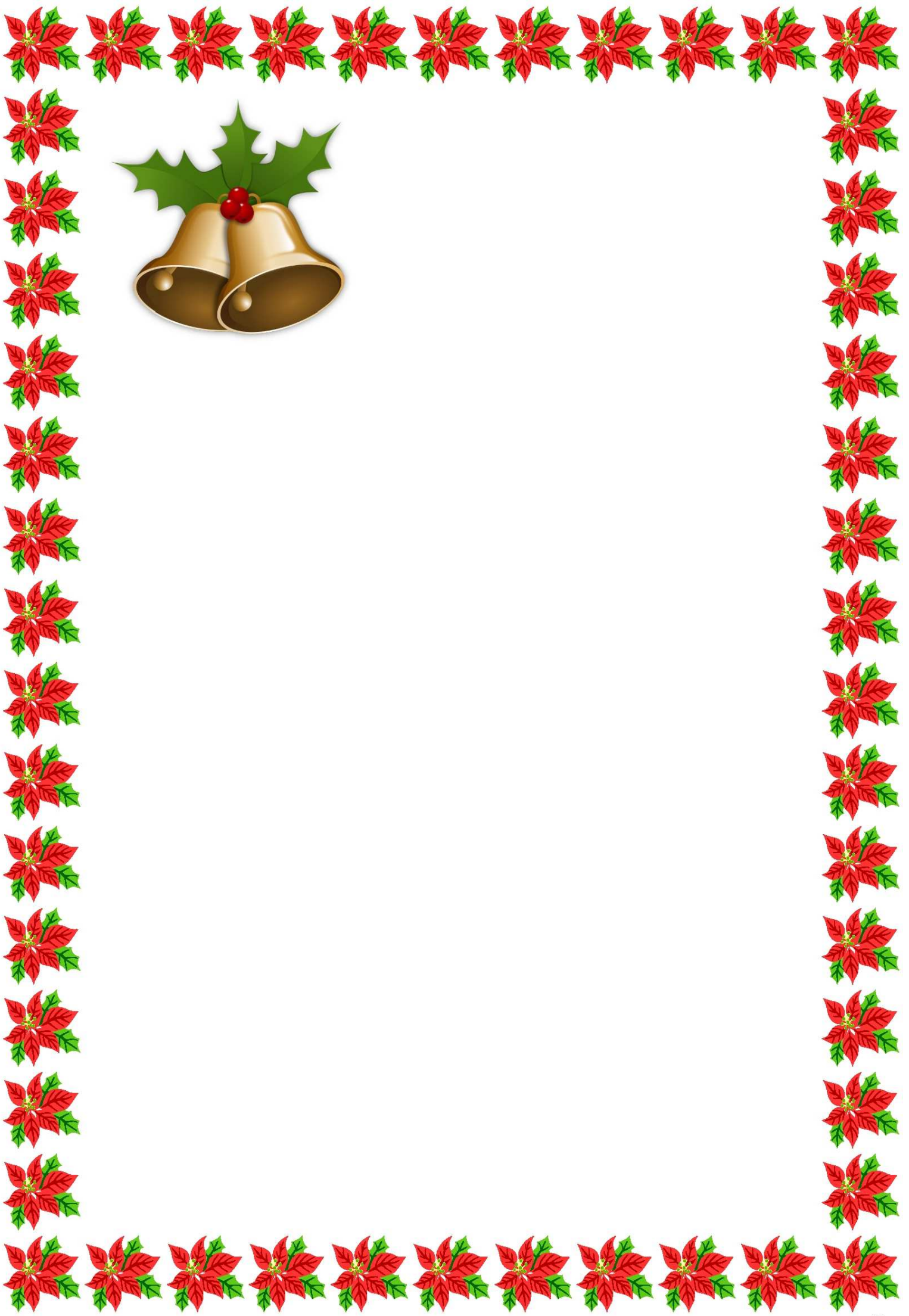

St Peter's Church, Bekesbourne

ADVENT SONGS OF PRAISE



10am Sunday December 3rd



FOR ALL AGES - EVERYONE WELCOME

COME AND JOIN IN YOUR FAVOURITE CAROLS

FOLLOWED BY TEA, COFFEE OR JUICE AND BISCUITS

And lots of chatting!





CHRISTIAN AID CHRISTMAS APPEAL 2017

This year Christian Aid's Christmas Appeal focuses on the fight against hunger and malnutrition in Burkino Faso and South Sudan. Hunger is not a simple problem; it's driven by issues such as climate change and conflict.

Aluel is the sole provider for her family. She runs a small business selling tea and bread at a market in South Sudan. But life has been a struggle. On a bad day her family would have just one meal consisting of wild leaves. Christian Aid has helped by providing food vouchers, enabling her to buy ingredients to cook nutritious meals for her children.

In Burkino Faso, Collette was forced to walk miles in 45°C heat, carrying her baby on her back, to search for gold in the country's gruelling mines. Christian Aid's market garden project gave her a plot of land and trained her to grow vegetables, providing the seeds and tools she needed. She said, "I no longer have to go to the mines and my children are not malnourished. The garden has changed my life".

Christian Aid wants everyone to have a story like Aluel and Collette. In a world of plenty, when we in this country can stock our larders and freezers to bursting point with luxury Christmas food, hunger like this should not exist.

If you would like to make a gift to Christian Aid this Christmas, the UK government's UKaid scheme will match every pound you give to the Appeal up to the 5 February 2018, meaning that even more people living in poverty can have their lives transformed.

You can donate direct to www.christianaid.org.uk or if you prefer, place your gift in an envelope and pass it to me and I will make sure it goes to the Christmas Appeal.

Many thanks Jean Barber (01227 831956)

Nailbourne Horticultural Society

We will be holding our annual **Social Evening** on **Tuesday 5 December** at 7.30 pm in Bridge Village Hall. On arrival, you will be welcomed with mulled wine and nibbles to get you in the mood for what, I promise, will be a "not to be taken too seriously" garden related **quiz**, done in tables, followed by a light festive finger buffet and, of course, a raffle. And there you have all the ingredients to start off your Christmas celebrations. We will be charging £5 per person for what promises to be a fun, sociable and uncomplicated evening.

Moving into the New Year, we have our **AGM** in Bridge Village Hall on **Tuesday 23 January** at our usual start time of 7.30 pm. This is the time when subscriptions are due for renewal (£6 for single and £10 for joint/family membership) and when the schedules for the Spring and Summer Shows will be available. As always, we are also on the look-out for new committee members. The committee generally only meets three times a year which is not too onerous and it would be greatly appreciated if you would consider joining us. Please speak to any of the committee members or make yourself known at the AGM itself.

After the business is completed, as a departure from our normal evening, there will be a session for members to share their **gardening tips, hints and humorous anecdotes**.

NAILBOURNE HORTICULTURAL SOCIETY

Light Hearted Quiz Evening



with mulled wine

followed by



a festive finger buffet



Tuesday 5 Dec

7.30 pm

Bridge Village Hall

Christmas Raffle

All welcome

Admission £5 (to include quiz & refreshments)

NAILBOURNE HORTICULTURAL SOCIETY



If you enjoy gardening then why not join the
Nailbourne Horticultural Society?

Come along to our

AGM

Tuesday 23 January

7.30 pm

Bridge Village Hall

followed by

Tips, Hints & Amusing Anecdotes

a chance to share your gardening experiences

Refreshments

Annual Subscriptions Payable

Bridge with Patrixbourne Women's Institute

Our December meeting will be held on the second Tuesday of the month, namely **Tuesday 12 December** (7.30 pm in Bridge Village Hall) when we will be celebrating the coming festive season with a **Members' Social Evening** with In-House Entertainment to be rounded off with a shared buffet supper.

The competition for the month is for an interesting white coloured item.

We then start our 2018 programme on **Tuesday 16 January** (usual time and place) with guest speaker and local resident **Peter Giles** who will be giving advice in a practical talk entitled "**Your Voice and How to Make the Most of It**". Please remember that the annual subscription (£41) is payable then and preferably by cheque. The competition for January is for an interesting item beginning with the letter "A".

It goes without saying that we are always delighted to welcome guests and visitors to all our meetings.

(The WI has its own noticeboard outside the village hall with details of all our events and contacts.)



Please join us

CAROL SINGING

Sunday 10th December 2017 2.30pm

Mulled wine & mince pies

*Please help us to raise money for MND
In memory of all those people who suffer or suffered from this disease*

Motor Neurone Disease is a progressive disease that attacks the motor neurones or nerves, in the brain and spinal cord. This means messages gradually stop reaching muscles and can affect speech and movement.

CHRISTMAS

at Chalkpit Farm Rural Shopping

www.chalkpitfarm.co.uk
Chalkpit Farm
Bekesbourne, Canterbury CT4 5EU



FRIENDS OF BEKESBOURNE CHURCH

JUMBLE SALE!

SATURDAY, 27th January, 2018

Doors open at 11am-1pm

Bekesbourne Village Hall
Bekesbourne

Admission 50p

Donations of jumble to the Hall on
Saturday, 27th January, 2017

Between

8am and 10.30am

Refreshments will be available

WE CANNOT ACCEPT ELECTRICAL ITEMS ~ THANK YOU

Villager David Latham will contact Cllr Fawke with dates and times for defibrillator training-the new defibrillator is now located on the wall of the Londis shop.

Police cars will be patrolling lorries parked on the Highland Court access road to the A2.Villagers can suggest roads which should be added to the secondary roads list for maintenance during cold weather by contacting Kent County Council Highways department.

Villager and school PTA chair, Rob Moon, thanked the council for permission to use the Recreation Ground for the recent fireworks event, which was judged by all councillors to have been a great success. Cllr Hodges recorded her thanks to the children of the school for planting bulbs.

Neighbourhood Plan: Following a discussion about the nature of the Cantley proposals, whether their current offer represented the best offer obtainable and protocols governing the composition of the Neighbourhood Plan, Council agreed by 6 votes to 2 (those voting against were Cllrs Dhillon and Ferguson) to endorse the recently published Cantley proposals in a forthcoming leaflet and to include a statement from the council in the same leaflet to be distributed to all households over the period 18/19 November. This leaflet will remind villagers of the vote to be held on November 25 in Bridge Village Hall.

Joint meeting with other invited local parish councils held on 19 October 2017 to discuss HICO (Highland Court) development plans. The Chair reported back on the meeting. Another joint meeting of the parish councils will take place on November 23 at 7.30 in Bridge Village Hall. Cllr Fawke has joined the Barham Downs Action Group.

The parish council **budget for 2018-2019** will be set on 14 December. A note of the parish precept request has been asked for by Canterbury City Council with a final deadline of 31 December 2017.

Cllr Dhillon provided feedback on 3 separate **speedwatch sessions** on 16 and 26 October and 2 November. More volunteers are needed. 2 vehicles had been recorded at speeds of over 60 mph. **The next meeting will be on Thursday, 14 December 2017 at 7.00 p.m.**

Bridge and Patricbourne Year 2 pupils

**Will be performing their Nativity Play in St Peter's Bridge on
Wednesday 13th and Thursday 14th December
at 9.30am**

All villagers welcome.

Refreshments will be served

Please come and support the children

Littlebourne & District Royal British Legion

With the Poppy Appeal having been a busy time once again, we would like to thank all those who have been helping the Branch with its collections.

Our recent Beef Pudding Supper Night raised £160 for the Poppy Appeal - thanks to Kevin at the Hay Wain and those who joined us to make it a really nice evening.

At time of sending this report we had not held our AGM so details of elected officers for the coming year could not be included. However, there will also be a list of these in our notice board outside Littlebourne War Memorial Hall.

Once again - if anyone is thinking of becoming a member of the Branch they will be very much welcomed. Contact either the President on 01304 812292 or the Secretary on 01227 472023 for more details.

Our Christmas Meeting will be on Tuesday, 12th December 2017 and the first of the New Year will be on Tuesday, 9th January 2018, both at 8pm at the Recreation Club, Littlebourne (entrance to the right behind the Hall).

“This Turbulent Priest” –

written by Jane Hardy and Michael Conaghan and performed by actors Robert McCrea and Paul Kavanagh is a play produced by Bad Husky Productions in partnership with The Board of Canterbury Cathedral and very fittingly is being staged in Eastbridge Hospital which was originally built to provide hospitality for pilgrims visiting the tomb of St Thomas Becket.

Historically accurate the play is a riveting dramatisation of the conflict between Becket and King Henry II resulting in Becket's brutal murder in Canterbury Cathedral and will appeal to both adults and children alike.

“This Turbulent Priest” – to be performed on Thursdays, Fridays and Saturdays at 1.30pm and 3pm from 25th November until 29th December (the anniversary of Thomas's death) in **Eastbridge Hospital**, High Street, Canterbury.

Tickets: Available on the door prior to each performance **Adults: £8 Concessions: £5** (OAP, students, under 16 and Canterbury Residents Card Holder) **CASH ONLY**

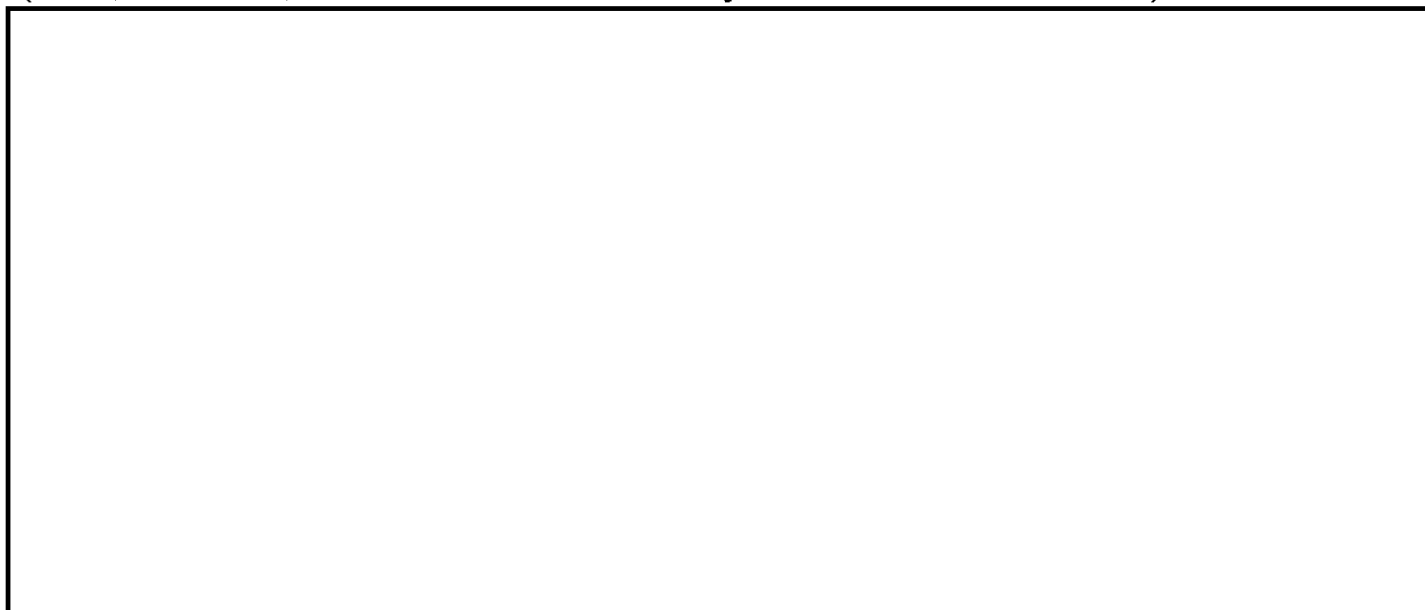

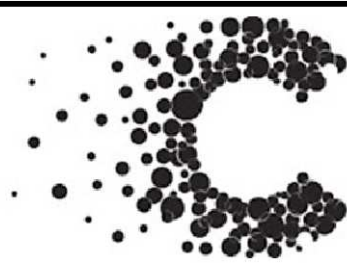

CANCER
RESEARCH
UK

Charity Coffee Morning
in aid of
Cancer Research UK

10 – 11:45am 3rd Feb 2018
Bridge Village Hall

Together we will beat cancer

St Peter's Church, Bekesbourne

SONGS OF PRAISE



10am Sunday 7th January



FOR ALL AGES - EVERYONE WELCOME

COME AND JOIN IN YOUR FAVOURITE HYMNS



FOLLOWED BY TEA, COFFEE OR JUICE AND BISCUITS

And lots of chatting!



Domestic Cleaning Services
 Tel: 01227 277033
www.supermaids.co.uk
 Email: info@supermaids.co.uk

Self-Catering Holiday Home
Bridge (Centre)

Sleeps 7-(5 + 2 on sofabed), 3 Bedrooms
 Available all year round.

Contact Tina:
 07890 613 185 or 0118 375 0393

YOGA CLASSES @ POLO FARM & LOWER HARDRES VILLAGE HALL
 with Cheryl Rivers
FIRST LESSON FREE

Monday 1.30-3.00pm - Lower Hardres
 Tuesday 1.00-2.30pm - Lower Hardres
 Wednesday 4.30-6.00pm - Lower Hardres
 Thursday 10.00-11.30am - Lower Hardres
 Please contact Cheryl Rivers on
 01227 457707
www.yogawithcheryl.org

Secretarial Services

Word processing, copy typing of letters, reports, quotes, minutes, CV's, dissertations etc.
 Desk top publishing - logos, leaflets, menus, newsletters, posters etc. - Laminating - Photocopying.
 Paperwork management, bills, expenses, invoices.
 On-line form filling, passport applications forms, television licence forms, DVLA/Car tax.
 PowerPoint presentations - Audio transcriptions.
 On-line research.
 Professionally trained with over 30 years' experience and locally based. Efficient service with a quick turnaround - anything considered.
 For more information on Secretary Bird Services please email: secretarybirdservices@outlook.com or call us on: 07590 671965

THE SECRETARY BIRD



HAVE YOU HAD YOUR CHIMNEY SWEPT?

Hollybranch Chimney Sweeping:
 Your Local Professional Chimney Sweep
 (Evening and Weekend Appointments Available)

CONTACT US TODAY: 07523 056 320 / 01227 701 054
Martyno@hotmail.co.uk
www.hollybranchchimneysweeping.co.uk

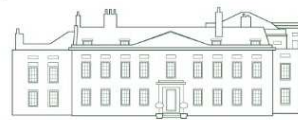

Charlton Park

KINGHAMFORD FOUNDATION LTD

Pilates, Yoga, Ballroom Dancing, Bridge, Nordic Walking, Singing, Work-Out, Piano, Squash, Tennis. Swimming, Croquet & Cricket (summer)
Details of Venue Hire, Events & Classes:
www.charlton-park.org
 01227 831355 info@charlton-park.org

Tressenden Designs

A Seamstress and costume maker with 8 years of experience.
Clothing Alterations.
Repair work undertaken.
Made to Measure; create a bespoke piece for those special occasions.
Modern and Vintage designs.
Costumes, ball gowns and Wedding dresses.
 For more information or a quote please contact Amy on:
 Mobile; 07853 202304
 Email; amy.louise.ford@hotmail.co.uk

NACS Registered
 HETAS Qualified
 Fully Insured
 Chimney Lining, Pots & Cows
 Fireplaces Fitted
 Stoves Installed & Serviced



P J Sweeps
 Phillip Joiner
 Chimney Engineer
 Over 10 Years' Experience

01227 700 909 pjsweeps@hotmail.co.uk

BEKESBOURNE STABLES

Liveries, hacking and lessons for all ages
and abilities

Pony rides and parties

Horses taken for schooling

Horses hired out for hunting

We are a fully licensed and insured
establishment

with many year of experience.

Situated in walking distance from
Bekesbourne Station, CT4 5EX

For info or to book call
01227 830910 or 07764776057

WE UNDERTAKE ALL ASPECTS OF
LANDSCAPE AND GARDEN MAINTENANCE

WORKS INCLUDE, BUT NOT LIMITED TO:

TREE SURGERY
MOWING
LANDSCAPING
HEDGE CUTTING
TURFING
FENCING
DECKING



T: 07850115270

www.meadowsgardenmaintenance.co.uk

E: ryan.meadowsgardenmaintenance.co.uk

[f/meadowsgardenmaintenance.co.uk](https://www.facebook.com/meadowsgardenmaintenance.co.uk)

Bed and Breakfast

in Bekesbourne's restored
Victorian school house

parking off road; 5 mins to
Bekesbourne station
private bathroom

01227

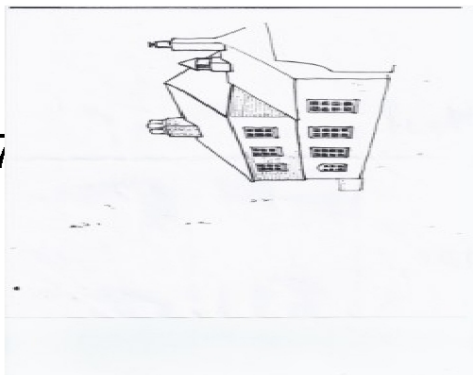

3571

G. Blackwell BUILDING CONTRACTOR

Extensions, Garages
Roofing
Restoration
Alterations etc.



Canterbury: 860480

TEL:01304 813372

THE CARPETMAN

MOB:07976 037683

David Brazier est, over 25 years

Local supplier and fitter of quality flooring

CHOOSE FROM A HUGE RANGE OF CARPETS,
VINYL AND OTHER FLOORING AT BELOW SHOP
PRICES IN THE COMFORT OF YOUR OWN HOME

WARE

ASH



**ASHTON
TREE CARE**

07929 627622 • 07769 908027
OLLIE@ASHTONTREECARE.CO.UK

City &
Guilds
NPTC

ALL WORK
FULLY INSURED

HEDGE CUTTING
STUMP GRINDING
TREE SURGERY



We specialise in bespoke, traditionally crafted oak
framed outbuildings, extensions & conservatories.

We also offer all general carpentry services.

Contact Mark or Helen for your FREE quote.

07977 304 968

honeyoakcarpentry@gmail.com

www.honeyoakcarpentry.co.uk



**BRITISH CACTUS AND SUCCULENT SOCIETY
HERNE BAY & DISTRICT BRANCH**

MEETINGS ARE HELD
EVERY THIRD WEDNESDAY OF THE MONTH FROM 7.30PM
at

THE OVER 60's CLUB, PETTMAN HOUSE,
HANOVER SQUARE, HERNE BAY. CT6 5NY

NEW MEMBERS ARE ALWAYS WELCOME

For further details please contact
Philip Andrews Tel: 01227 830960

Entertaining speakers
Variety of topics
Free refreshments
Friendly chat

AcklandWebb

Chartered Certified Accountants and business advisers

- Local family business
- Friendly & professional service
- Specialists in small to medium-sized businesses & start ups
- Full range of accountancy and tax services
- Testimonials & references available
- No cost/no obligation initial meeting

Contact: David Muggridge

Tel: 01227 811745

Email: enquiries@acklandwebb.co.uk

Web: www.acklandwebb.co.uk



LANDCARE



Tree Surgeons
Fencing
Landscapes
Maintenance

NPTC certificated
Fully insured
20 years established
Local references available

www.landcaretreesandfencing.co.uk

07740-949836

07770-899548

SAXON LODGE RESIDENTIAL HOME LTD **30 WESTERN AVENUE, BRIDGE, KENT CT4 5LT**

Family run home. established for over 20 years, recently extended to accommodate 23 residents with 12 ensuite rooms.

We cater for permanent, respite, holiday stays, rehabilitation and day care.

For further information contact Anita Easton (Manager) on
01227 831737 or info@saxonlodge.co.uk
KCC & CQC registered; KCC contracted
www.oasiscaregroup.co.uk

BARKING BEAUTIES KENT

The Old Stables, Highland Court Farm, Bridge, Canterbury, Kent CT4 5HW
Telephone: 01227 830166 Mobile: 07866 463660

Fully Qualified City & Guilds grooming in the following technique

Bathing, drying and nail clipping

Full breed standard clip to breed styles

De-matting

Hand stripping and de-shedding

Fully qualified City and Guilds Master Diploma and K9 First Aid qualified

Fully insured salon

Equipped for larger breeds as well as toy and small

Established groomers

Prices start from £15 for simple wash & blow dry. Find us on Facebook under Affinity Barking Beauties



CS SATELLITE TV SERVICE

CHRIS SHEATHER

5. WHITELOCKS CLOSE, KINGSTON,
Nr. CANTERBURY, KENT. CT46JG.

01227830179

SUPPLY. INSTALL. REPAIRS. DIY ADVICE



GreenStone
CHARTERED
SURVEYORS

07443 496025



If you are looking to buy a residential property in East Kent, we are independent Chartered Surveyors that specialise in:
RICS Building Surveys
RICS Homebuyer Report
Valuations

We provide a professional, friendly and approachable service with over twenty years experience.

greenstone.surveyors@hotmail.co.uk

Ty Bryn, Patricxbourne, CT4 5BT

www.greenstonesurveyors.co.uk



REVELATION OAK

— BUILDINGS —

Our experienced craftsmen build to your exact specification, a range of oak framed structures. From Houses to Log stores.

For more information visit us online or contact us at:

www.revelationoak.com Tel : 07513057656 revelationoak@gmail.com

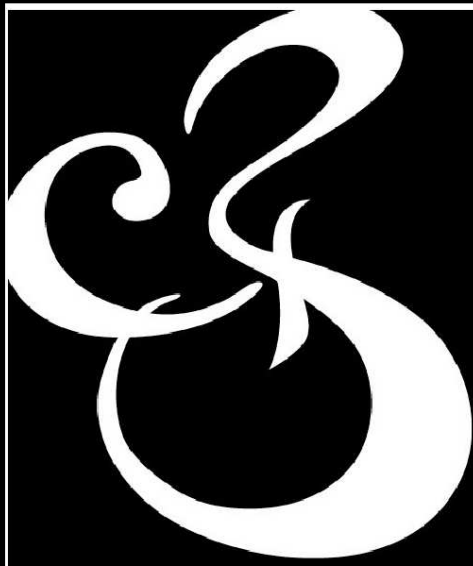

Charles Bainbridge

Estate Agents

National award winning service and marketing across sales, lettings and property management.



01227 780227

charlesbainbridge.com

WOODLANDS
hair . beauty . holistic therapies

Ladies & Gents Hairdressing

Hot Stone Massage Spray Tanning Jessica Manicure & Pedicures
Facials Pregnancy Massage Acupuncture Waxing

For more details please visit our website

We look forward to welcoming you to Woodlands very soon!

26a High Street, Bridge, Canterbury, Kent, CT4 5JZ

01227 830120 www.woodlands-bridge.co.uk



The CANTERBURY
AUCTION Galleries



FREE ANTIQUE VALUATION SERVICE

Every **Friday 10am to 1pm**. Home visits by appointment.

CANTERBURY **01227 763337**

40 STATION ROAD WEST, CANTERBURY, KENT CT2 8AN

www.thecanterburyauctiongalleries.com



Hart Lee

Tree Surgery & Stump Removal

Domestic & Commercial Contractors

- All Aspects of Tree Work
- Garden & Site Clearance
- Hedge Trimming
- Tree Planting

Call Tony

City & Guilds
NPTC
Qualified

Fully Insured

T:01227 761502

M:07708 537683

W:hartleetreesurgery.co.uk

S & W ASPHALT FLAT ROOFING SPECIALISTS

16 BROOKLANDS CLOSE
FORDWICH
CANTERBURY
KENT CT2 0BT

Tel: 01227 731576 office
Mobile: 0795 0299346

Bay Tree Accountancy
www.baytreeaccountancy.co.uk



ICAEW
CHARTERED
ACCOUNTANT

Annual Accounts
Tax Returns
Payroll
VAT Returns
Management Accounts

Sue Leitch –
Chartered Accountant – FCA MAAT

Tel: 01227 709741
Email: sue@baytreeaccountancy.co.uk

“Dad Will Fix It”

- **Lawn Mowing**
- **Tree & Hedge Trimming**
- **Strimming & Brush Cutting**
- **Overgrown Gardens**
- **Locks & Security**
- **General DIY Repairs**
- **Flat Pack Assembly**
- **Fences & Gates**



Mark BRADLEY
07767 480167

Email:
Dadwillfixit@hotmail.com

People of the Bridge Group of Churches

The Vicar:

Vacant

Reader:

Mrs

Margaret Clarke

01227-765598

mrsmaclarke@yahoo.co.uk

Authorised Lay

Minister:

Mrs

Beverly Latham

01227-830365

Administrator:

Sian Smith-Keary

bridgeoffice23@gmail.com

St Mary's Patrixbourne with St Peter's Bridge

Churchwardens:

Dr Andrea Nicholson

01227-830947

Mrs Pauline Pritchard

01227-830685

Mr Laurence Dunderdale

01227-830668

laurence.dunderdale@gmail.com

Mrs Evelyn Andrews

01227-830960

evepurlins@btinternet.com

PCC Secretary:

Mr Alan Barber

01227-831956

PCC Treasurer:

Mr Devin Brougham

01227-

709690

dwbrougham@aol.com

Gift Aid Officer:

Mrs Evelyn Andrews

01227-

830960

Christian Aid:

Mrs Jean Barber

#