

# On the Nail

A magazine for the villages  
along the Nailbourne

Bridge

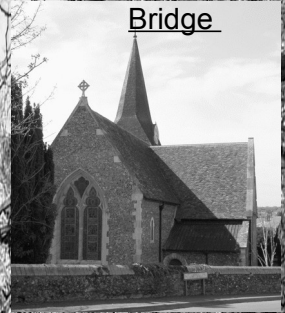

Patixbourne

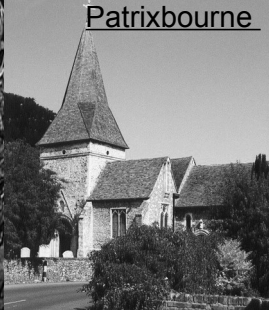

Bekesbourne

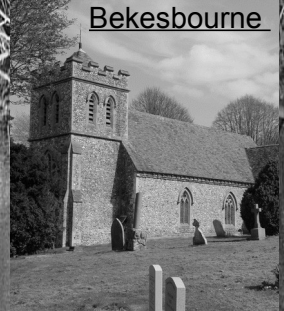

October 2018 50p

## BRIDGE HEALTH CENTRE

Permanent Clinical Hair Removal  
Many other skin blemishes treatable

01304 380249

Jacqueline Tall MBIAE CRPE (Fellow) DAE

## B&C Roofing

All your roofing needs

No job too small

Fully insured.

Local, friendly, reliable service

FREE QUOTATIONS

Call Ben 01227 363366

07949973176

<b>ALEXANDER</b> BUILDERS AND DECORATORS 100-102 THE BRIDGE VILLAGE CANTERBURY CT14 4JQ Tel: 01227 552442	
<b>SARAH DE ROUEMONT</b> RESIDENCIAL AND INTERIORS ALL COMMERCIAL CONTRACTS Tel: 01227 573322	<b>Plastering</b> John & Pauline • Domestic Plastering • Commercial Plastering • Gypsum Boarding & Exterior • Plastering • Plastering • Plastering Tel: 01227 552442
<b>JOHN SWAIN</b> 28 The Bridge, Bridge Village, Canterbury, Kent CT14 4JQ Tel: 01227 552442	
<b>Bridge Village Playgroup</b> Term 1: 10.00am - 12.00pm Term 2: 10.00am - 12.00pm Fully qualified staff and experienced staff Email: <a href="mailto:info@bridgevillageplaygroup.co.uk">info@bridgevillageplaygroup.co.uk</a>	
<b>C W LYONS &amp; SON LTD</b> FUNERAL DIRECTORS & MONUMENTAL MASONRY 24 Hour Service Tel: 01227 463506 Family Owned Est 1951 Proprietor: Christian Newman	

**PILATES WITH**   
**Control Pilates**  
Advanced Inst. **TRUSTED GROUP**  
Classes & 1:1 Private Lessons 6-7pm Mondays in Lydden Village Hall  
7.45-8.45pm Mondays in Bridge Village Hall  
1-2pm Thursdays in Bridge Village Hall  
Booking required £8 per class.  
Contact me on:  
07597949241 or  
[maxine@bodycontrol.uk](mailto:maxine@bodycontrol.uk)  
**PILATES®**

## MATHS TUITION

GCSE & iGCSE

Key Stage 2-4

Preparation for Kent Test  
& Entrance exams

12 years experience of tutoring

Enhanced DBS certificate

Patient, reliable and approachable

Using a wide range of resources I enable students to reach their potential.

Please contact: Clare Newman

01227 700291 for further details.

We clean your oven...

...so you don't  
have to!

**Oven  
Wizards™**  
We clean your oven...so you don't have to

Call David Bayliss on:

**01303 488237**

[www.ovenwizards.com](http://www.ovenwizards.com)



## NEED A VAN?

### THEN I'M YOUR MAN

For all light removals, furniture, and domestic items including house clearances.

Safely transporting antique furniture a speciality.

\* Avoid expensive pick-ups and drop-offs

\* Remove, dispose or recycle all household items including electrical appliances

\* Based in Barham

\* Reasonable and fair rates

\* Free estimates and quotations

**CALL CHRISTIAN ON:**

01227 831639

07771 728080

Email: [christianmanandvan@gmail.com](mailto:christianmanandvan@gmail.com)

## Bridge Village Playgroup

A traditional Playgroup in the heart of Bridge Village.

A caring, nurturing safe environment for your child to grow & gain independence.

Limited spaces available.

Mon & Tues 9.00am - 3.30pm

Wed, Thurs & Fri 9.00am - 12.00pm

Contact Mary / Jane 07790 096 325



Family owned and run  
 Convenient parking  
 Committed to quality care  
 Purpose designed modern practice  
 Relaxed atmosphere  
 24 hour emergency service  
 Consultations by appointment  
 Modern purpose designed facility  
 Rob and Rachel McMeeking  
 Chalkpit Farm, Adisham Road,  
 Bekesbourne, Nr. Canterbury Kent  
 CT4 5EU (Opposite Essentially  
 Hops)  
 e-mail : info@bournevets.co.uk  
 Web : www.bournevets.co.uk  
**01227 832322**

# Bettina Sings

Wedding, Celebration of  
 Life and Event Singer

*Classically trained  
 With over 30 years experience*

07801572538  
 bettinawalker66@icloud.com



Please contact for full repertoire & fees  
 All genres considered with given notice



www.facebook.com/bettinasings  
 www.bettinasings.com



## R.B.W



**KENT'S WATER FEATURE  
 SPECIALISTS AND  
 POND BUILDING EXPERTS**

Garden / Pond Design, Building and  
 Refurbishments  
 Pond Cleaning / Maintenance /  
 Maintenance Contracts  
 Child Safe Pond Covers  
 Filtration Specialists  
 Patios - Decking - Fencing -  
 Brickwork - Arbours

**Tel: 07563212858**  
**FREE ESTIMATES and**  
**CONSULTATIONS**

**We come to  
 you...**



**PC & Laptop Repairs. Data  
 Recovery  
 Networking &  
 Maintenance.  
 Repairs & New Systems .  
 Upgrades.**

**Virus Removal/Protection.**  
 info@gingercatcomputers.co.

uk  
 01227 700730 gercatcomputers  
 07970 455861 uk



www.gingercatcomputersolutions.co.uk

# YOUR LOCAL PRINTER

Over 25 years designing and printing  
in and for local East Kent communities

**design | web | print**



**HAYWARD**  
DESIGN & PRINT

3-4 Builders Square, Littlebourne, Canterbury, Kent CT3 1XU  
T. 01227 721 864 E. creative@hayward-design.co.uk W. hayward-design.co.uk

## Canterbury Roofing Specialist

Slate roofs  
Kent pegs New roofs Repair  
work Fibreglass flat roofs All  
building work carried out

Family run business  
www.rooferincanterbury.co.uk Contact  
Gary or Trevor for a free quote. Syvilla  
Canterbury Road Chilham, Canterbury  
Tel: 01227 731845 Mobile: 07796  
165289

## Majestic Garden Care



**01227 694123**

**07930 025683**

Professional garden care specialists with expertise in large gardens and private estates. Our experienced and dedicated team offer an exceptional service in caring for all aspects of your garden.

[www.majesticgardencare.co.uk](http://www.majesticgardencare.co.uk)

majesticgardencare@gmail.com

## Bridge Haven Care Home

avante<sup>®</sup>  
care & support  
*'Everyone Matters'*

**Conyngham Lane, Bridge, Canterbury CT4 5JX**

At Bridge Haven 24-hour care and support is provided for people living with dementia, where our team of qualified and attentive staff focus on the individual needs of the residents.

Visit our website to see how we can help you:  
[www.avantecare.org.uk](http://www.avantecare.org.uk) or call us on **01227 831607**



# COUNTRY FLORIST COUNTRY FLOWERS

## HOPS & FLOWERS

BY ESSENTIALLY HOPS



OPEN: MON-SAT 9AM-5PM  
SUN 10.30AM-4PM (EASTER -XMAS ONLY)  
TEL: 01227 830666  
EMAIL: SHOP@ESSENTIALLYHOPS.CO.UK

CHALKPIT FARM RURAL SHOPPING,  
BEKESBOURNE, NR CANTERBURY CT4 5EU  
WWW.HOPSANDFLOWERS.CO.UK



88 High Street, Bridge, CT4 5LB 01227 831999 bridge@colebrooksturrock.com

powered by Browns



88 High Street, Bridge, CT4 5LB

01227 831999

bridge@colebrooksturrock.com

The village and rural property experts with  
specialist knowledge of your area.

No obligation consultations on all  
aspects of sales and lettings.



# nicholas james hair limited

**Cutting and styling hair  
in a relaxed and friendly environment with easy  
free parking outside the door**

**BED HEAD**

**TIGI**

**tel: 01227 830565**

**PAUL MITCHELL**

**4 western ave, bridge, canterbury, kent, ct4 5ls.**



## THE CITY SWEEP CHIMNEY SWEEP

Brush and Vacuum

All Chimneys, Boilers & Stoves Swept  
Woodburning Stoves & Fireplaces Fitted  
Chimneys Lined, Certificates Issued  
HETAS & NACS registered, fully insured  
Member of the National Association of  
Chimney Sweeps

Tel: 01227 450888 Mob: 07813 716654

## MATURE LADY AVAILABLE FOR ALL DOMESTIC CHORES

Cleaning, Ironing,  
Shopping etc.

Also an experienced carer

PHONE LINDA: 01227 730499



## SARAH de ROUGEMONT

CRAFTSMAN CO-ORDINATOR  
UPHOLSTERY, FABRICS  
AND RENOVATION  
ALL COMMISSIONS CONSIDERED  
Tel: 07973 377817 or 01227 455841

To advertise in this magazine,  
please contact  
Mrs Jill Thomas  
[cobhamcourt@btinternet.com](mailto:cobhamcourt@btinternet.com)

## Paw Patrols

DOG WALKING,  
HOME BOARDING AND DAY CARE  
Hannah Terry  
Nearly 20 Years' Experience  
Fully Insured and Licenced  
Reference's Available on Request  
07855 832045

## Kent Roofing

Loft Conversions, Tiling  
Flat Roofing, Roofs Cut and Pitched  
UPVC Facia and Guttering  
Roof Windows Fitted  
FREE ESTIMATES  
Phone 01227 861149



Unit 11 Partridge Drive, Bridge  
CANTERBURY CT4 5BF  
(01227) 831928  
Servicing & MOT's Classes 4,5 lights  
& 7  
Welding  
Full Diesel & Petrol Diagnostic  
Cars collected and returned locally

Let's Get Moving Walk and Talking  
Counselling Sessions in  
Bishopsbourne. Come join me for a  
session - Contact Lyn Fitzgerald  
Mob— 07946 2632 37 Email—  
[lyn@reikibwell.com](mailto:lyn@reikibwell.com)  
[@bwell\\_postivechange](https://www.instagram.com/bwell_postivechange)

# D.M.B. Plastering

All aspects undertaken

*Interior. Exterior. Plastering.  
Rendering.*

*Coving. Ceiling. Walls. Floors.*

*Finest quality assured.  
CSCS Certified.*

Over 28 years experience.  
Free estimates. Reliable service.  
Fully insured.

Call David on **07818 607209**



## ELITE BLINDS AND SHUTTERS

Made to Measure Quality Window  
Blinds and Shutters  
For your home, conservatory, office,  
school, hotel and more...  
Call David or Katie on 01227 714716  
[info@elite-blinds.com](mailto:info@elite-blinds.com)

[www.elite-blinds.co.uk](http://www.elite-blinds.co.uk)



## K.P Decorating

K.P Decorating Services

- Exterior decorating
- Interior decorating
- Floor and wall tiling
- Laminate Flooring
- General house maintenance

For a free quote and to discuss  
exactly what you need give us a call  
on: 079564455720 or visit our website  
[www.kpdecoratingservices.com](http://www.kpdecoratingservices.com)



**TAP  
STREET  
MODERN  
BALLET  
MUSICAL  
THEATRE**

**Classes For Ages 3+ In Bridge &  
Barton Road, Canterbury**

**CALL NOW  
TO BOOK YOUR PLACE**

Email: [laura@dancextreme.co.uk](mailto:laura@dancextreme.co.uk)

Tel: 07817 966 547

[www.dancextreme.co.uk](http://www.dancextreme.co.uk)

[facebook.com/dancecanterbury](https://facebook.com/dancecanterbury)

C W LYONS & SON LTD FUNERAL DIRECTORS & MONUMENTAL MASONS 70 Military Road, Canterbury 24 Hour Service Tel: 01227 463508  
 Family Owned. Est 1911 Members of SAIF, NAFD & NAMM Prepaid Funeral Plans Available



### Dean Fielder Plumbing Services

07595 266 270 / 01304 841224

dean@deanfielderplumbing.co.uk / www.deanfielderplumbing.co.uk

**Friendly and Reliable - no job too small**

**All aspects of plumbing considered**

- Bathrooms, taps, showers, pumps
- Radiators and valves
- Kitchens, sinks, taps, dishwasher and washing machine installation
- Water Softeners, instantaneous water heaters
- Hot and cold water supplies and storage, immersion heaters
- Ball valves, stop cocks, waste pipes, drips, leaks
- Outdoor taps
- Heating controls/valves
- Kitchen and bathroom tiling

<p><b>ALEXANDER</b>                  24 HOUR SERVICE                  01227 463508</p>	
<p><b>SARAH DE ROUCEMONT</b>                  RENOVATION                  AND INTERIORS                  ALL WORKS CONSIDERED                  Tel: 01227 463508</p>	<p><b>Plastering</b>                  • Skimming                  • Rendering                  • Lining                  • Patching                  • Repairs                  • All Work Done to a High Standard                  Tel: 01227 463508</p>
<p><b>JOHN SWAIN</b>                  39 The Street, Canterbury CT1 6SS                  01227 463508</p>	
<p><b>WICKS Village Property</b>                  100 Wickes Road, Canterbury                  01227 463508</p>	
<p><b>C W LYONS &amp; SON LTD</b>                  FUNERAL DIRECTORS &amp; MONUMENTAL MASONS                  24 Hour Service Tel: 01227 463508                  Family Owned. Est 1911 Members of SAIF, NAFD &amp; NAMM</p>	

<p><b>G. Blackwell BUILDING CONTRACTOR</b>                  Extensions, Garages                  Flooring                  Restoration                  Alterations etc.                    Canterbury: 860480</p>	<p>Only vets and breeders care for your  <b>priority pets</b>                   For more information visit our website  <b>CLARKS LANDSCAPE SERVICES</b>                  Private and Commercial                  Gardening, Lawn Maintenance                  Tree Pruning, Fencing, etc.                  Canterbury: 01227 463508                  www.clarkslandscapeservices.co.uk</p>
<p><b>SWEETS STUFF</b>                  Fun Gifts for all occasions                  Wedding Gifts                  Why not have something different for your next                  These 'value for money' quality gifts of sweets                  01227 740044                  07816 436039                  www.sweetsstuff.co.uk</p>	<p><b>Trees &amp; Fencing</b>                  Tree Removal, Pruning, Fencing                  Canterbury: 01227 463508                  www.treesandfencing.co.uk</p>

"Logs for Sale"



## Living your life in the home that you love ...

*Are you finding things a bit more of a struggle but don't want to give up your independence?*

Live in care is a realistic, affordable alternative to residential care which lets you stay in control and continue to enjoy all your usual home comforts and social activities. Our care workers are fully trained and highly committed to meeting your needs in the way that you choose.



Canterbury & Thanet

To find out more why not contact our friendly and professional management team?

Tel: 01843 570638 or 01227 206473 Email: [canterbury@bluebirdcare.co.uk](mailto:canterbury@bluebirdcare.co.uk)

T 01227 832610 M 07534 288864

E [info@bournetogarden.com](mailto:info@bournetogarden.com)

**g** Bourne  
to  
Garden

Gardening services including:

- Fencing
- Landscaping
- Regular contracts
- Turfing
- Garden clearances
- Lawn treatment
- Seasoned logs
- Weed control
- Hedge cutting
- Mowing
- Tree surgery

Fully qualified and insured

[www.bournetogarden.com](http://www.bournetogarden.com)



Environment  
Agency



*for the largest choice call*

**BERRYS**

CANTERBURY LTD

*the Premier Letting Agents*

**01227 765268**

[www.berryscanterbury.co.uk](http://www.berryscanterbury.co.uk)

70 Castle Street Canterbury

1921

**90**  
years  
2011

<b>Oct 2018</b>	<b>St Mary NACKINGTON</b>	<b>St Mary LOWER HARDRES</b>	<b>St Peter BRIDGE</b>	<b>St Mary PATRIBOURNE</b>	<b>St Peter BEKESBOURNE</b>
<b>7 Oct 2018</b>	8:00am BCP Holy Communion  EL	11.00am Harvest Family Communion  EL	6.00pm Evensong  MC / EL	9.30am Harvest Sung Eucharist  EL	10.00am Harvest Songs of Praise  Lay led
<b>14 Oct 2018</b>	9.30am Morning Prayer with Hymns  DR & MC	6.00pm Evensong  MC	9.30am Family Communion  EL	<i>All welcome at other service in the Benefice</i>	8.00am BCP Holy Communion  EL
<b>21 Oct 2018</b>	<i>All welcome at the other services in the Benefice</i>	9.30am Family Service  MC	11.00am Choral Eucharist  EL	8:00am BCP Holy Communion  EL	9.30am Sung Eucharist  EL
<b>28 Oct 2018</b>	9.30am Sung Eucharist  RH	<i>All welcome at the other services of the Benefice</i>	8.00am BCP Holy Communion  RH  11.00am Community Worship  BL	9.30am Matins  MC	<i>All welcome at the other services of the Benefice</i>
<b>4 Nov 2018</b>  <b>All Saints</b> transferred from 01/11/18  <b>All Souls</b> transferred from 02/11/18	<i>All welcome at the other services of the Benefice</i>	<i>All welcome at the other services of the Benefice</i>	6.00pm All Souls Evensong  MC	<i>All welcome at the other services of the Benefice</i>	10.00am Benefice Service for All Saints Family Communion  EL



The Vicarage  
23 High Street  
Bridge  
Tel: 01227 206272  
E-mail: [estellalast@gmail.com](mailto:estellalast@gmail.com)  
October 2018

Dear Friends

It seems a long time since I last wrote to you as we have had the whole summer in between. I am sure like me, you are grateful in equal measure for the glorious sunshine we have enjoyed and the welcome rain that has brought everything back to green again. By the time you read this we will be in the full swing of celebrating Harvest in our parishes, giving thanks for all that God has provided for us and reflecting his generosity by giving gifts ourselves in support of worthwhile causes.

This week I have been thinking about courage especially in the context of having the courage to stand up for what we believe in as Jesus asks his disciples to do. Churches often find themselves overwhelmed by large numbers of people seeking an appropriate place to respond with their grief when tragedy strikes a community or nation and rightly so. It is the privilege of every church to be able to support and serve its community in this way. But what about the rest of the time? When life is good and we don't 'need' the support of the church? It costs an estimated average of £8,000 per month to keep our 5 churches open, insured, maintained, lit, and ministered to. Every penny of which comes from donations and fundraising. The supposed 'wealth' of 'The Church' is I'm afraid rarely something from which the local church can benefit.

So here I am banging on about money again! Yes sorry but this is about more than money – this is about courage. If we do believe that the church is the place to go to when someone is ill, dying or has died; if we do believe the church is still the place we want to mark our life events at (weddings, baptisms etc); if we do want to celebrate Christmas with a traditional carol service; if we do think that we are 'Christian' as 65% of people admitted to hospital said they were in a recent survey, then we need to stop hedging our bets, pluck up our courage, stick up for what we believe in (even if it is flawed and we don't have all the answers) – and yes, we need to put our money where our mouth is. Otherwise the church won't be here for future generations (well the buildings might remain as ancient monuments to a bygone era) but the heart of the church, it's role in our communities won't.

I'm afraid I am going to keep saying it until everyone gets the message – the church can't subsist on thin air any more than the rest of us can and whilst it might be an imperfect institution, run by imperfect individuals in an imperfect world it's what we've got and in some of our villages it is the last remaining community space since the pubs, shops and post offices succumbed to financial unviability.

The Church is here for you whether you are a person of strong faith or none, and even if you just don't know. The Church represents something far bigger than our cultural and interfaith/interdenominational squabbles over doctrine or inclusivity, but the church is in financial deficit in spite of the hard work of all our faithful volunteers – something has got to give – maybe you could?

As well as giving money – there are so many ways you could help your local church.

Volunteers do many things to help the life of the church and to keep costs down – everything from strimming the churchyards to arranging the flowers, singing in the choir to cleaning the pews - there are endless opportunities. Our services are open to everyone (even if you're not sure what you really believe) and are advertised on our web and Facebook pages as well as in this magazine. You are assured of a warm welcome and who knows you might meet some nice people and make some new friends.

Yours in Christ

Rev. Estella Last, Vicar

Dates for the diary – October 2018

**Tuesday 2<sup>nd</sup>**

- 9:30am - Holy Communion, St Peter Bridge
- 3:00pm – Holy Communion, Bridge Haven
- 7:30pm – After 8's, Mansfield Court

**Wednesday 3<sup>rd</sup>** – 7:00pm – Deanery Confirmation Service, St Peter Bridge

**Monday 8<sup>th</sup>** – 7:30pm - Caring & Sharing

**Tuesday 9<sup>th</sup>**

- 9:30am - Holy Communion, St Peter Bridge
- 2:30pm – Holy Communion, Mansfield Court

**Wednesday 10<sup>th</sup>**

- 10:00am - FISH pop-in coffee, Bridge Village Hall
- 2:00pm - Social Afternoon, Lower Hardres

**Tuesday 16<sup>th</sup>**

- 9:30am - Holy Communion, St Peter Bridge
- 3:00pm – Holy Communion, Saxon Lodge
- 7:30pm – After 8's, Mansfield Court

**Wednesday 17<sup>th</sup>** - 3:00pm - Hymns at Bridge Haven

**Monday 22<sup>nd</sup>** – 7:30pm - Caring & Sharing

Friends of St Peter's Church, Bridge

**COFFEE & CAKE & CONCERT**

20<sup>th</sup> October 10:30 to 11:30

**Allan Richardson**

Lyricist vocalist humourist guitarist

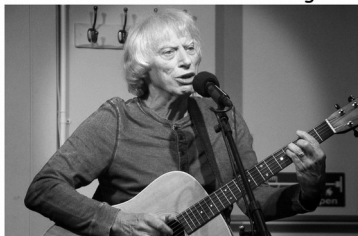

Established Kent Folk Singer Allan will perform a variety of modern songs and music in the English folk tradition to delight, amuse and join in (and since he's the Vicar's Dad she'll make an appearance too!)

**Suggested donation £3, children free**  
**All proceeds are for upkeep of the church**



**QUIZ NIGHT**

??

**Saturday 13<sup>th</sup> October**  
**7.00 – 9.30pm**  
**St Stephen's Church Hall**  
**Hales Drive**  
**Canterbury CT2 7AB**

**Come as a team of 4 or 8 or just on your own**  
**Bring your own refreshments**  
**Raffle**

**Tickets £6 from 01227 831956**

**All proceeds to Christian Aid**



*Tuesday Morning  
Communion and Coffee*

Looking for a bit of quiet time to reflect?  
Join us in Bridge at 9.30am every Tuesday morning for a short communion service (no hymns!) with time for prayer & a thought for the day. Stay for a coffee and chat or head off to start your day!

**Coming soon in 2019!!**

Family time

Fun together

Lego® Challenge

All ages together



Craft activities

Positive teaching

Prayer space

Enjoy a meal!

**Launching in January  
watch this space!**

**contact [estellalast@gmail.com](mailto:estellalast@gmail.com) to get involved**



## RIDE & STRIDE

A big thank you to all of this years Riders and Striders who have raised money for our Churches. We were lucky with the weather, and were thankful for the warm hospitality shown to us in many of the Churches visited. Many thanks to all of the sponsors who helped make this day so successful.

## LOWER HARDRES NEWS

### Reminder

On Sunday October 7th at 11.00am, there will be a Harvest Thanksgiving Service at St Mary's Lower Hardres. We will be collecting food e.g. tins and packets for Age Concern. There will be a competition for children, young people and adults - paintings, photography, drawings and vegetable animals, all connected to Harvest please. They can be brought to Church on the Saturday morning to be judged. Classes - age 8 years and under, age 9 - 18, and 18 onwards. Children can help to decorate the Church if they wish.

We would like to thank everyone who helped and contributed to the Harvest Lunch.

### Fish news.

40 years ago three remarkable women set up the Fish Scheme in Bridge, Patrixbourne, Bekesbourne and Bishopsbourne . They were Ann Young, Muriel Packer and Joan Warren. Joan, the last of them, died during the summer. Based on the idea of a GP and a vicar in Headington, Oxford, the Scheme set out to provide help to fellow villagers. Friends provided transport to the surgery and hospital, a weekly lunch club at the old Close, a housebound library service and a chiropodist clinic. Over the years it changed to provide increasingly for lifts to Ashford and Margate hospitals, the weekly Coffee Pop-ins and an annual outing. Until recently Ann Medhurst manned the Fish phone alone to liaise hundreds of lifts each year. Now about 25 drivers are asked to give lifts when they can. But the needs are as great as ever. If you could - or know someone who might - please consider becoming a driver. In her last years Joan and her husband used the Scheme themselves. She left us a truly wonderful legacy.

The next Coffee Pop-In will be on Wednesday October 10th from 10 to 11.15. And thanks to all who helped Rosy's Macmillan Coffee Morning to raise £188 for a great cause.

### Bridge and District History Society

The next meeting will be on Thursday October 18th at 7.30pm in Bridge Village Hall. Geoff Downer's talk is entitled "Something Different", giving various links to Kent including three 16th century Arctic expeditions, probably the biggest financial scandal of Elizabeth I's reign and pirates!

Members: £4.00, non-members £5.00 to include refreshments.

### Recreation Ground Working Party Saturday 17<sup>th</sup> November 2018

There will be a working party on the recreation ground on the above date from 9.00 am to 12.00 noon. Everyone is welcome including children so long as accompanied by a responsible adult. Please bring warm clothes and gardening gloves. Refreshments in the pavilion as usual.

I look forward to seeing you.

Sue Hodges

Headteacher: James Tibbles  
Tel: 01227 830276  
Email: [office@bridge.kent.sch.uk](mailto:office@bridge.kent.sch.uk)  
Web: [www.bridge.kent.sch.uk](http://www.bridge.kent.sch.uk)

Bridge & Patrixbourne C.E.P. School  
Conyngham Lane  
Bridge, Canterbury  
Kent  
CT4 5JX



Monday 10<sup>th</sup> September

It is with great pleasure that I introduce myself as the new Headteacher of Bridge & Patrixbourne School. At the time of writing this, I have only been at the school for a week, but already I am struck by the sense of community that exists and feel very privileged that I have the opportunity to be a part of this.

You would all be familiar with the phrase that 'it takes a village to raise a child' and I certainly hold true to this. As members of the community we all have a responsibility to ensure that the next generation coming through our schools are prepared for the challenges that they will face as they grow up. We achieve this by focusing not solely on their academic achievement but also by developing their values and their talents (whatever they may be).

I am very keen to develop the school's links with the wider community and, in particular, the benefice and look forward to the opportunities for the children that these links will bring. It is a fact that the vast majority of our pupils are not regular church-attendees; herein lies an opportunity to reach the children through different means and Rev. Estella and I have already discussed plans which we hope to detail further in the near future.

In the meantime I would like to express my gratitude for the warm welcome I have received from those members of the community with whom I have already met and thank you in anticipation for your support for the children of Bridge & Patrixbourne CEP School.

Please do feel free to get in touch via the school office if you feel that you could support the school or even have an opportunity for the school to engage in the local community.

Yours sincerely,

James Tibbles  
Headteacher



Wisdom ~ Trust ~ Forgiveness ~ Thankfulness ~ Friendship ~ Compassion

## WE WILL REMEMBER THEM- the lost soldiers of Patrixbourne

November 11<sup>th</sup> this year, marks the centenary of the ending of the First World War and the signing of the Armistice. The Remembrance Day Service will be held at St Peter's Bridge this year, but at 4pm there will be a more informal event to remember the six lost soldiers named on the War Memorial at St Mary's Patrixbourne.

The soldiers named are Capt. J. McB. Ronald, The Buffs; Lieut. 5<sup>th</sup> Marquis Conyngham, South Irish Horse; C.S.M., D. Alexander, The Buffs; Sapper F.S. Brickenden R.E; Pte. C.H. Stevens K.R.R.C.; Pte. A.E. Stevens 3<sup>rd</sup> Dragoon Guards. They will be represented in the church by six bench top Perspex silhouettes. The six figures have been awarded to us by the Armed Forces Covenant Fund Trust and are part of the 'There but not there' project, and their presence in the church will demonstrate what a gap the loss of six young lives left in the church, and the community, of the small village of Patrixbourne, at the time.

The event will be an opportunity to hear the stories of the soldiers, and to remember all those lost, in words and music. There will be hymns and songs such as 'Keep the home fires burning'. Everyone is invited to attend and if you know any descendants of the men named they will be particularly welcome. (It would be good to hear from them in advance- please contact me at [dr.andreanicholson@gmail.com](mailto:dr.andreanicholson@gmail.com)) Any former soldiers are particularly welcome as it is hoped that the event will help fulfil the project's aim of bringing community and veterans together. Tea and cake will be served afterwards.

The silhouettes themselves will be on display in the church on Saturday 10<sup>th</sup>, 10am-4pm., and on the Sunday too. Please come and see the silhouettes, as the display is part of a nationwide display of silhouettes.

'There but not there' is a 2018 Armistice project hoping to raise funds for the charity 'Remembered', which supports six charities (The Royal Foundation; Walking with the Wounded; Combat Stress; Help for Heroes; Project Equinox- Housing Veterans and Medical Students; Commonwealth War Graves Commission). A collection for 'Remembered' will be made over the weekend. Later that Sunday, at 7.05pm, the bells at Patrixbourne will be rung and will join bells across the country, marking the signing of the Armistice which saw the end of the First World War.  
Andrea Nicholson, Churchwarden, St Mary's Patrixbourne



St Mary's Church Patrixbourne

Sunday 11th November 4.00pm

*'WE WILL REMEMBER THEM-the lost  
soldiers of Patrixbourne'*

*Come and hear the stories of the six soldiers  
named on the War Memorial.*



First World War Songs, Hymns and  
poetry to commemorate the fallen.

'Silhouettes' will be  
seated in the congregation.

**Church open 10-4pm Saturday  
10th, and Sunday 11th to view the  
Silhouettes**

*Donations invited for  
'Remembered'*



**7.05pm ringing of the  
Church bells to mark the signing of  
the Armistice**



# St Peter's Church, Bekesbourne

## SONGS OF PRAISE

10am Sunday October 7th



**EVERYONE WELCOME – GIFTS TO THE WOMEN'S REFUGE**

**Please bring bedding – *single* duvets (new or cleaned), single duvet covers**

**& sheets and food - dried, tinned, packaged and fresh – thank you.**

**COME AND JOIN IN YOUR FAVOURITE HARVEST HYMNS**



***FOLLOWED BY TEA, COFFEE OR JUICE AND BISCUITS***

***And lots of chatting!***





# Baby and Toddler Group

Every Thursday during term time  
from Thursday 6th September.

9-11am

Bridge Recreation Ground Pavilion



Open to all pre-school age babies and toddlers (with parent / guardian). Come and enjoy a cuppa and a chat in a relaxed safe atmosphere while your children play with others. Sessions include free-play, drinks & snacks, craft activity.

Suggested donation £1 per child.

For more information contact [estallalast@gmail.com](mailto:estallalast@gmail.com)



With thanks to Bridge Parish Council



*You are warmly invited to*  
**Come and Sing Carols**  
*at St Peter's, Bridge*  
*on Sunday, December 16<sup>th</sup>*

and, more particularly, to join us in the **Bridge Choir**, which will be specially augmented as usual for the occasion of the Carol Service.

As in previous years, the choir will be supporting the congregational singing, and also adding another dimension to the familiar Christmas Readings with a varied, but not unfamiliar selection of short carols of their own. Having performed over 100 different choir carols since 2001, I have decided that it is time to repeat the set from that first year, most of which are definitely 'old favourites' but I hope not now hackneyed: *The Truth from Above* (English trad., arr. Vaughan Williams), *The Holly and the Ivy* (English trad., arr. Walford Davies), *In the Bleak Mid-Winter* (Darke), *Break Forth* (J S Bach), *The Infant King* (Basque trad., arr. Willcocks), *In Dulci Jubilo* (Pearsall).

We are looking for all voices (SATB) from all age groups, and hope to welcome back many old friends as well as gain a few new enthusiasts. Some experience and/or ability to read music is necessary for the harmony parts, but not vital for the top line. We will again keep rehearsals to a minimum, but for that reason it is crucial that most people can make *both* the main rehearsals as well as the Sunday! The rehearsals will almost certainly be held in Bridge Church as follows:

Thursday, December 13<sup>th</sup>  
7–8.30 p.m.  
Friday, December 14<sup>th</sup>  
6–7.30 p.m.  
Sunday, December 16<sup>th</sup>  
3.45–5.30 p.m.

Music will be available in advance and for private study!

If you are able to join us, please let me know as soon as possible on Canterbury 787994 or [mjm@kings-school.co.uk](mailto:mjm@kings-school.co.uk). I can then assess vocal balance and the viability of the programme!

With thanks & best wishes

Martin Miles

## Canterbury Food Bank

A huge thank you to everyone for the bags and bags of food and non-food that was given in at Harvest Festival for the Canterbury Food Bank. It was very much appreciated, particularly the most needed items of that moment in time which were cleaning materials, pet food, potatoes either dried or in cans and pasta sauces, plus all the other items all gratefully received.

As I have written before there are 3 main bags that are put together from donations received and collated at the Collection Centre in Chestfield. These contain enough food (all UHT, tins and packet items) to sustain an adult, a 2nd adult or a child over 2, for 3 days. With care these can last longer and indeed have to as only 5 vouchers are given out in a 12 month period. Anyone needing further assistance, which helps with their own problem, is then referred on to one of many agencies in the area.

What is not included in these bags are:

Cleaning materials, toilet rolls, sanitary wear, pet food, confectionery, baby milks and foods, baby hygiene materials, toiletries for both male and female, toothbrushes/paste, and items from exotic larder clear outs!

These are displayed on the Bonus Table which extends over 3 very long tables.

Having seen the representative from the Citizens Advice Bureau (unless a voucher has already been given by another agency) and signed in to receive the necessary number of food bags, the recipients are then invited to help themselves to whatever they require from the Bonus Table providing they can carry it home or have someone on hand to help them.

Being on the Bonus Table is my favourite of all roles I undertake at the Canterbury Food Bank. I get to hold the babies whilst their mothers look through and select what they need, to talk to the young and the old, the disabled and the homeless, and help them to select suitable things to take away. If you are camping out in a shop doorway or living in a car some items in the food bag are not of any use and these are sifted through and returned for more essential and suitable items.

Cleaning materials, sanitary wear and toiletries are vital to people without any money. It gives them self esteem on the outside whilst the food gives them nourishment on the in. A lot of homeless people and some families who come to us have pets – it is a major part of their lives and without money the pets go without too, adding to their owner's stress. Strange but true, we do need both types of items on a regular basis. If you are having a larder clearout please check the Sell by Dates on all food items. This is first done at the Collection Centre at Chestfield but our job is so much easier if it is received within a 3 month date. If the item is donated at a yellow bin at a supermarket then its SBD is guaranteed, but if it is donated elsewhere then it is checked carefully.

I always find it quite touching that people who come to the Distribution Café need to be persuaded to take anything in addition to the bags of food. They tend to say it should be left for someone else to take...

*'Food For Thought'*

### Bridge with Patribourne Women's Institute

The WI are holding a couple of events in Bridge Village Hall this month. On **Tuesday 16 October** at 7.30 pm our speaker is **D Godden**, an ex-cruise manager, who has promised us a humorous talk on **Travel**. The competition is for an interesting item beginning with the letter "J". Guests and visitors are most welcome to come to our meetings.

Then, on **Thursday 25 October** at 2 o'clock in the afternoon, we will be hosting the **Nailbourne Group Meeting**. The theme we have chosen is Hallowe'en, with the competition being the best decorated pumpkin and there will also be a chance to try out armchair yoga.

### Nailbourne Horticultural Society

Please note that there is a change of date for the October talk. **Roland Stevens** will now be giving his illustrated talk entitled "**The Greenhouse Story**" on **Tuesday 23 October** (not 9 October as published in the programme). The talk will be held as usual in the Village Hall, Bridge at 7.30 pm and, as with all our talks, everyone is welcome.

### National Vegetable Society - Kent Association

For the final evening talk of this year's programme, **Philip Johnson**, a professional gardener, will be giving a talk on "**Sweet Peas**" (7.30 for 8.00 pm start) in Bridge Village Hall on **Wednesday 10 October**. There is a sales table and raffle and non-members are always welcome to come along to enjoy the talk.

### Thank you / Goodbye

After such an emotional few days Mrs Pritchard and I are finally leaving Woodpeckers Nursery. Thank you to everyone for your kind wishes, cards, flowers and presents, we were overwhelmed.

You can imagine Woodpeckers has been an enormous part of my life for the past 21 years (28 years in all at Bridge /School), I would like to say thank you to my family for all their support.

It has been a team effort over the years and I couldn't have done it without all those lovely ladies who have worked so hard with me. Especially my right hand Mrs Pritchard, who has been with me from the beginning.

We would both like to say thank you to all the parents, families and friends who have given time, help and support over the years as Committee Members, at Fayres, painting faces, manning stalls and baking the yummiest cakes, especially Ninon Clark, Carla Long, The Dunderdales, Margaret Clarke, Margaret Hennessy, the staff at the school and so many more.

Most of all though I'll miss the main reason we are all here and that is the children, hundreds of whom have gone through Woodpeckers. I know I also speak for Mrs Pritchard when I say it's been a privilege to watch them all grow and blossom having so much fun and laughter on the way. Thank you.

It just leaves Teresa and I to wish Michelle and the team good luck for the very exciting times ahead of you.

If you go to Whitstable and see an old girl striding along or sketching on the slopes take a second look, it might be me so do come over and say hello.

Angie Sheppard and Teresa Pritchard

## FAIRTRADE

Among the many pictures and plaques on the walls of Bridge Church is a small framed certificate over the kitchen worktop. It says 'We are a **Fairtrade Church**'. 2018 marks 10 years since we achieved that status.

People started thinking about fair trade as a way of reducing poverty in the developing world back in the 1970s and the Fairtrade Foundation was set up in the UK in 1992. The principle is that trading companies pay fair prices for the goods they buy and sell, enabling the producers to earn a living wage. This includes a premium which is invested in the local community to improve living and working conditions, health, education etc. It also gives an opportunity to small producers in the developing world to engage in international trade.

In order to be able to put the Fairtrade mark on their products, companies have to provide evidence that they are fulfilling these commitments.

Faith groups are key supporters of Fairtrade and more than 7,500 churches from a range of denominations are now making the connection between trade and poverty by committing to using Fairtrade products when they gather together.

On our certificate at Bridge it says - We have committed to:

- use Fairtrade tea and coffee for all meetings for which we have responsibility,
- move forward on using other Fairtrade products, such as sugar, chocolate and biscuits,
- promote Fairtrade during Fairtrade Fortnight and through other activities where possible.

We all have the power to change the world every day. With simple shopping choices we can get farmers a better deal, so they can make their own decisions, control their future and lead the dignified life everyone deserves.

.....

*The annual Canterbury Fairtrade Fair is on Saturday 20th October between 10am and 3pm in St. Peter's Methodist Church Hall. There will be all kinds of Fairtrade foods and gifts to buy, as well as home-made soup and cheese lunches. Everyone welcome – do go along. Jean Barber*



# BARHAM POST OFFICE

As Bridge are sadly currently without a Post Office, we thought it may be useful to let you know the services on offer at Barham, just a short bus ride away or a few minutes drive with plenty of parking.

The following is a comprehensive list of services offered:

## Posting services

Posting letters/parcels standard first or second class post, with a signature on delivery (signed for) or via the trackable guaranteed service also with a signature on delivery (special delivery).

Posting letters/parcels abroad via standard airmail, surface mail or tracked/signed for services (services vary depending on destination country).

Posting larger/heavier UK parcels via Parcelforce.

Posting letters/parcels via "Drop & Go" suitable for frequent posters/companies.

Online shopping/catalogue returns

## Banking services

Paying cash and cheques into your personal/business bank account using your debit card or pre-printed paying in slip.

Withdrawing cash from your bank account using your debit card.

Checking your account balance.

Purchasing postal orders.

Transferring money within minutes to another person within the UK or abroad via "Moneygram".

Collecting money that has been sent to you via "Moneygram".

## Items we sell

Stamps, sold individually or in books.

One4All giftcards, which can be used in a range of high street stores as well as online.

Mobile phone top ups.

Fishing licences.

Health Lottery tickets £1 per line, draws Tues-Sun.

Phone cards.

## Bill Payment

Pay most utility bills using swipe cards/barcodes on the bottom of the bill.

Top up your Gas and Electric card/key via our paystation.

## Vehicle Tax/Licences

Pay your vehicle tax by cheque/card/direct debit.

Collect a driving licence form.

## Foreign Currency

Buy Euros from our stock held in branch.

Order foreign currency in branch by 2pm and collect the next working day after 1pm.

Top up travel moneycards.

## Other

Parcelforce collection – if you aren't in when Parcelforce try to deliver, your parcel will be taken to Barham Post Office for you to collect at your convenience.

Local Collect – when ordering online check if the retailer offers to deliver your parcel direct to Barham Post Office so you don't have to wait at home for your delivery, there is no fee from the Post Office for this service.

Charitable donations: if you wish to support a charity you may be able to make the donation to it via Barham Post Office. Please ask which charities are available as this varies from time to time.

We can be contacted at [barhamstorepo@gmail.com](mailto:barhamstorepo@gmail.com) or on 01227 832191, we look forward to seeing you.

NAILBOURNE HORTICULTURAL SOCIETY



# The Greenhouse Story

an illustrated talk by

**Roland Stevens**

**Tuesday 23 October**

**7.30 pm**

**Bridge Village Hall**

All welcome                      small charge to include refreshments  
Bring Along a Friend for Free!



**NAILBOURNE GROUP**

have pleasure in inviting you

to a

**TALK & SUPPER**

**“OMAN,  
golden land of forts and frankincense”**

**Talk by Dick Bolton**

**Wednesday 17 October 2018**

**7.30 pm**

**Bridge Village Hall**

**Finger Buffet & Glass of Wine**

**Tickets £10 per person**

**Raffle**

**For information and tickets 'phone**

**01227 830344 or 831820**



# Bridge Fireworks & Bonfire

Saturday 3rd Nov  
Gates open 5.30pm  
Bridge Recreation Ground

Access via Riverside Close and Patixbourne Road only  
NO ACCESS via Bridge School.  
For everyone's safety kindly NO SPARKLERS on site.



Supported by

Charles  
Bainbridge  
Estate Agents

## Tulip Tearooms & Majestic flowers

6, western Avenue, Bridge, Canterbury, Kent CT4 5LA  
01227 832555 / 07727 057 065

Hello,

I am Leigh-Anne, I am the proud owner of The New Tulip Tearooms & Majestic Flower shop that has opened in Bridge.

I am here to help with all things floral, with free local delivery & advice. I have recently been chosen as Broome Parks preferred florist. I hold a Saturday morning floral master class every week for all that want to learn the science behind excellent floral creations. These have already proved very popular, so booking is essential.

Open 7 days a week, the vintage style theme, Tearooms are here to offer a warm, friendly cosy place for you to meet friends, bring children for milkshake or come alone & snuggle in a corner with a book and a hot chocolate. We offer light lunches, delicious cream teas, fresh homemade cakes and a great range of Teas & Fresh Coffees served from teapots, side plates, bone china cups & saucers and even good old-fashioned sugar tongs & Tea cosies!

We have outside seating, highchairs, wheelchair access, a muddy boot store and a little side for dogs. we will serve you in a relaxed atmosphere with a warm smile.

Having lived in Bridge for 18 months, I noticed very quickly that this beautiful, vibrant village was crying out for a tearoom, somewhere for us all to meet and catch up on a regular basis. I have created the Tulip Tearooms for the good people of Bridge & surrounding villages to enjoy and look upon it as theirs. We have daily papers, books to read, a notice board, free Wi-Fi and usb charging stations. We offer buffets for small gatherings up to 20 people such as reunions, wakes and birthdays. Our after school "Milkshake" club has proven popular amongst the children. Come along and enjoy a milkshake straw for just £1.

We look forward to welcoming you here....

### Littlebourne & District Royal British Legion

Our raffle at the Elvis in the Garden on 9th Sept raised £327 for the Poppy Appeal.

Thank you to all who supported us and "Thank you Elvis"!

We still need more Poppy Appeal Collectors. Ring 01227 472023.

Our next two monthly meetings will be on Tues 9th Oct & 13th Nov (AGM), both at 8pm at the Recreation Club, Littlebourne.

On Remembrance Weekend (10th & 11th Nov) Littlebourne Church will have a programme of Flowers, Music & Words to commemorate the 100th Anniversary of the end of World War I. If anyone wishes to make a donation towards the flowers in

memory of a loved one who died in the War, please call Jean Smith on 01227 721830.

## New Season Dried Hops

Coming out of our kilns, this seasons dried hops are available to buy!

## Hop Plants - Pre-order now!

Order your new hop plant now for delivery mid-December. Choose from over 40 varieties!

## Autumn Dried Flowers

Warm harvest season arrangements and dried flowers in store and online.

## Make your own Christmas Wreath

Limited spaces still available for our 'Make Your Own Wreath' workshop. Call now to book.



Mon-Sat 9am-5pm  
Sun 10:30am-4pm (Easter-Xmas only)

Chalkpit Farm Rural Shopping,  
Bekesbourne, Nr Canterbury, CT4 5EU

[www.essentiallyhops.co.uk](http://www.essentiallyhops.co.uk)

Email: [shop@essentiallyhops.co.uk](mailto:shop@essentiallyhops.co.uk)

Tel: 01227 830 666



Est 1988

### Domestic Cleaning Services

Tel: 01227 277033

[www.supermaids.co.uk](http://www.supermaids.co.uk)

Email: [info@supermaids.co.uk](mailto:info@supermaids.co.uk)

### Self-Catering Holiday Home Bridge (Centre)

Sleeps 7-(5 + 2 on sofa bed), 3 Bedrooms  
Available all year round.

Contact Tina:  
07890 613 185 or 0118 375 0393

YOGA CLASSES AT LOWER  
HARDRES VILLAGE HALL with  
Cheryl Rivers Monday 1.30-3.00pm  
Tuesday 1.00-2.30pm  
Wednesday 4.30-6.00pm  
Thursday 10.00-11.30am FIRST  
LESSON FREE Please contact  
Cheryl Rivers on 01227 457707  
[www.yogawithcheryl.org](http://www.yogawithcheryl.org)

To advertise in this magazine,  
please contact Mrs Jill Thomas  
[cobhamcourt@btinternet.com](mailto:cobhamcourt@btinternet.com)

To advertise in this magazine,  
please contact Mrs Jill Thomas  
[cobhamcourt@btinternet.com](mailto:cobhamcourt@btinternet.com)



*Charlton Park*

KINGHAMFORD FOUNDATION LTD

Pilates, Yoga, Bridge, Nordic Walking, Singing,  
Work-Out, Piano, Squash, Tennis. Swimming,  
Croquet & Cricket (summer)

Details of Venue Hire, Events & Classes:

Bishopsbourne CT4 5JA

[www.charlton-park.org](http://www.charlton-park.org)

01227 831355 [info@charlton-park.org](mailto:info@charlton-park.org)

**To advertise in this magazine,  
please contact  
Mrs Jill Thomas  
[cobhamcourt@btinternet.com](mailto:cobhamcourt@btinternet.com)**

NACS Registered

Fully Insured

Chimney Lining

Pots & Cows

Fireplaces Fitted

CCTV Surveying

Rotary Power Sweeping

Stoves Installed & Serviced

01227 700 909 [pjsweeps@hotmail.co.uk](mailto:pjsweeps@hotmail.co.uk)

[WWW.PJCHIMNEYSWEEPS.CO.UK](http://WWW.PJCHIMNEYSWEEPS.CO.UK)

### P J Sweeps

Phillip Joiner

Chimney Engineer

Over 10 Years' Experience





BEKESBOURNE STABLES  
Liveries, hacking and lessons for all  
ages and abilities Pony rides and  
parties Horses taken for schooling  
Horses hired out for hunting We are  
a fully licensed and insured  
establishment with many year of  
experience. Situated in walking  
distance from Bekesbourne Station,  
CT4 5EX For info or to book call  
01227 830910 or 07764776057

W O S N

INCLUDE, BUT NOT LIMITED TO:  
TREE SURGERY MOWING  
LANDSCAPING HEDGE CUTTING  
TURFING FENCING DECKING T:  
07850115270  
www.meadowsgardenmaintenance  
.co.uk  
ryan.meadowsgarde  
.co.uk  
/meadowsgardenma  
k



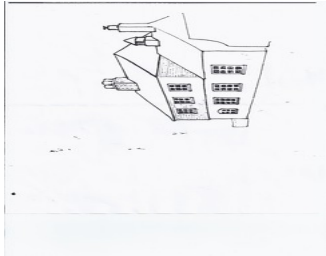

Bed and Breakfast in Bekesbourne's  
restored Victorian school house  
parking off road; 5 mins walk to  
Bekesbourne station private  
bathroom Contact: Gillian Wills  
gillianswills63@hotmail.com 01227  
830115 or 0754 787 8571

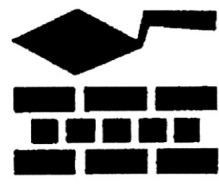

# G. Blackwell BUILDING CONTRACTOR

Extensions, Garages  
 Roofing  
 Restoration  
 Alterations etc.



**Canterbury: 860480**

TEL:01304 813372

THE CARPETMAN

MOB:07976 037683

David Brazier est, over 25 years

Local supplier and fitter of quality flooring

CHOOSE FROM A HUGE RANGE OF  
CARPETS, VINYLs AND OTHER  
FLOORING AT BELOW SHOP PRICES  
IN THE COMFORT OF YOUR OWN  
HOME

THE SCHOOL  
HOUSE  
WARE  
ASH



# ASHTON TREE CARE

07929 627622 • 07769 908027  
OLLIE@ASHTONTREECARE.CO.UK

City &  
Guilds  
NPTC

ALL WORK FULLY  
INSURED HEDGE  
CUTTING STUMP  
GRINDING TREE  
SURGERY



We specialise in bespoke, traditionally crafted oak framed outbuildings, extensions & conservatories.

We also offer all general carpentry services.

Contact Mark or Helen for your FREE quote.

07977 304 968

honeyoakcarpentry@gmail.com

www.honeyoakcarpentry.co.uk



Entertaining  
speakers Variety of  
topics Free  
refreshments  
Friendly chat

BRITISH CACTUS AND SUCCULENT SOCIETY  
HERNE BAY & DISTRICT BRANCH MEETINGS ARE  
HELD EVERY THIRD WEDNESDAY OF THE MONTH  
FROM 7.30PM at THE OVER 60's CLUB, PETTMAN  
HOUSE, HANOVER SQUARE, HERNE BAY, CT6 5NY  
NEW MEMBERS ARE ALWAYS WELCOME For further  
details please contact Philip Andrews Tel: 01227  
830960

# AcklandWebb

*Chartered Certified Accountants and business advisers*

- Local family business
- Friendly & professional service
- Specialists in small to medium-sized businesses & start ups
- Full range of accountancy and tax services
- Testimonials & references available
- No cost/no obligation initial meeting

Contact: David Muggridge

Tel: 01227 811745

Email: [enquiries@acklandwebb.co.uk](mailto:enquiries@acklandwebb.co.uk)

Web: [www.acklandwebb.co.uk](http://www.acklandwebb.co.uk)



# LANDCARE



**Tree Surgeons  
Fencing  
Landscapes  
Maintenance**

NPTC certificated  
Fully insured  
20 years established  
Local references available

[www.landcaretreesandfencing.co.uk](http://www.landcaretreesandfencing.co.uk)  
07740-949836      07770-899548

SAXON LODGE RESIDENTIAL HOME LTD 30 WESTERN AVENUE,  
BRIDGE, KENT CT4 5LT Family run home, established for over 20 years,  
recently extended to accommodate 23 residents with 12 ensuite rooms. We  
cater for permanent, respite, holiday stays, rehabilitation and day care. For  
further information contact Anita Easton (Manager) on 01227 831737  
or [info@saxonlodge.co.uk](mailto:info@saxonlodge.co.uk) KCC & CQC registered; KCC contracted  
[www.oasiscaregroup.co.uk](http://www.oasiscaregroup.co.uk)

BARKING BEAUTIES KENT Unit 11, Barham Business Park,  
Valley Road, Barham, Canterbury Kent CT4 6DQ Telephone: (01227) 463660



Fully Qualified City & Guilds grooming in the following techniques:  
Bathing, drying and nail clipping Full breed standard  
De-matting Hand stripping and de-shedding F  
Guilds Master Diploma and K9 First Aid qualified

Equipped for larger breeds as well as toy and small breeds  
groomers Prices start from £15 for simple wash & blow dry. Find us on  
Facebook under Affinity Barking Beauties



## ***CS SATELLITE TV SERVICE***

CHRIS SHEATHER

5. WHITELOCKS CLOSE, KINGSTON,  
Nr. CANTERBURY, KENT. CT46JG.

01227830179

*SUPPLY. INSTALL. REPAIRS. DIY ADVICE*



**GreenStone**  
CHARTERED  
SURVEYORS

07443 496025



If you are looking to buy a residential property in East Kent, we are independent Chartered Surveyors that specialise in: RICS Building Surveys RICS Homebuyer Report Valuations We provide a professional, friendly and approachable service with over twenty years experience.  
greenstone.surveyors@hotmail.co.uk Ty Bryn, Patrixbourne, CT4 5BT  
www.greenstonesurveyors.co.uk



# REVELATION OAK

— B U I L D I N G S —

Our experienced craftsmen build to your exact specification, a range of oak framed structures. From Houses to Log stores. For more information visit us online or contact us at: [www.revelationoak.com](http://www.revelationoak.com) Tel: 07513057656 [revelationoak@gmail.com](mailto:revelationoak@gmail.com)



Charles Bainbridge

Estate Agents

National award winning service and marketing across sales, lettings and property management.



01227 780227  
charlesbainbridge.com

**WOODLANDS**  
hair . beauty . holistic therapies

Ladies & Gents Hairdressing Hot Stone Massage Spray Tanning  
Jessica Manicure & Pedicures Facials Pregnancy Massage  
Acupuncture Waxing For more details please visit our website We look  
forward to welcoming you to Woodlands very soon! 26a High Street,  
Bridge, Canterbury, Kent, CT14 5JZ 01227 830120 [www.woodlands-bridge.co.uk](http://www.woodlands-bridge.co.uk)



*The* CANTERBURY  
AUCTION Galleries



**FREE ANTIQUE VALUATION SERVICE**

Every **Friday 10am to 1pm**. Home visits by appointment.

CANTERBURY **01227 763337**

40 STATION ROAD WEST, CANTERBURY, KENT CT2 8AN

[www.thecanterburyauctiongalleries.com](http://www.thecanterburyauctiongalleries.com)



# Hart Lee

Tree Surgery & Stump Removal

Domestic & Commercial Contractors

- All Aspects of Tree Work
- Garden & Site Clearance
- Hedge Trimming
- Tree Planting

*Call Tony*

City &  
Guilds  
NPTC  
Qualified

Fully  
Insured

**T:01227 761502**

**M:07708 537683**

**W:[hartleetreesurgery.co.uk](http://hartleetreesurgery.co.uk)**

To advertise in this magazine,  
please contact Mrs Jill Thomas  
[cobhamcourt@btinternet.com](mailto:cobhamcourt@btinternet.com)

T&T CONSULTING Big business  
thinking for small Businesses  
BOOKKEEPING ACCOUNTS  
Payable – Receivable PAYROLL  
CONSULTING INCLUDING  
Business Analysis \* Process Re-  
engineering Branding \* HR FIND

OUT MORE

[www.tandtconsulting.co.uk](http://www.tandtconsulting.co.uk)  
[info@tandtconsulting.co.uk](mailto:info@tandtconsulting.co.uk)  
07540723890 Bridge, Canterbury

To advertise in this magazine,  
please contact Mrs Jill Thomas  
[cobhamcourt@btinternet.com](mailto:cobhamcourt@btinternet.com)



# People of the Bridge Group of Churches

**The Vicar:**

Rev. Estella

Last

01227-206272

estellalast@gmail.com

**Reader:**

Mrs

Margaret Clarke

01227-765598

mrsmaclarke@yahoo.co.uk

**Authorised Lay**

**Minister:**

Mrs

Beverly Latham

01227-830365

**Administrator:**

Sian Smith-Keary

bridgeoffice23@gmail.com

**St Mary's Patrixbourne with St Peter's Bridge**

**Churchwardens:**

Dr Andrea Nicholson

01227-830947

Mrs Pauline Pritchard

01227-830685

Mr Laurence Dunderdale

01227-830668

laurence.dunderdale@gmail.com

Mrs Evelyn Andrews

01227-830960

evepurlins@btinternet.com

**PCC Secretary:**

Mr Alan Barber

01227-831956

**PCC Treasurer:**

Mr Devin Brougham

709690

01227-

dwbrougham@aol.com

#